

STRUCTURAL WATERPROOFING GUIDE

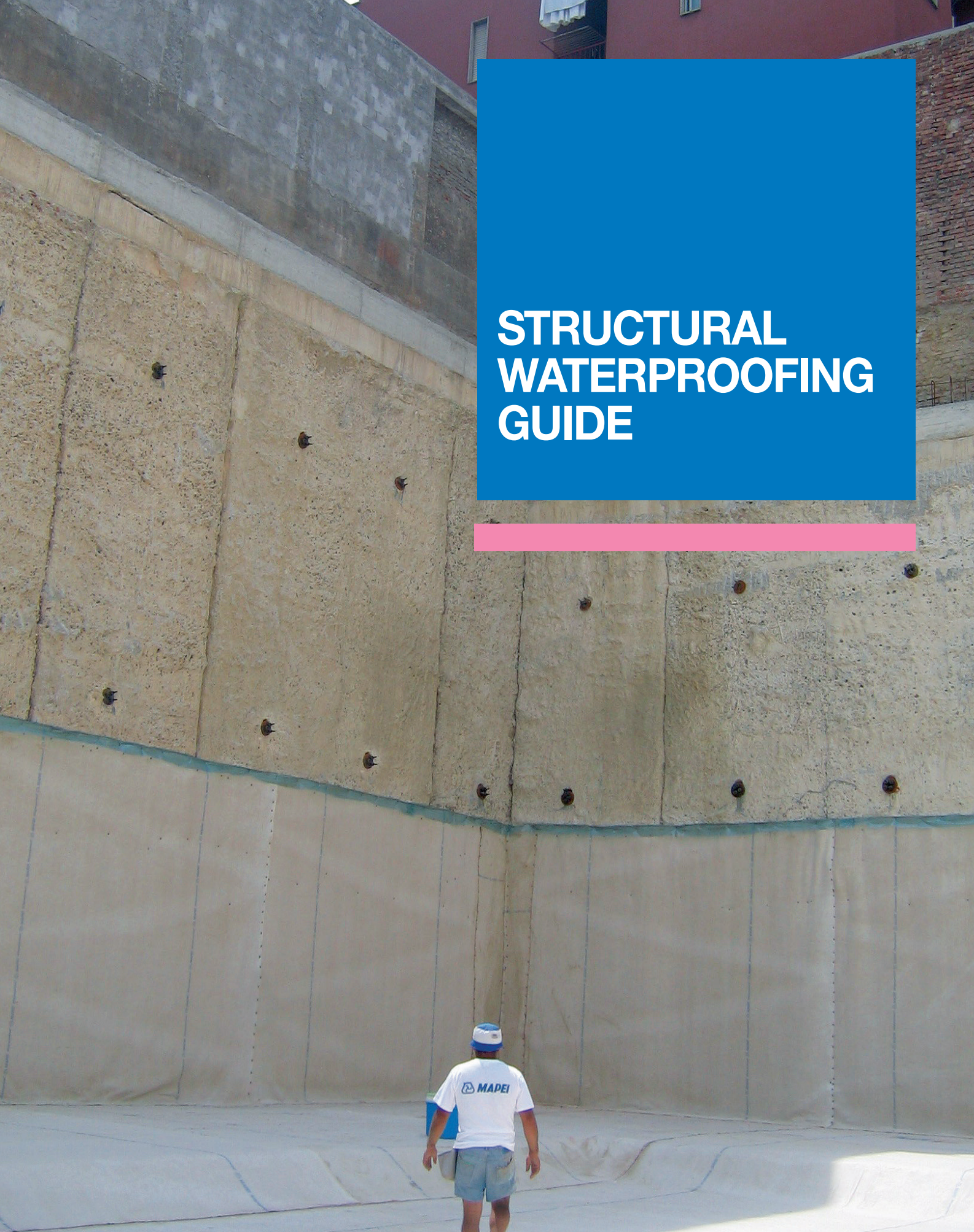

CONTENTS

MAPEI PRODUCTS

ALL ABOUT MAPEI

The World of Mapei	3
Mapei UK	5
Product Lines	6
Global Stats	7
Certification	9
Green Credentials	10

QUICK PRODUCT GUIDE 11

PRODUCT SELECTOR 15

BELOW GROUND SYSTEMS 17

BS 8102 Summary	19
Mapeproof FBT	21
Complete System	23
Mapeproof FBT	24
Mapeproof HW	24
Mapeproof Swell	24
Mapeproof Mastic	25
Idrostop Soft	25
Mapeproof Seal	25
Mapeplan Metalbar	26
Mapeproof CD	26
Mapelastic Foundation	28
Primer 3296	28
Polyfond Kit Drain	28
Plastimul Primer	29
Plastimul	29
Plastimul 2K Plus	29
Mapethene Primer	30
Mapethene LT	30
Mapethene EQ	30
Idrostop 10 & 15	32
Idrostop Mastic	32

BALCONIES 33

The Complete System	35
Mapelastic Turbo	36
Mapetex Sel	36
Mapeband	36

SHOWER AND WETROOMS 37

The Complete System	39
Mapelastic AquaDefense	40
Mapetex 50	40
Mapeband Easy	40
Mapeguard WP 200	42
Mapeguard IC/EC	42
Mapeguard ST	42

SWIMMING POOLS 43

The Complete System	45
Mapelastic Smart	46
Mapenet 150	46
Mapeband	46

RESERVOIRS 47

Planiseal 88	50
Purtop 1000	50

CAR PARKS 51

Purtop 400 M	54
Purtop 1000	54
Purtop Primer FT	54

SERVICES 55

Warranties	55
Training	55
CPD'S/DEMO'S/TALKS	55
Our Teams & Services	55

TECHNICAL BOOKS 56





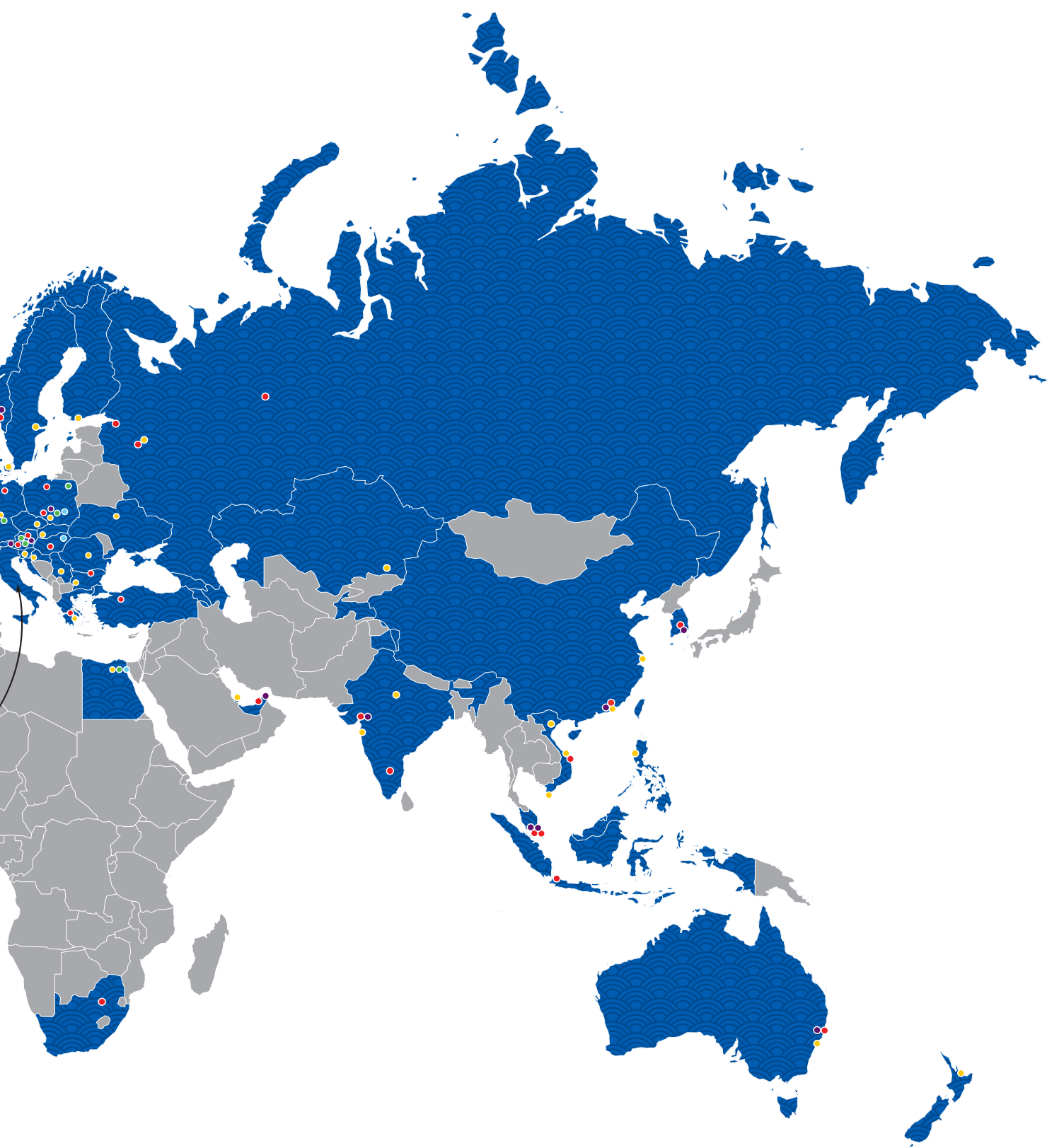

Waterproofing Structures Installed Below Ground Level	56
Waterproofing Baths and Swimming Pools	56
Technical Notebook for Waterproofing	56
Technical Notebook for Waterproofing Terraces and Balconies	56

USEFUL INFORMATION	57
How Mapei Can Help You	57
Place An Order	58
Technical Questions	58
Office Opening times	58
Contact Numbers	58

THE WORLD OF MAPEI





-  Mapei Headquarters
-  Mapei main offices with factories
-  R&D centres
-  Commercial branch offices of other companies
-  Main offices with factories of other companies
-  Mapei commercial branch offices

MAPEI UK

Manufacturing facilities at Halesowen are capable of producing 103,000 tonnes of product annually. Over 150 product SKU's are manufactured in the UK at the 24 hour operational site, employing over 245 members of staff to provide support and assistance to an ever increasing customer base of more than 700.

In addition to an expanding manufacturing plant and offices in the West Midlands, Mapei UK has a dedicated nationwide network of Specification Managers who offer a full NBS specification service with products listed in the BIM library. The Specification Managers work closely with the Technical Services Department to ensure seamless advice throughout each project from initial specification stage, to installation and post-completion.

As part of the learning and product education events Mapei hosts, a fully equipped training facility is located in the West Midlands which offers both general product range training and more in-depth seminars to demonstrate Mapei's system solutions for a range of construction queries.

Mapei UK is on hand every step of the way to assist with your project, making the conventional, exceptional.

HEAD OFFICE

Mapei House
Steel Park Road, Halesowen
West Midlands. B62 8HD

Halesowen,
West Midlands. B62 8HD

DISTRIBUTION CENTRE



Mapei World London City
6 Great Sutton Street
Clerkenwell, London, EC1V 0BX

Mapei Academy
Steel Park Road, Halesowen
West Midlands. B62 8HD



PRO DU CT LIN ES

CERAMICS&STONE

RESILIENT&TEXTILE MATERIALS

WOODEN FLOORING

CEMENTITIOUS&RESIN FLOORING

ACOUSTIC INSULATION

STRUCTURAL STRENGTHENING

BUILDING

REPAIR&MASONRY

THERMAL INSULATION

CONCRETE

PROTECTIVE&DECORATIVE COATINGS

WATERPROOFING

UNDERGROUND TECHNOLOGY TEAM
(UTT)

SEALANTS&ADHESIVES

MARINE INDUSTRY

Day in day out, construction sites all around the world can count on Mapei.



Professionals
from the sector
involved in
Mapei training
courses

more than

161,000



New
formulates
every year

more than

1,000



83

Plants in 5 continents,
in 36 different countries



more than

50,000

Tons of CO₂ offset



more than

66,000

Clients
around
the world



Tons of CO₂ saved
thanks to Mapei
additives for cement grinding

3,000,000

80+ years with the constant aim of supplying solutions of excellence. Mapei's leadership is based on their unrivalled know-how - over 80 years of successful construction projects and of renovation and conservation of important works from the world's artistic and cultural heritage.

Our story has a close bond with Italy, the country that witnessed our birth and growth. We started there, using our desire to create and innovate, reaching out to new countries and new markets.

Mapei has been operating worldwide for many years, and wherever we go we implement our company philosophy: specialisation, global internationalisation, R&D of technologically-advanced products, tailor-made service and support for our clientele, concern for the health and safety of all those who use and apply our products and appreciation and development of all those people that are a part of the world of Mapei.

more than

25,000

Tons of products
shipped every day



31

Main research
centres in 20 countries



more than

10,000

Employees, with 12% working in R&D

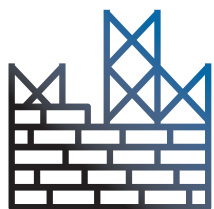

more than

5,000

Products for the building industry of the Mapei Group

89

Subsidiaries



2.5

Billion Euros
consolidated
turnover
in 2018

CERTIFICATION

Mapei systems are certified by recognised external institutes and laboratories.



Selected Mapei products have been awarded CE marking in compliance with Euronorm EN 14891 and/or EN 1504-2 and/or EN 1504-9.



Mapei membrains or mortars for the purpose of waterproofing structures conform to Euronorms EN 14891 and/or EN 1504-2 and/or EN 1504-9.



This symbol is used to identify Mapei products which give off a low level of volatile organic compounds (VOC) as certified by GEV (Gemeinschaft Emissionskontrollierte Verlegewerkstoffe, Klebstoffe und Bauprodukte e.V.), an international organisation for controlling the level of emissions from products used for floors.



The sanitaire logo is obligatory in France, and must be applied on all construction products for internal use. It is similar to the energy efficiency label applied on household appliances, and indicates the class of the product (A+ is the highest and C is the lowest) regarding the emission of volatile organic compounds (VOC) to safeguard the quality of indoor air and, as a result, the health of final users.



Mapei was awarded Certiquality certification in 2016 for their EPD (Environmental Product Declaration) issuing process. An EPD describes the environmental impact of a product throughout its entire life cycle by measuring its impact using standardised LCA (Life Cycle Assessment) methods.



LEED is a voluntary system for the design, construction and management of high-performance, sustainable buildings. The LEED certification system indicates the requirements for constructing environmentally sustainable buildings in terms of energy and the consumption of natural resources involved in the construction process. The LEED protocol was created in the USA, and is currently applied in more than 100 countries.



An independent, third party non-profit distributing organisation, our ambition is to provide reassurance to the construction industry that manufacturers' products, systems and procedures are 'fit for purpose'. Accredited by the United Kingdom Accreditation Service (UKAS), our testing is carried out in accordance with ISO/IEC 17025.

Mapei constantly promotes sustainability by joining international programmes and organisations and developing technologically-advanced products and solutions which contribute to safeguarding the environment and our health.



Mapei products help designers and contractors create innovative projects certified LEED "The Leadership in Energy and Environmental Design", in compliance with the U.S. Green Building Council.



Mapei's Low Dust technology allows dust emissions during the mixing, working and application phases of powdered products to be reduced by 90%, with advantages for the environment and the health of floor layers.



Mapei's FastTrack Ready technology includes products that reduce the number of steps required to complete an installation, products that complete a job faster than traditional installation products.



Lightweight adhesives characterised by their low density and higher yield compared with traditional adhesives.

Building a sustainable future together



Global environmental management
Mapei is a member of the chemical industry's global Responsible Care programme.



Bioblock® Technology
Innovative technology preventing mould formation.



Low Dust Technology
Significant reduction of dust released into the environment during manufacturing and use.



Ultralite Technology™
Lightweight adhesives offering higher yield, less effort and lower environmental impact due to transport.



Construction of green buildings
Mapei's most recent production facilities are designed and built according to LEED certification criteria.



R&D focused on indoor air Quality
Products and systems with very low volatile organic compounds emissions.

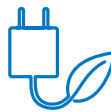

Energy saving strategy
Rationalisation of energy consumption and solutions for energy-saving buildings.



Green education strategies
Targeted training courses for professionals for the correct use of Mapei eco-sustainable materials.



Evaluation of the life-cycle of products
Dedicated team specialized in evaluating the environmental impact of the whole life cycle of our products.



A history of commitment
Certified products for the building industry respectful for the well being of the environment and the final user.



"Reduce, reuse, recycle" strategies
Reduction of solid waste and wastewater and use of recycled materials.



Products safeguarding the environment
70% of our Research is devoted to the development of eco-sustainable products.



Supporting green programmes worldwide
Mapei products give an important contribution to all protocols for eco-sustainable buildings all around the world.



Logistic and shipping strategies
Reduction in the consumption of fuel and pollutants by promoting the use of rail transport instead of road transport.

GREEN CREDENTIALS

QUICK GUIDE

A quick guide for choosing Mapei
waterproofing products.

QUICK GUIDE

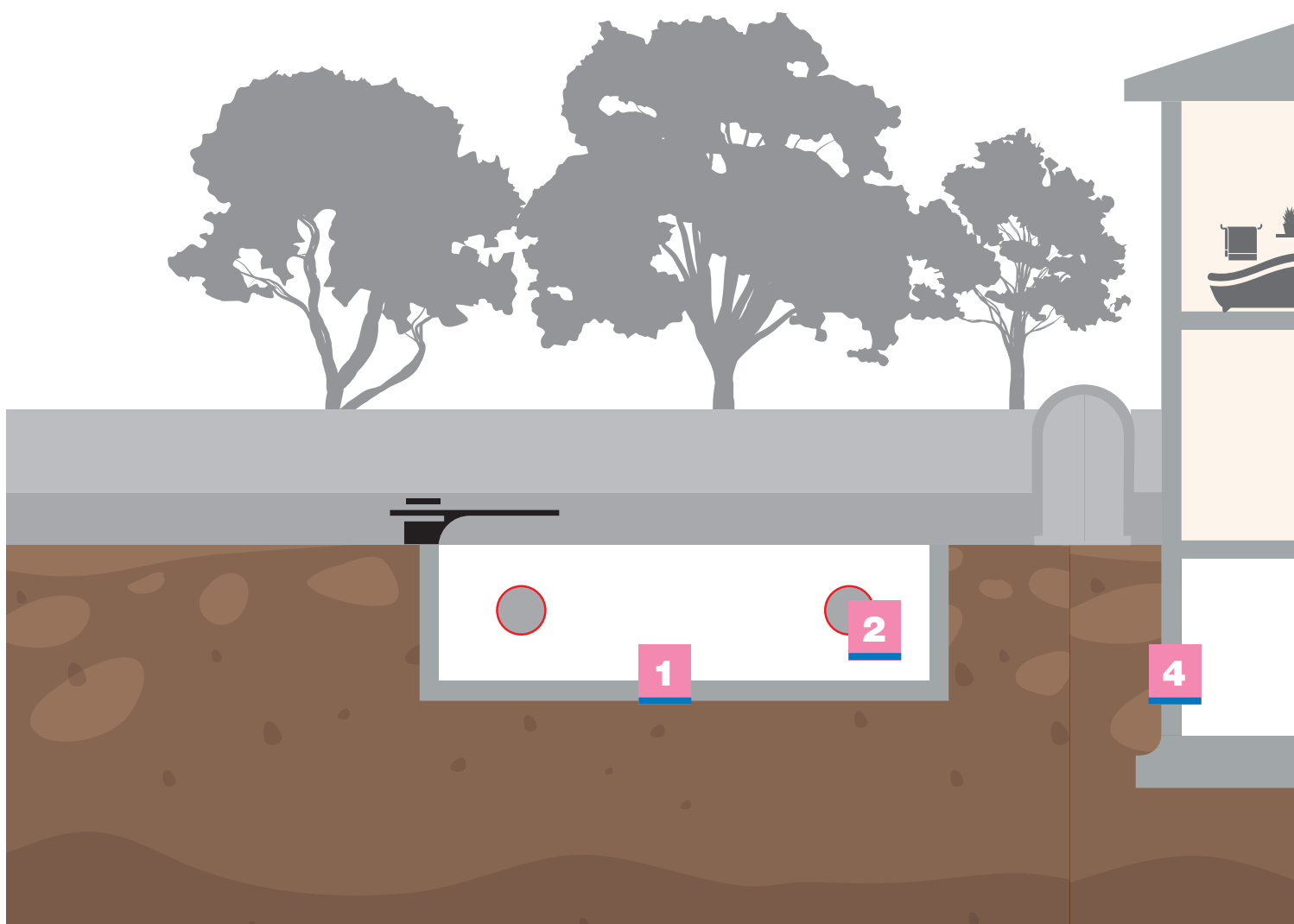

1

STORAGE TANKS

- Planiseal 88

2

SWIMMING POOLS

- Mapelastic Smart • Idrostop • Mapenet 150 • Mapeband
- Mapeproof Swell

3

LIFT PITS

- Mapelastic Foundation • Mapeproof HW • Planiseal 88
- Mapeproof FBT • Idrostop • Mapethene LT • Mapethene EQ

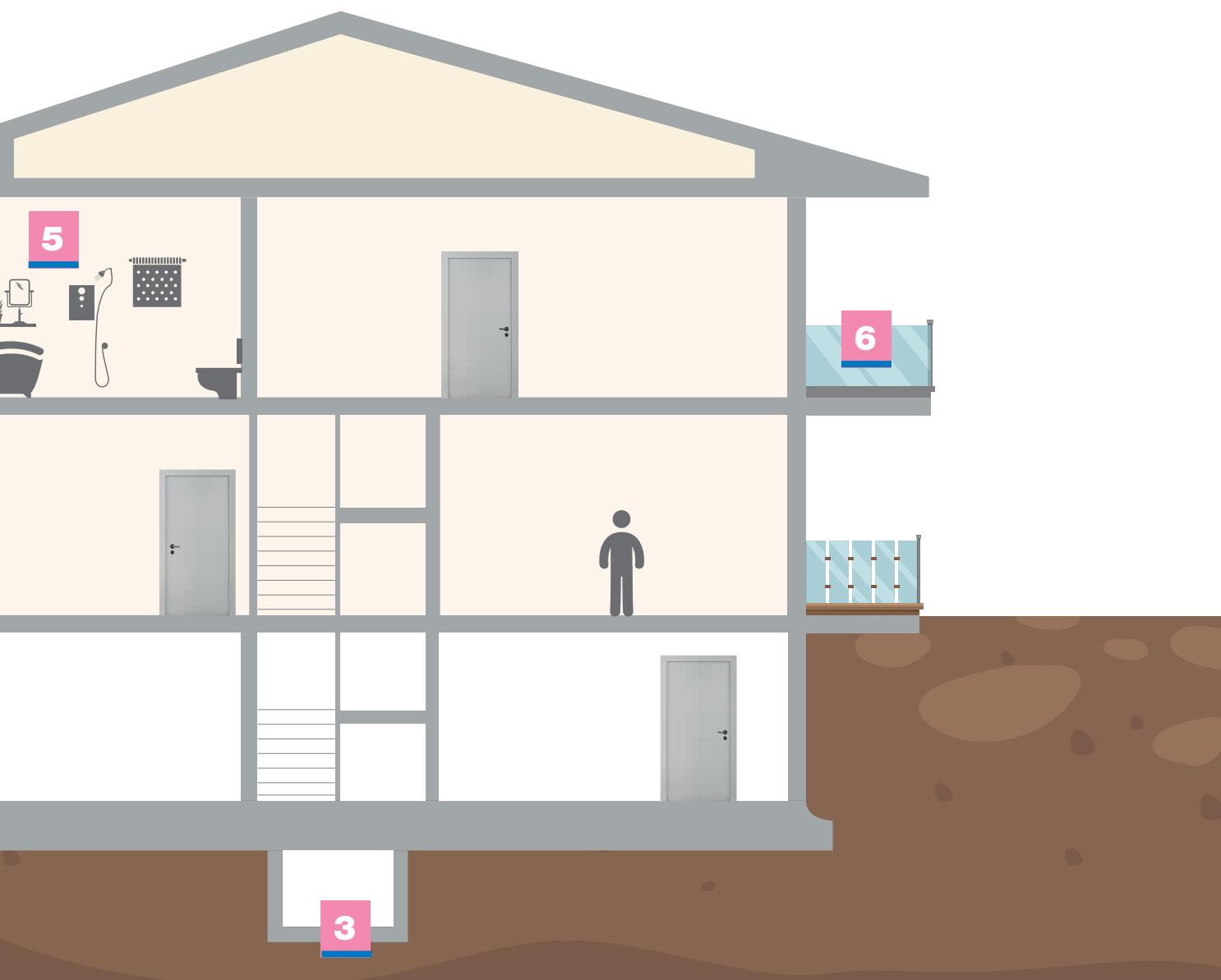

4 BASEMENTS

- Mapelastic Foundation • Planiseal 88 • Mapeproof HW
- Mapethene LT • Mapeproof FBT • Idrostop • Mapethene EQ

5 WET ROOMS

- Mapeguard WP System • Mapelastic AquaDefense
- Mapelastic AD Tanking Kit

6 BALCONIES

- Mapelastic Turbo • Mapetex Sel • Mapeband • Mapeband TPE

BATHROOMS, DAMP ENVIRONMENTS, SWIMMING POOLS, BALCONIES AND TERRACES

SELECTION CHART

	Horizontal and vertical surfaces	Fillets	Joints	Drains
BATHROOM & DAMP ENVIRONMENT				
Mapelastic Smart	•			
Mapelastic AquaDefense	•			
Mapeguard WP System	•			
Mapegum WPS	•			
Mapeband		•	•	
Mapeband SA		•		
Mapeband PE 120		•	•	
Drain Lateral				•
Drain Vertical				•
SWIMMING POOLS				
Mapelastic Smart	•			
Mapeproof Swell			•	
Mapeband		•	•	
Mapenet 150	•			
BALCONIES & TERRACES				
Mapelastic Turbo	•			
Mapenet 150	•			
Mapetex Sel	•			
Mapeband		•	•	
Mapeband TPE			•	
Drain Lateral				•
Drain Vertical				•
Drain Front				•

UNDERGROUND STRUCTURES SELECTION CHART

	Basements		Retaining Walls	Lift Pits	Pile Caps/Beams	Expansion Joints	Construction Joints
	New	Existing					
UNDERGROUND STRUCTURES							
Mapeproof FBT	•		•	•			
Mapeproof HW	•	•	•	•			
Mapeproof Swell		•					
Idrostop	•						•
Idrostop Soft	•						•
Mapeband TPE	•	•				•	
Idrostop PVC BI-BE	•					•	
Planiseal 88		•	•	•	•		
Mapelastic Foundation		•		•	•		
Lamposilex		•					
Plastimul	•		•	•			
Plastimul 2K Plus	•	•	•	•			
Mapethene EQ	•		•	•			
Mapethene LT	•		•	•			

	Concrete	Asphalt	Decks
CAR PARKS			
Purtop 400 M	•	•	•
Purtop 1000	•	•	•

BELOW GROUND SYSTEMS

Complete waterproofing systems for new and existing structures below ground level.

BS 8102

SUMMARY

BS 8102 The protection of structures against water from the ground. Almost all basement structures are likely to be subject to water pressure at some period of their life.

ASSESSING RISK

- Topography of the surrounding land (i.e. its geographical features) in relation to the underground structure.
- The highest likely level of the water table and the potential for a perched water table.
- Any missing ground / ground water information, to be ascertained by undertaking a site investigation, observing BS 59230 and BS EN1997.
- Analysis of the soil for drainage characteristics, to be determined in accordance with BS 8004.
- The consequences of any leakage, condensation or dampness.
- The feasibility and form of remedial works.
- The risk of aggressive ground water penetrating inadequately watertight construction.
- The risk of changes to the surrounding groundwater levels.

“The balancing of cost against risk, in choosing whether further construction cost or further maintenance cost will assume priority in choosing whether the building contractor, will place greater or less emphasis on a performance requirement”.

PREPARE FOR THE WORST

Taking account of the considerations above, the designer will be in a position to specify the most appropriate basement waterproofing system to achieve the required internal environment type.

With any below-ground structure, however, there is always an increased risk of water ingress in exceptional circumstances, such as a burst water main or – increasingly often – a flash flood and, therefore, we would recommend that such ‘worst case’ scenarios are accounted for in any plans.

Designers should also remember that, even when comprehensive information is available regarding the site, it is their responsibility to specify measures to protect the structure against other sources besides underlying water tables.

These can include:

- The inflow of surface water, ranging from rainwater to wastage from burst water mains
- Water pressures acting on the external retaining wall system
- Water pressures below the slab base

A successful waterproofing design should result in a system that can withstand a pre-determined head of water, or control the water before it reaches the structure.

BASEMENT USAGE

Internal Environment	Usage	Requirement
Grade 1: Basic Utility	Car Parking and plant rooms.	Some seepage and damp patches tolerable.
Grade 2: Better Utility	Workshop and plant rooms, requiring drier environment and retail storage areas.	No water penetration but moisture vapour tolerable.
Grade 3: Habitable	Ventilated residential areas, including offices, restaurant and leisure centres. Archives and stores, computers, requiring a controlled environment.	Totally dry environment.

CONSTRUCTION

Grade	Type of Protection	Description
Type A	Tanked Protection.	Constructed from concrete or masonry and offering no protection against the ingress of water and water vapour by the nature of its design. Protection therefore is totally dependent on a continuous barrier system applied to the structure.
Type B	Structural Integral Protection.	Designed and constructed in reinforced or pre-stressed concrete either to BS 8110 (to minimise water penetration) or to BS 8007 (to prevent water penetration). Transmission of water vapour may not be wholly prevented.
Type C	Drained Protection.	Constructed from structural concrete or masonry to minimise the ingress of water. Any moisture, which does find its way into the basement, is channelled, collected and discharged within the cavity.

NEW - MAPEPROOF FBT



Synthetic fully bonded waterproof membrane,
radon and methane barrier, laminated with
non-woven fabric for underground structures.



WHERE TO USE

Waterproofing horizontal and vertical surfaces of underground structures before pouring concrete such as:

- Basements, car parks and garages
- Underground areas in general
- Swimming pools, basins and storage tanks
- Underpasses

Mapeproof FBT may be applied underneath foundation slabs and against diaphragms, pile walls, sheet piling and other retaining structures for excavation work.

ADVANTAGES

Mapeproof FBT is made up of a synthetic membrane, laminated with non-woven polypropylene fabric which, once concrete has been poured, forms a monolithic bond with the concrete and remains perfectly bonded over time.

Mapeproof FBT is a waterproofing system that becomes fully bonded to poured concrete and prevents water from migrating laterally between the foundation structure and the membrane. Completely watertight overlaps.

Mapeproof FBT is cold-applied and no heat and/or naked flames are required. It is positioned before placing the steel reinforcement and pouring the concrete and does not require a protective layer.

EASY TO INSTALL

Mapeproof FBT is extremely flexible and is easy to shape during installation so that it follows the form and geometry of the substrate.

TECHNICAL CHARACTERISTICS

Mapeproof FBT is a waterproofing membrane made up of a synthetic FPO sheet tightly coupled to a layer of non-woven fabric. When it comes into contact with poured concrete it forms a tough bond with the concrete.

Mapeproof FBT is resistant to natural agents and aggressive substances and substances normally found in groundwater and in the soil. It is highly durable and resistant to ageing from UV rays while normal site activities are being carried out.

Mapeproof FBT forms a highly effective barrier against groundwater, moisture in the ground, radon and methane.

Mapeproof FBT complies with the requirements of the standard EN 13967 ("Flexible sheets for waterproofing – Plastic and rubber damp proof sheets including plastic and rubber basement tanking sheet").

ELEMENTS OF THE SYSTEM

Mapeproof FBT system must be used together with other accessory products to guarantee the water tightness of all construction details that are typically found on a construction site. The products used in the system are as follows:

- **Mapeproof FBT Tape** adhesive tape to form sealed joints over the top of adjacent sheets;
- **Mapeproof SA Tape** adhesive tape to form sealed joints under adjacent sheets;
- **Mapeproof BA Tape** watertight, double sided adhesive sheet membrane which are placed along fillet joints between horizontal and vertical surfaces and between adjacent vertical surfaces;
- **Mapeproof Fix Tape** double-sided adhesive tape to hold sheets in place during installation.

BELOW GROUND SYSTEMS



COMPLETE SYSTEM

1. Lean Mix Concrete.
2. Mapeproof HW.
3. Idrostop Soft.
4. Mapethene Primer.
5. Mapeproof Mastic.
6. Mapeproof CD Washer.
7. Mapeproof HW.
8. Mapethene LT.

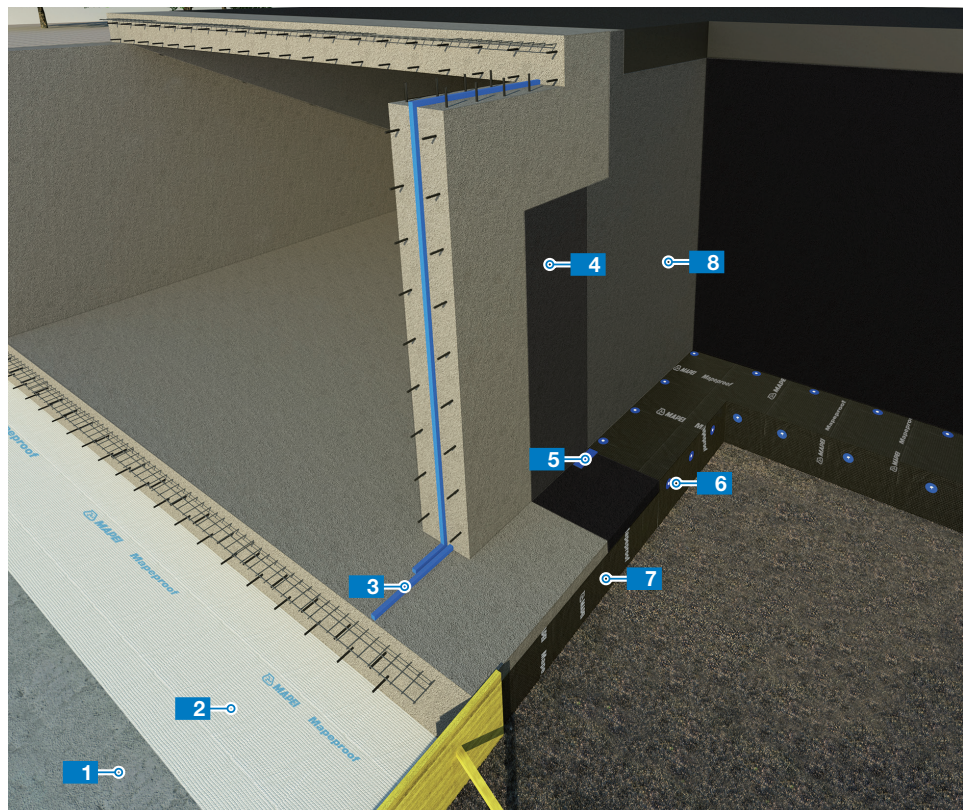

For illustration purposes only, Mapei can provide bespoke CAD details for your design.



MAPEPROOF FBT

Pre-applied composite synthetic waterproof membrane suitable for both horizontal and vertical surfaces forms a monolithic bond with concrete.

Width of roll	1 m.
Nominal thickness	1.7 mm.
Weight	≥ 1.3 mm.
Packaging	Pallets with 15 x 20 m ² rolls.



SCAN FOR TDS



MAPEPROOF HW

Bentonite waterproofing sheet for structures below ground level, suitable for both horizontal and vertical surfaces.

Swelling index (ASTM D 5887)	28 ml/2 g.
Peel adhesion to concrete (ASTM D 903)	4 kN/m
Thickness of product (EN ISO 9863-1)	6.0 mm.
Packaging	1.1 m x 5 m rolls. 2.5 m x 22.5 m rolls. 5 m x 40 rolls.



SCAN FOR TDS



MAPEPROOF SWELL

Hydro-expansive, rubber-based hydrophilic sealant paste in tubes, applied using an extrusion gun.

Polymerisation time	2 mm every 9 hours.
Consumption	Approximately 320 ml every 3 metres (10 x 10 mm section).
Tear strength (ISO 34-1)	10 N/mm.
Packaging	Boxes containing: 6N ^o 320 ml cartridges.



SCAN FOR TDS

BELOW GROUND SYSTEMS



10
YEAR
GUARANTEE

MAPEPROOF MASTIC

Bentonite paste made from natural sodium bentonite and plasticising additives for sealing elements which pass through surfaces.

Composition	– 50% natural sodium bentonite. – 50% non-toxic plasticising agents.
Behaviour in water	The bentonite hydrates freely and swells.
Packaging	15 kg drums.



SCAN FOR TDS



10
YEAR
GUARANTEE

IDROSTOP SOFT

Hydro-expansive, high-flexibility bentonite jointing profile for waterproofing construction joints and second pours of concrete.

Shape	Pre-formed strip.
Size	25 x 20 mm.
Application	Bonded in place using MAPEFLEX MS 45 or ULTRABOND MS RAPID one-component adhesives.
Packaging	6 x 5 m rolls.



SCAN FOR TDS



10
YEAR
GUARANTEE

MAPEPROOF SEAL

Natural sodium bentonite in powder form for localised strengthening of waterproofing layers made using MAPEPROOF bentonite sheets.

Liquidity limit (UNI 10040)	> 550%
Water absorption (ASTM E 946/43)	> 750%
1500/1000 Marsh viscosity	38-40"
Packaging	25 kg paper bags.



SCAN FOR TDS

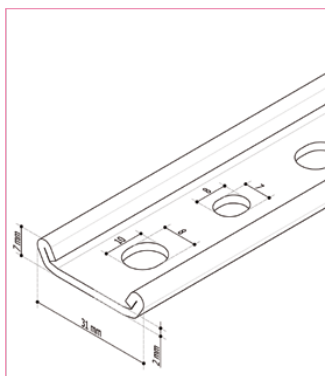

10
YEAR
GUARANTEE

MAPEPLAN METALBAR

Metal fixing profile in galvanized carbon steel, pre punched, with oval perforations, to be used as anchoring and finishing element for waterproofing membranes.

Packaging

10 pieces / box.
(20 m or 30 m).



SCAN FOR TDS



10
YEAR
GUARANTEE

MAPEPROOF CD

Washers used to fasten MAPEPROOF bentonite sheets in place.

Packaging

Boxes of 500 pieces.

Complementary Product Ranges.

Building

Concrete

Sealants & Adhesives

BELOW GROUND SYSTEMS



Mapelastic Foundation

COMPLETE SYSTEM

1. Primer 3296.
2. Mapelastic Foundation.
3. Polyfond Kit Drain.

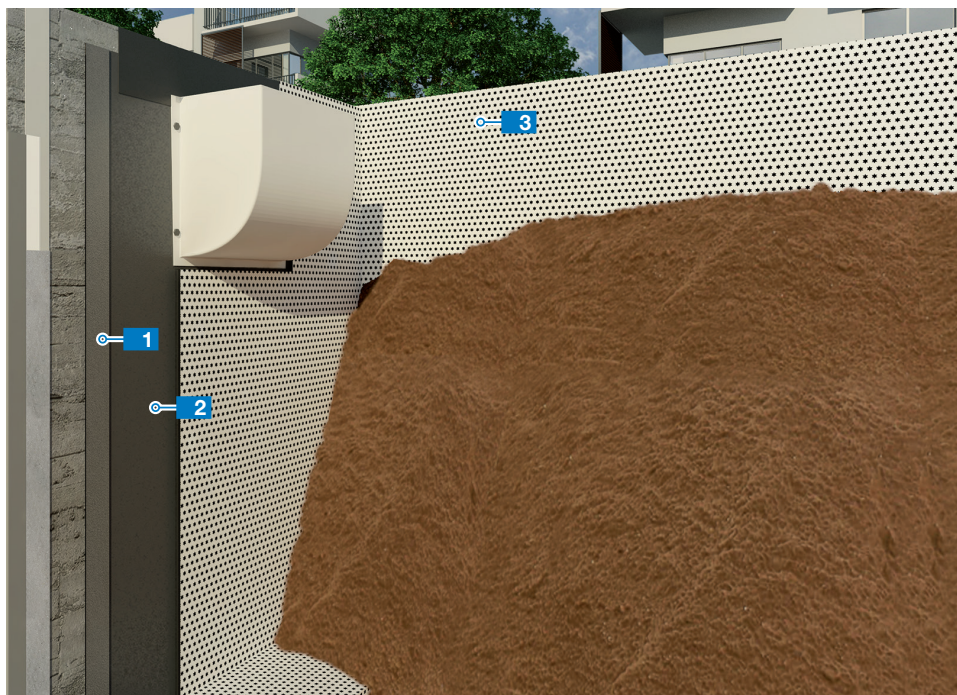

For illustration purposes only, Mapei can provide bespoke CAD details for your design.



MAPELASTIC FOUNDATION

Two-component, flexible cementitious mortar for waterproofing concrete surfaces subject to negative and positive hydraulic pressure.

Consistency	Thixotropic.
Minimum applicable thickness	2 mm in 2 coats.
Storage	12 months.
Packaging	32 kg kits: Component A: 22 kg bags; Component B: 10 kg drums.



SCAN FOR TDS



PRIMER 3296

Acrylic primer in water dispersion with high penetration, for consolidating surfaces to be used with MAPELASTIC FOUNDATION.

Drying time	2 hours.
Application	Brush or roller.
Packaging	5 kg and 10 kg drums.



SCAN FOR TDS



POLYFOND KIT DRAIN

POLYFOND KIT DRAIN is ideal for application where the waterproofing of retaining walls, below grade structures and foundations requires both protection and drainage, and is also ideal for drainage in lightweight roof gardens.

Length	20 m.
Width	2 m or 2.5 m.
Packaging	Rolls per pallet: 6



SCAN FOR TDS

BELOW GROUND SYSTEMS



10
YEAR
GUARANTEE

PLASTIMUL PRIMER

Solvent-free, bitumen primer for treating substrates before applying waterproofing products from the PLASTIMUL range.

Consistency	Liquid.
Storage	12 months.
Condition of substrate	Dry, slightly damp.
Packaging	10 kg drums.



SCAN FOR TDS



CE
EN 15814
W1-CB1
C1-A2
10
YEAR
GUARANTEE

PLASTIMUL

Bitumen waterproofing emulsion for general purpose use.

Consistency	Thick paste.
Storage	24 months.
Packaging	12 kg and 20 kg drums.



SCAN FOR TDS



CE
EN 15814
W2A-CB2
C2A-R3
10
YEAR
GUARANTEE

PLASTIMUL 2K PLUS

Two-component, solvent-free, quick-drying, low-shrinkage, high flexibility bitumen waterproofing emulsion containing cellulose fibres.

Consistency	Paste.
Storage	12 months.
Packaging	30 kg units: Component A: 22 kg; Component B: 8 kg.



SCAN FOR TDS



10
YEAR
GUARANTEE

MAPETHENE PRIMER

Solvent-free bitumen primer for membranes from the MAPETHENE line.

Application temperature	From -5°C to +40°C
Drying time (min)	Approx 45
Consumption	0.1-0.2 kg/m ²
Packaging	10 kg drums.



SCAN FOR TDS



CE EN 13966 CE EN 14967 **10**
YEAR
GUARANTEE

MAPETHENE LT

Self-adhesive bituminous membrane with 25mm selvedge strip.

Width (mm)	1000
Thickness (mm)	1.5
Weight (kg/mq)	1.5
Impermeable to water (bar)	8
Packaging	20 m x 1 m.



SCAN FOR TDS



10
YEAR
GUARANTEE

MAPETHENE EQ

Self-adhesive bituminous membrane for waterproofing structures below ground level.

Width (mm)	1,000
Thickness (mm)	1.2
Weight (kg/mq)	1.2
Packaging	20 m x 1 m.



SCAN FOR TDS

BELOW GROUND SYSTEMS





10
YEAR
GUARANTEE

MAPEPROOF LIQUID MEMBRANE

Two-component polyurethane elastomeric, thixotropic, liquid waterproofing membrane for sealing, filling, detailing Mapecproof FBT and Mapethene membranes.

Appearance	paste, thixotropic
Consumption	1.2 kg/m ² /mm (average consumption on smooth concrete surfaces)
Packaging	Single pack (A+B) 3.5 kg. Component: A: 2.8 kg. Component B: 0.7 kg



SCAN FOR TDS



10
YEAR
GUARANTEE

IDROSTOP 10 AND 15

Hydrophilic expandable rubber section for watertight construction joints.

Size available	20 x 10 mm (Idrostop 10). 20 x 15 mm (Idrostop 15).
Storage	12 months.
Waterproofness	Up to 5
Packaging	Idrostop 10: 6 x 10 m rolls. Idrostop 15: 6 x 7 m rolls.



SCAN FOR TDS

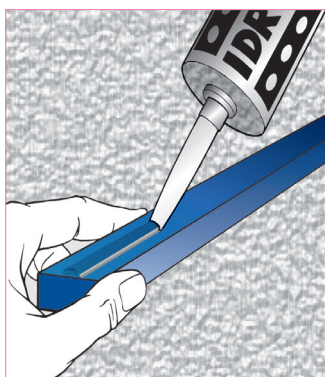

10
YEAR
GUARANTEE

IDROSTOP MASTIC

One-component adhesive for laying IDROSTOP.

Consistency	Paste.
Storage	18 months.
Consumption	Approximately 300 ml per 5 linear metres of IDROSTOP.
Packaging	Per box: 12 x 300ml cartridges.



SCAN FOR TDS

BALCONIES

Rapid systems for waterproofing balconies.

BALCONIES



COMPLETE SYSTEM

1. Existing Ceramic Tiles.
2. Adesilex P4.
3. Mapelastic Turbo.
4. Mapetex Sel.
5. Mapeband.
6. Keraquick S1.
7. Ultracolor Plus.

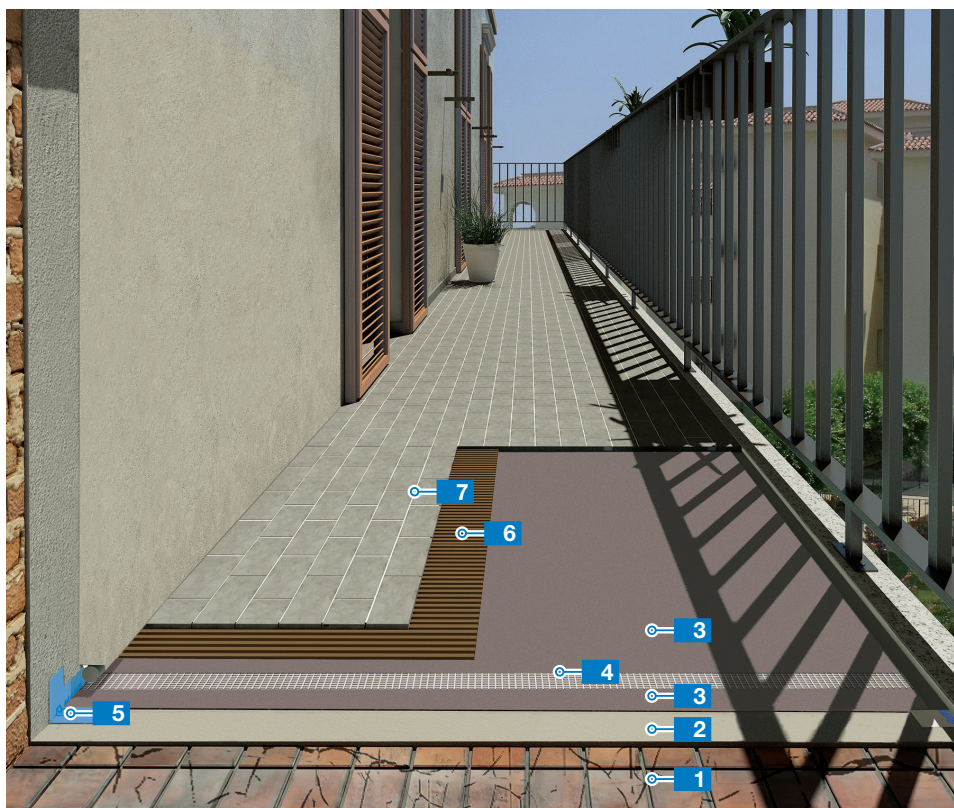

For illustration purposes only, Mapei can provide bespoke CAD details for your design.



MAPELASTIC TURBO

Two-component, rapid-drying elastic cementitious mortar for waterproofing terraces and balconies, including at low temperatures and on substrates not completely dry. Must include a reinforcing mesh such as MAPENET 150 or MAPETEX SEL.

Consistency	Comp A: powder Comp B: liquid.
Waiting time before tiling	4-24 hours.
Packaging	36 kg kit: Component A: 20 kg bags; Component B: 16 kg canister.



SCAN FOR TDS



MAPETEX SEL

Non-woven, macro-holed polypropylene fabric for reinforcing Mapei MAPELASTIC TURBO. Improves puncture resistance, elongation and crack-bridging.

Type of fibre	Polypropylene.
Storage	Store in a dry, covered area.
Packaging	25 m-long rolls with a width of 1 m.



SCAN FOR TDS



MAPEBAND

Alkali-resistant rubber tape with textile backing/edges. For the flexible waterproofing of angles / junctions expansion joints to be treated with MAPELASTIC TURBO.

Colour	Blue.
Packaging	50m x 120mm rolls. Internal corners. External corners. 400 x 400mm gaskets. 120 x 120mm gaskets. T profiles. Cross profiles.



SCAN FOR TDS

SHOWERS AND WETROOMS

Mapei has developed various product systems to carry out secure waterproofing work, such as the range of cementitious and acrylic waterproofing products for showers and wet rooms.

SHOWER AND WETROOMS



COMPLETE SYSTEM

1. Existing Tiles.
2. Eco Prim T Plus.
3. Planitop Fast 330.
4. Mapelastic AquaDefense.
5. Mapeband Easy.
6. Elastorapid.
7. Kerapoxy Design.
8. Mapesil AC.



For illustration purposes only, Mapei can provide bespoke CAD details for your design.

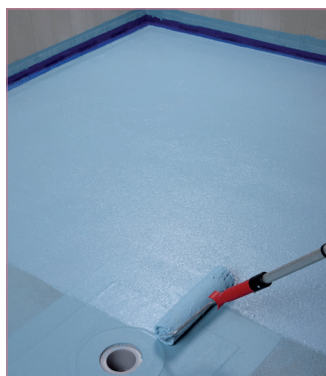

MAPELASTIC AQUADEFENSE

Ready to use, flexible, ultra rapid drying waterproofing membrane for interior use in showers and wet rooms. Can be tiled after approx. 4 hours. For use on screed, render, concrete, plywood and ceramic finishes. Can be reinforced with MAPETEX 50 to provide an anti-fracture membrane.

Waiting time between first and second coat at 23°C and 50% RH	Approximately 1 hour.
Consumption	1 kg/m ² per two coats.
Packaging	15 kg & 7.5 kg drums.



SCAN FOR TDS



MAPETEX 50

Non-woven polypropylene fabric (weight 50 g/m²) for reinforcing waterproof membranes.

Appearance	Black non-woven fabric.
Weight	50 g/m ²
Tensile strength	– 1.4 kN/m (lengthways). – 1.2 kN/m (widthways).
Packaging	25 m x 100 cm and 25 m x 20 cm wide rolls.



SCAN FOR TDS



MAPEBAND EASY

Non-woven polypropylene fabric, reinforcing tape.

Thickness	0.68 mm.
Width	130 mm.
EMICODE	EC1 Plus - very low emission.
Packaging	– 30 m rolls. – 10 m rolls. – 90° and 270° angular pieces. – Templates to make through holes (200 x 200 mm and 400 x 400 mm).



SCAN FOR TDS

SHOWER AND WETROOMS

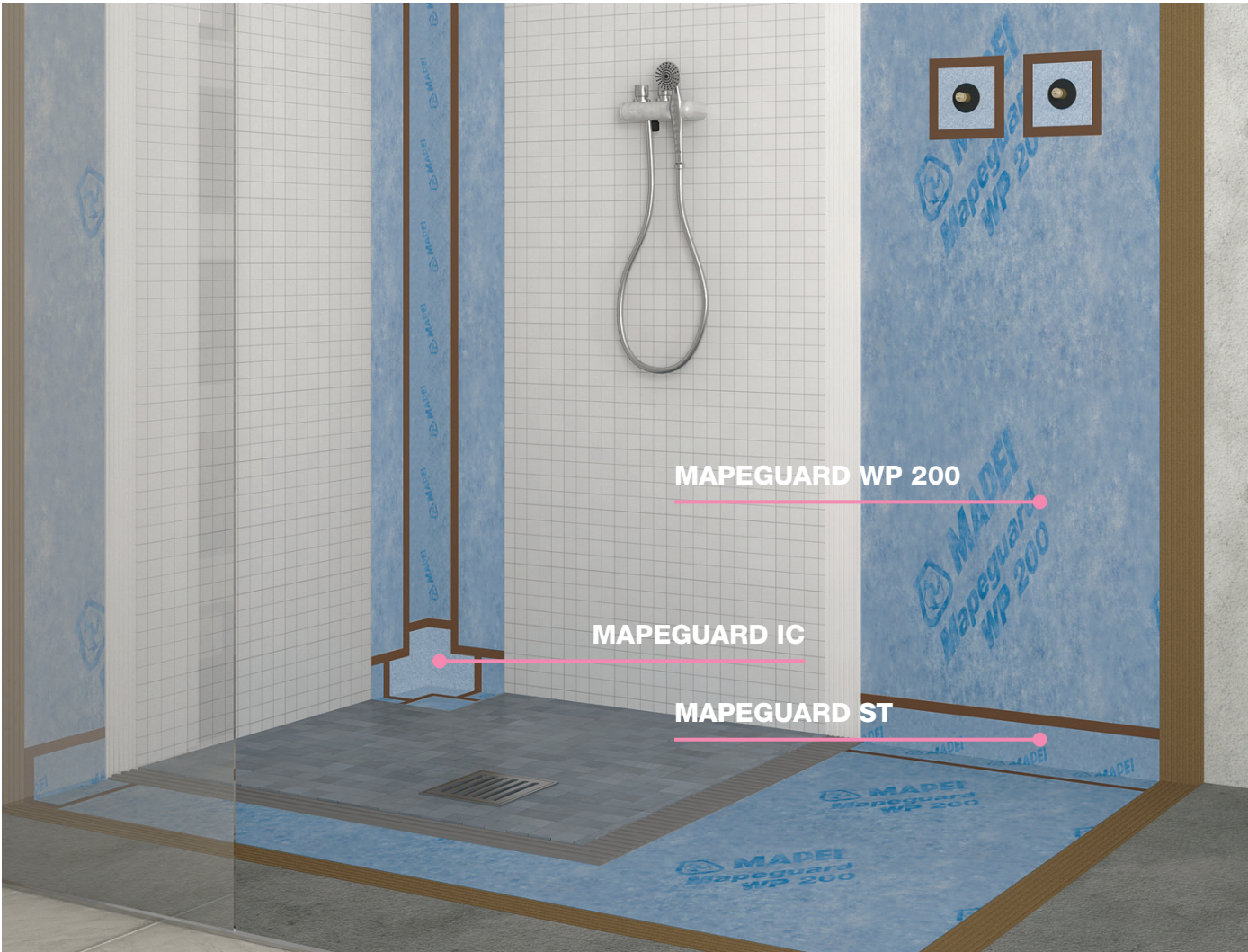

For illustration purposes only, Mapei can provide bespoke CAD details for your design.



MAPEGUARD WP 200

Alkali-resistant waterproofing and anti-fracture membrane for internal use; suitable for overlaying with ceramic and natural stone floor tiles.

Material	Product made up of three layers of polypropylene / polyethylene.
Thickness of membrane (mm)	0.44 - 0.48 mm.
Width	100 cm.
Length	30 and 5 cm.
Packaging	30 m x 100 cm rolls 5 m x 100 cm rolls



SCAN FOR TDS



10
YEAR
GUARANTEE

MAPEGUARD WP ADHESIVE

Two-component, rapid-drying elastic cementitious adhesive for bonding and sealing overlaps of Mapeguard WP 200 including the tapes and junctions.

Application temperature range	From +5°C to +35°C
Packaging	6.5 kg Units Component A: 3.5 kg. Component B: 3.15 kg.



SCAN FOR TDS

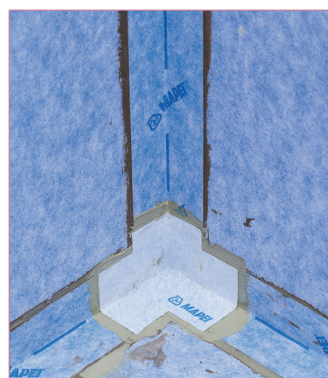

10
YEAR
GUARANTEE

MAPEGUARD IC/EC

Internal and external corner pieces for use with MAPEGUARD WP 200.

Material	Three layered product made of polypropylene / polyethylene.
Length	11/11/9 cm.
Packaging	Available: in packs of 2 Box of 25 singles.



SCAN FOR TDS



10
YEAR
GUARANTEE

MAPEGUARD ST

3-ply waterproof sealing tape.

Material	Three layered product made of polypropylene / polyethylene.
Length	30 m or 10 m.
Width	12 cm.
Packaging	10 m x 12 cm rolls 30 m x 12 cm rolls



SCAN FOR TDS

SWIMMING POOLS

System for waterproofing new and existing swimming pools.

SWIMMING POOLS



MAPELASTIC SMART

Two-component, high flexibility, cementitious mortar applied by brush, roller or spray equipment for waterproofing concrete surfaces. Use in combination with MAPENET 150 reinforcement or MAPETEX SEL for improved crack bridging performance.

Mixing ratio	Comp. A: comp. B = 2:1
Minimum applicable thickness	2 mm in 2 coats.
Packaging	30 kg kits: Component A: 20 kg bags; Component B: 10 kg drums.



SCAN FOR TDS

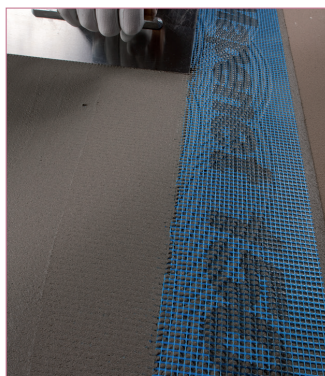

MAPENET 150

Alkali-resistant glass fibre mesh for reinforcing waterproofing membranes such as MAPELASTIC and MAPELASTIC SMART. Blue in colour. Improves the crack-bridging performance of the waterproof membrane.

Mesh size	4 x 5 mm.
Storage	Unlimited.
Packaging	50 m x 1 m rolls.



SCAN FOR TDS



MAPETEX SEL

Non-woven, macro-holed polypropylene fabric for reinforcing Mapei MAPELASTIC TURBO. Improves puncture resistance, elongation and crack-bridging.

Type of fibre	Polypropylene
Storage	Store in a dry, covered area.
Packaging	25 m-long rolls with a width of 1 m.



SCAN FOR TDS



MAPEBAND

Alkali-resistant rubber tape with textile backing/edges. For the flexible waterproofing of angles / junctions expansion joints to be treated with MAPELASTIC SMART.

Colour	Blue.
Packaging	50m x 120mm rolls. Internal corners. External corners. 400 x 400mm gaskets. 120 x 120mm gaskets. T profiles. Cross profiles.



SCAN FOR TDS

RESERVOIRS

Mapei products have been used extensively throughout Europe for many years due to their quality and reliability. Mapei has completed many reservoir projects across the globe. Combining both our technical and manufacturing capabilities, Mapei has the one stop solution track record you require.

RESERVOIRS

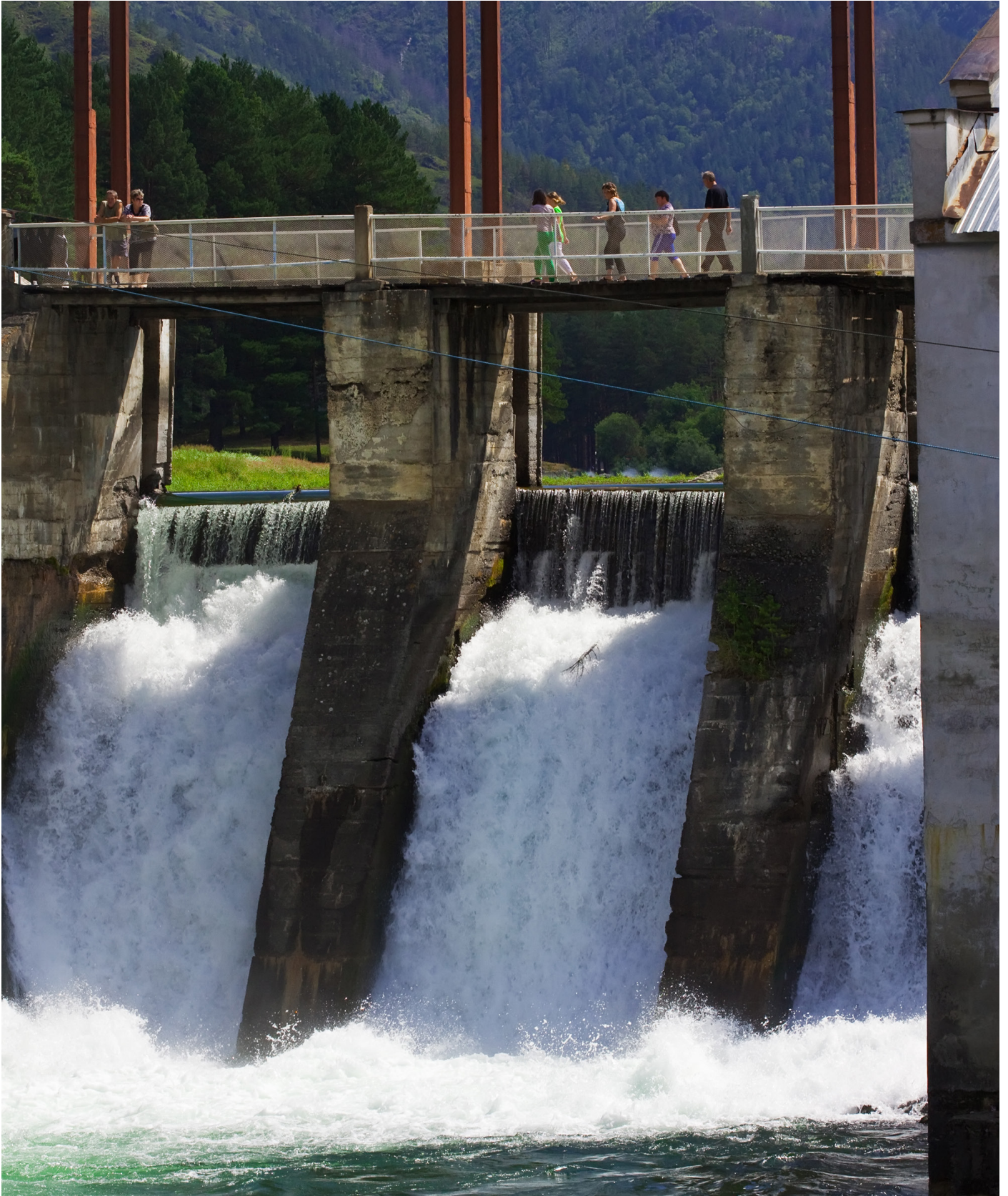



PLANISEAL 88

Osmotic cementitious mortar suitable for contact with drinking water, for waterproofing masonry and concrete structures. Available in white and grey.

Pot life of mix	Approx 1 hour.
Classification	EN 1504-2
Storage	12 months.
Packaging	25 kg bags.



SCAN FOR TDS



PURTOP 1000

Two-component, solvent-free, pure polyurea membrane applied by spray with a high-pressure, bi-mixer type pump, to form waterproof coatings directly on site for storage tanks, basins and hydraulic works.

A/B ratio (by volume)	100/100
Consumption	2.2 kg/m ² per 2 mm of thickness.
Packaging	Component A: 220 kg drums. Component B: 225 kg drums.



Also see our Concrete Repair
range which complements
our waterproofing.

CAR PARKS

Protecting the surface of concrete trafficked areas in structures designed for parking cars and vehicles, is extremely important in order to preserve their functionality and durability, to maintain a high level of safety and minimise maintenance costs. Purtop System guarantees a high level of protection for car park surfaces.

CAR PARKS

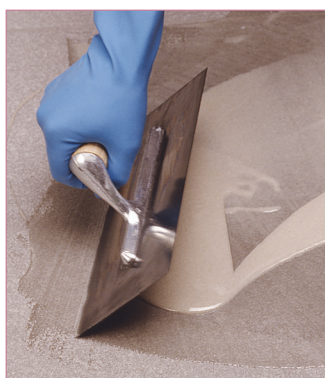

PRIMER SN

Two-component epoxy primer with fillers.

A/B ratio (by volume)	80/20
Consumption	0.3-0.7 kg/m ² per coat.
Packaging	Component A: 16 kg drums. Component B: 4 kg drums.



SCAN FOR TDS

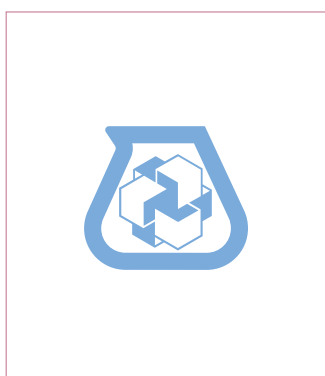

PURTOP PRIMER FT

Quick setting primer for PURTOP Range curing time 30 mins at 23°C.

Consumption	0.300 kg/m ²
Packaging	Part A: 5.85 kg Part B: 0.85 kg



SCAN FOR TDS



PURTOP 400 M

Two-component, solvent-free, hybrid polyurea membrane applied by spray using a high-pressure bi-mixer pump, for waterproofing new constructions or repairing old structures, such as bridge and viaduct beams.

A/B ratio (by volume)	100/100
Consumption	2 kg/m ² per 2 mm of thickness.
Packaging	Component A: 210 kg drums. Component B: 225 kg drums.



SCAN FOR TDS



PURTOP 1000

Two-component, solvent-free, pure polyurea membrane applied by spray with a high-pressure, bi-mixer type pump, to form waterproof coatings directly on site for storage tanks, basins and hydraulic works.

A/B ratio (by volume)	100/100
Consumption	2.2 kg/m ² per 2 mm of thickness.
Packaging	Component A: 220 kg drums. Component B: 225 kg drums.



SCAN FOR TDS



MAPECOAT TC

Wear-resistant coloured aliphatic polyurethane finish for membranes from the Purtop line.

A/B ratio (by volume)	100/20
Consumption	0.5-0.6 kg/m ² two coats of product.
Packaging	Component A: 15 kg drums. Component B: 3 kg drums.



SCAN FOR TDS

SERVICES

WARRANTIES - WE BACK YOU UP

Our products hold a 10 year warranty subject to our installation guidelines. We can offer longer warranties based on full systems used in conjunction with our installation guidelines and site application inspections. All warranties are to be agreed pre project start date and not during.

Please see our terms and conditions on our website: www.mapei.co.uk

TRAINING - WE CAN HELP

We can provide the following to make sure your teams/contractors are fully trained in using Mapei materials and best application methods.

Dedicated product/application - Mapei training academy – our offices.

Clerkenwell London – specifically designed for presentations and meetings.

CPD'S / DEMO'S / TALKS - WE OFFER THE FOLLOWING:

RIBA accredited CPD'S
Mapei CPD
Tailored CPD'S

On/off site toolbox talks – on any of our products.

OUR TEAM AND SERVICES

Area Sales Managers

Category Managers

Specification Managers

Technical Team

Customer Services

Product Managers

OUR SERVICES INCLUDE

Complete Product Ranges

Product Warranties

Specifications

CPD'S

Off & Onsite Training

CAD & BIM Support

TECHNICAL BOOKS

YOU WILL FIND THESE
TECHNICAL GUIDES:
ONLINE AT MAPEI.CO.UK.

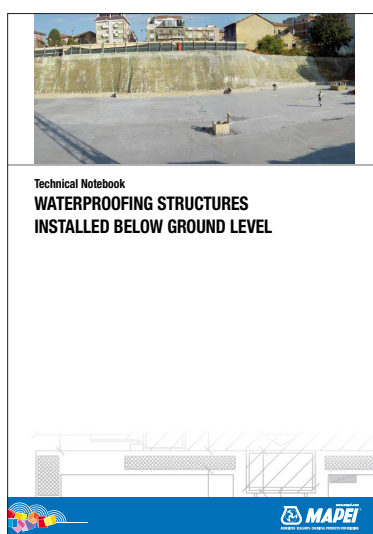

Technical Notebook
Waterproofing Structures
Installed Below Ground Level

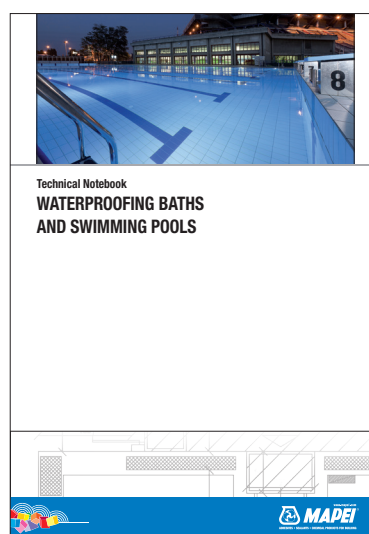

Technical Notebook
Waterproofing Baths and
Swimming Pools

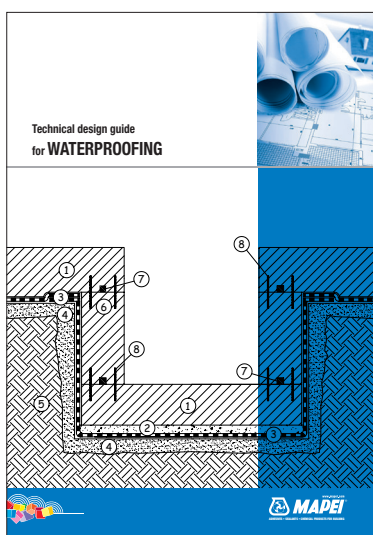

Technical Design Guide
for Waterproofing

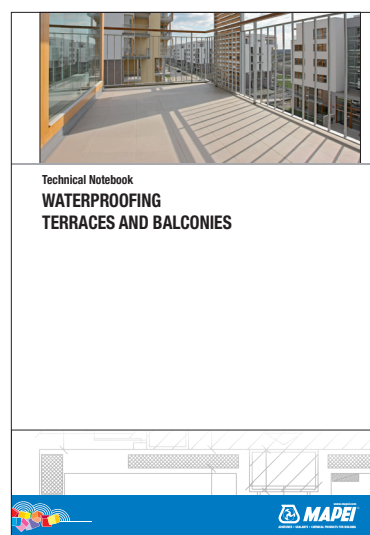

Technical Notebook
Waterproofing Terraces
and Balconies

USEFUL INFORMATION



HOW MAPEI CAN HELP YOU

Mapei's renowned specification and technical services teams offer assistance with compiling the best possible waterproofing specification for your project, protecting your structure from the damaging effects of water ingress across many applications.

For technical or specification assistance please contact us using the details across the page.

THE WORLD OF MAPEI IN YOUR HANDS DOWNLOAD YOUR APP TODAY



PLACE AN ORDER:

sales@mapei.co.uk



TECHNICAL QUESTIONS:

technical@mapei.co.uk

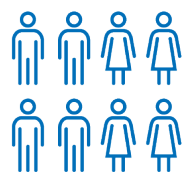

OFFICE OPENING HOURS:

Monday – Friday

Technical: 7:00am - 7:00pm

Marketing: 8:30am - 5:00pm

Finance: 8:30am - 5:00pm

Customer services/orders: 7:00am - 7:00pm

Mapei World London City Showroom: 9:00am - 5:00pm

TELEPHONE NUMBERS:

0121 508 6970 (DIALLING OPTIONS BELOW)

Press – 1 – Orders or customer services

Press – 2 – Technical

Press – 3 – Finance or accounting

Press – 4 – Marketing

Press – 5 – Reception

Press – 6 – Clerkenwell showroom

EVERYTHING'S **OK** WITH **MAPEI**

MAPEI WORLD LONDON CITY

6 Great Sutton Street
Clerkenwell
London
EC1V 0BX
T: 020 3302 9610
E: clerkenwell@mapei.co.uk

MAPEI UK LTD

Mapei House
Steel Park Road
Halesowen
West Midlands. B62 8HD
T: 0121 508 6970
E: info@mapei.co.uk