

IDROCRETE KR 1000 WATERTIGHT CONCRETE PRE-FIXED FORMWORK

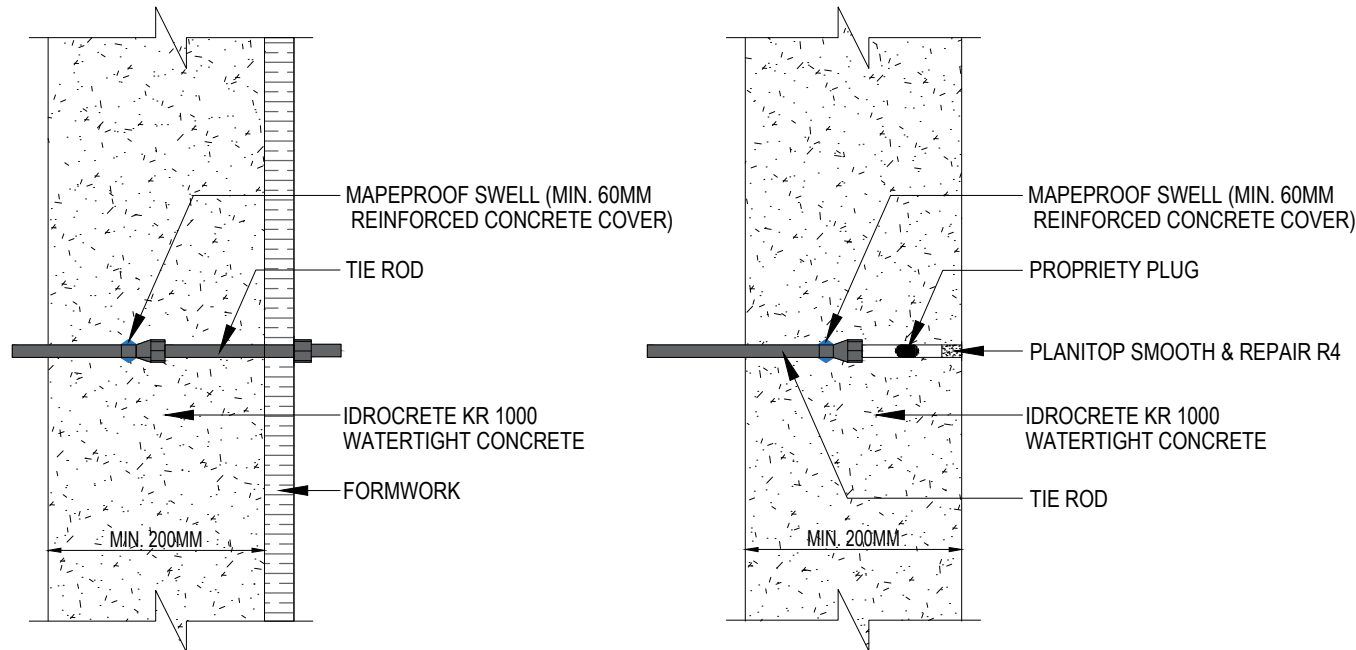

PRIOR TO FORMWORK REMOVAL

COMPLETED DETAIL

Drawing Details:

MAPEPROOF SWELL - Hydro-expansive, rubber-based hydrophilic sealant paste in tubes, applied using an extrusion pistol.

PLANITOP SMOOTH & REPAIR R4 - Quick-setting, fibre-reinforced, compensated-shrinkage, thixotropic cementitious mortar for repairing and smoothing concrete, applied in various thicknesses from 3 to 40 mm in a single layer.

IDROCRETE KR 1000 - Powdered crystallising admixture for waterproof concrete.

STATUS: APPROVED

Drawing Title:
IDROCRETE KR 1000 WATERTIGHT
CONCRETE-PRE-FIXED
FORMWORK
Drawing Ref: MA100B

Date: 31/08/2023

Drawn by: DB
Checked by: LR
Approved by: ADL



Mapei House, Steel Park Road,
Halesowen, B62 8HD
Website: www.mapei.co.uk,
Email: technical-uk@mapei.co.uk

These standard details are provided for guidance only and should not be considered as comprehensive for design or construction purposes. It is the responsibility of the appointed principal designer to ensure that these details are appropriately adapted for specific projects.