

# IDROCRETE KR 1000 WATERTIGHT CONCRETE PIPE THROUGH RC WALL

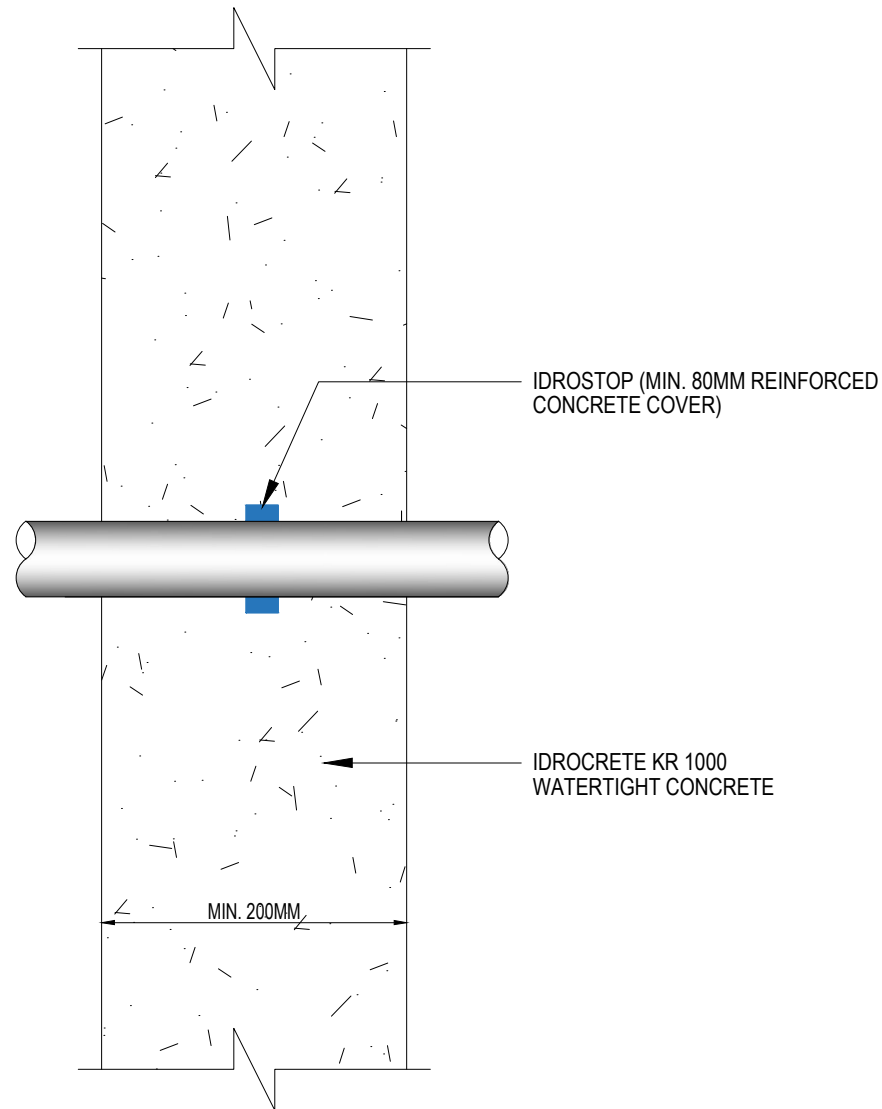

## Drawing Details:

IDROSTOP - Hydrophilic, expanding rubber profiles for waterproof working joints.

IDROCRETE KR 1000 - Powdered crystallising admixture for waterproof concrete.

**STATUS:** APPROVED

**Drawing Title:**  
IDROCRETE KR 1000 WATERTIGHT  
CONCRETE-PIPE THROUGH RC  
WALL

**Drawing Ref:** MA88B

**Date:** 31/08/2023

**Drawn by:** DB

**Checked by:** LR

**Approved by:** ADL



Mapei House, Steel Park Road,  
Halesowen, B62 8HD

Website: [www.mapei.co.uk](http://www.mapei.co.uk),  
Email: [technical-uk@mapei.co.uk](mailto:technical-uk@mapei.co.uk)