

IDROCRETE KR 1000 WATERTIGHT CONCRETE WALL PENETRATION (BOX OUT METHOD)

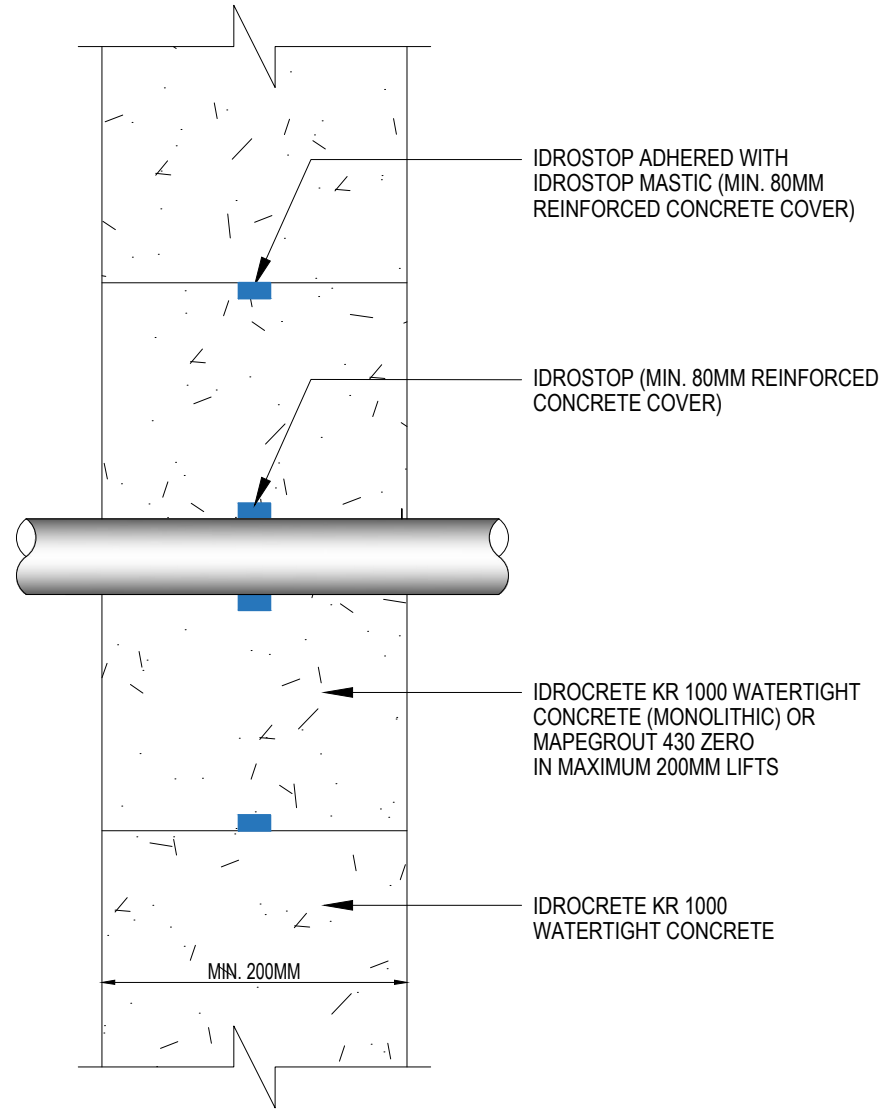

Drawing Details:

IDROSTOP - Hydrophilic, expanding rubber profiles for waterproof working joints.

IDROSTOP MASTIC - a ready to use solvent-free single component adhesive with a base of MS polymers.

MAPEGROUT 430 ZERO - a pre-blended, compensated-shrinkage mortar in powder form made from cementitious binders, selected fine-grained aggregates, special additives and synthetic fibres according to a formula developed in the MAPEI R&D laboratories.

IDROCRETE KR 1000 - Powdered crystallising admixture for waterproof concrete.

STATUS: APPROVED

Drawing Title:
IDROCRETE KR 1000 WATERTIGHT CONCRETE-WALL PENETRATION (BOX OUT METHOD)

Drawing Ref: MA89B

Date: 31/08/2023

Drawn by: DB

Checked by: LR

Approved by: ADL



Mapei House, Steel Park Road,
Halesowen, B62 8HD

Website: www.mapei.co.uk,
Email: technical-uk@mapei.co.uk