

# IDROCRETE KR 1000 WATERTIGHT CONCRETE INFILL DETAIL

IDROSTOP ADHERED TO IDROSTOP MASTIC  
(MIN. 80MM REINFORCED CONCRETE COVER)

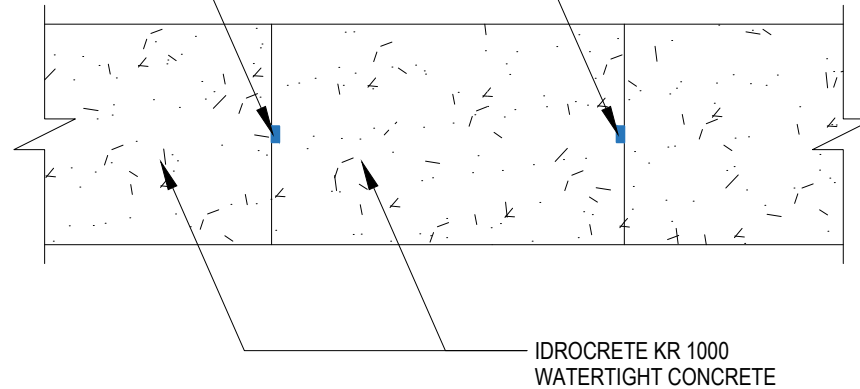

## Drawing Details:

IDROSTOP - Hydrophilic, expanding rubber profiles for waterproof working joints.

IDROSTOP MASTIC - a ready to use solvent-free single component adhesive with a base of MS polymers.

IDROCRETE KR 1000 - Powdered crystallising admixture for waterproof concrete.

**STATUS:** APPROVED

**Drawing Title:**  
IDROCRETE KR 1000 WATERTIGHT  
CONCRETE-INFILL DETAIL

**Drawing Ref:** MA98B

**Date:** 31/08/2023

**Drawn by:** DB

**Checked by:** LR

**Approved by:** ADL



Mapei House, Steel Park Road,  
Halesowen, B62 8HD

Website: [www.mapei.co.uk](http://www.mapei.co.uk)  
Email: [technical-uk@mapei.co.uk](mailto:technical-uk@mapei.co.uk)