

MAPEPROOF AL AP & IDROCRETE KR 1000 WATERTIGHT CONCRETE PILE CAP (OPTION 2)

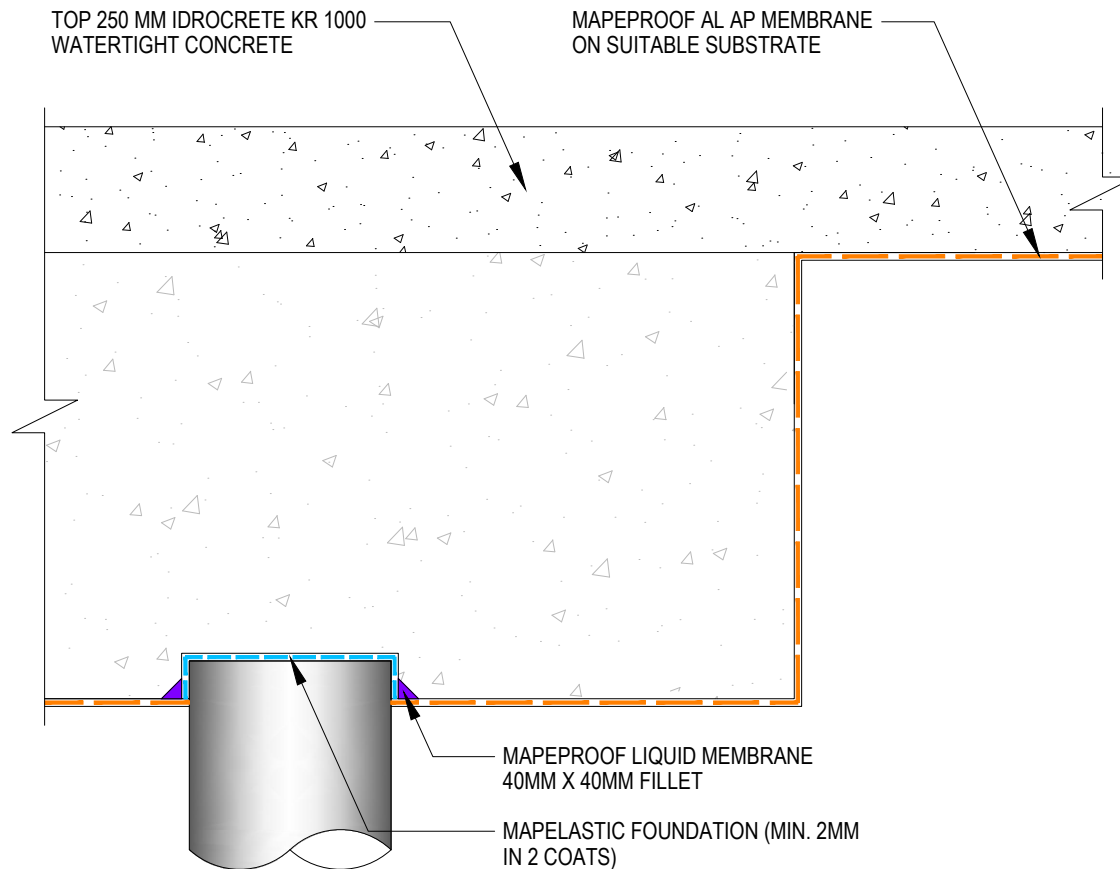

Drawing Details:

MAPEPROOF AL AP - Pre-applied, fully bonded, self-adhering, HDPE waterproofing membrane to protect against water underground structures.

MAPELASTIC FOUNDATION - Two-component, flexible cementitious mortar for waterproofing concrete surfaces subject to negative and positive hydraulic lift.

MAPEPROOF LIQUID MEMBRANE - Two-component polyurethane elastomeric, thixotropic, liquid waterproofing membrane for sealing, filling, detailing Mapeproof AL NA and Mapethene HT/LT membranes.

IDROCRETE KR 1000 - Powdered crystallising admixture for waterproof concrete.

STATUS: APPROVED

Drawing Title:
MAPEPROOF AL AP & IDROCRETE KR 1000 WATERTIGHT CONCRETE-PILE CAP (OPTION 2)

Drawing Ref: MA106B

Date: 02/10/2023

Drawn by: DB

Checked by: LR

Approved by: ADL



Mapei House, Steel Park Road,
Halesowen, B62 8HD
Website: www.mapei.co.uk
Email: technical-uk@mapei.co.uk