

MAPEPROOF HW RC SLAB EXPANSION JOINT WITH IDROSTOP PVC - WALL AND FLOOR JOINT

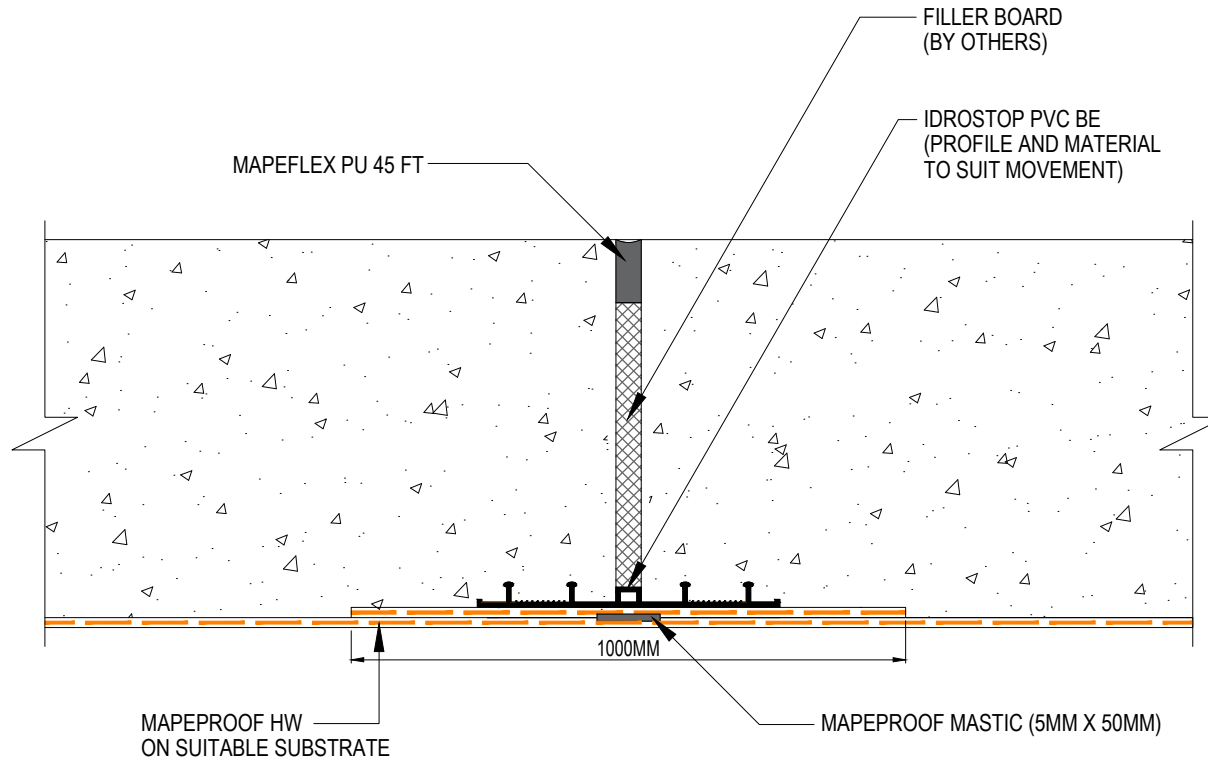

Drawing Details:

MAPEPROOF HW - Bentonite geotextile sheet waterproofing membrane.

MAPEPROOF MASTIC - Bentonite paste made from natural sodium bentonite and plasticising additives for sealing elements which pass through surfaces

MAPEFLEX PU 45 FT - Rapid-hardening paintable polyurethane sealant and adhesive with a high modulus of elasticity for movements up to 20%.

IDROSTOP - Hydrophilic, expanding rubber profiles for waterproof working joints.

IDROSTOP PVC - PVC waterstop for sealing expansion and cold joints

STATUS: APPROVED

Drawing Title:
MAPEPROOF HW-RC SLAB EXPANSION JOINT WITH IDROSTOP PVC-WALL AND FLOOR JOINT
Drawing Ref: MA124B

Date: 31/08/2023

Drawn by: DB
Checked by: LR
Approved by: ADL



Mapei House, Steel Park Road,
Halesowen, B62 8HD
Website: www.mapei.co.uk,
Email: technical-uk@mapei.co.uk

These standard details are provided for guidance only and should not be considered as comprehensive for design or construction purposes. It is the responsibility of the appointed principal designer to ensure that these details are appropriately adapted for specific projects.