

MAPEPROOF HW LIFT PIT OPTION 1

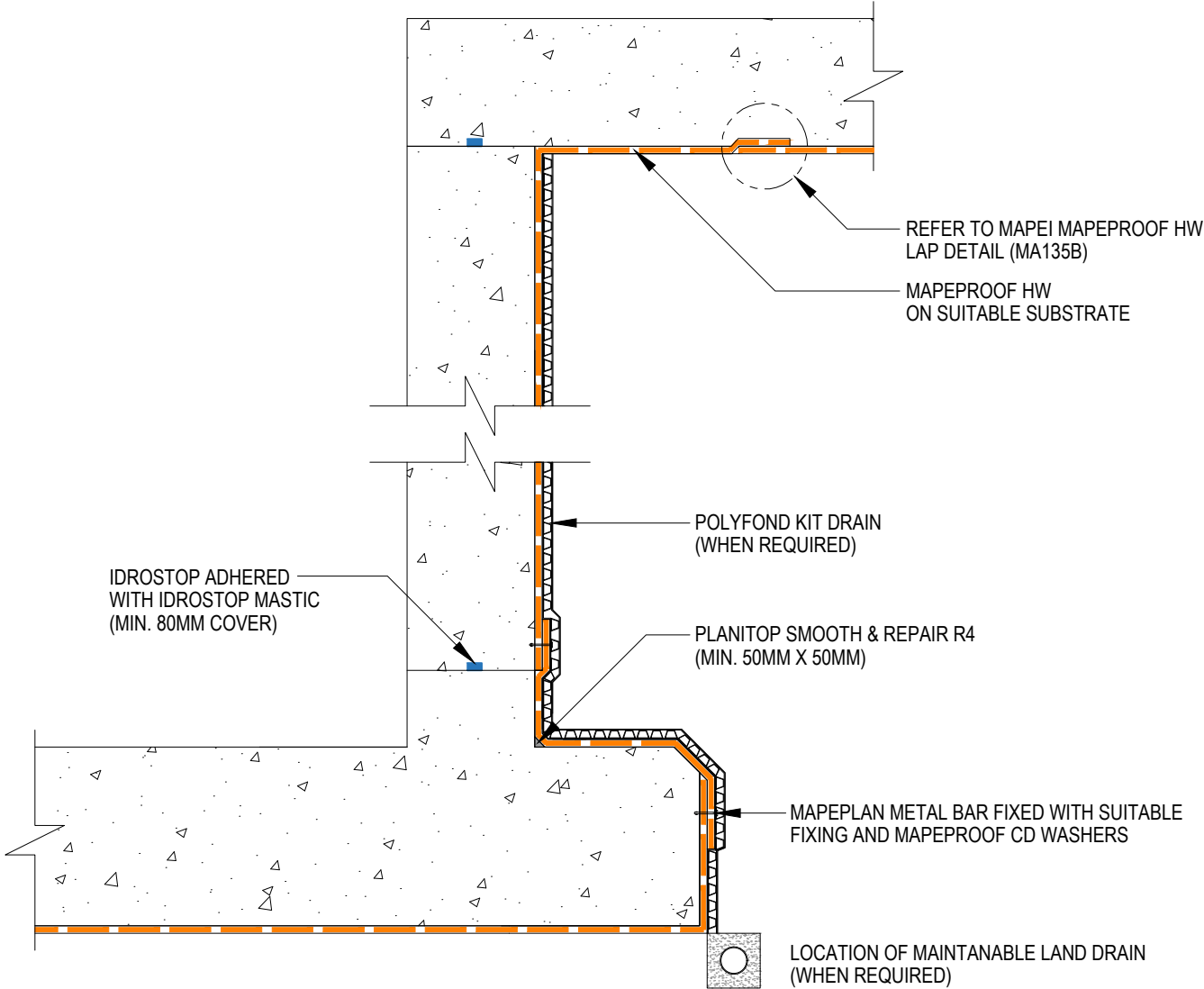

Drawing Details:

MAPEPROOF HW - Bentonite geotextile sheet waterproofing membrane.

IDROSTOP - Hydrophilic, expanding rubber profiles for waterproof working joints.

IDROSTOP MASTIC - One-component adhesive for laying IDROSTOP.

PLANITOP SMOOTH & REPAIR R4 - Quick-setting, fibre-reinforced, compensated-shrinkage, thixotropic cementitious mortar for repairing and smoothing concrete, applied in various thicknesses from 3 to 40 mm in a single layer.

POLYFOND KIT DRAIN - is a protection and drainage system made from high density extruded polyethylene (HDPE) laminated with a polypropylene needle punched nonwoven.

STATUS: APPROVED

Drawing Title: MAPEPROOF HW-LIFT PIT OPTION 1

Drawing Ref: MA125B

Date: 31/08/2023

Drawn by: DB

Checked by: LR

Approved by: ADL



Mapei House, Steel Park Road,
Halesowen, B62 8HD
Website: www.mapei.co.uk,
Email: technical-uk@mapei.co.uk

These standard details are provided for guidance only and should not be considered as comprehensive for design or construction purposes. It is the responsibility of the appointed principal designer to ensure that these details are appropriately adapted for specific projects.