

# Mapeflex MS Crystal

## Mapeflex MS 45

### HYBRID SEALANTS AND ADHESIVES



# Mapeflex **MS Crystal**

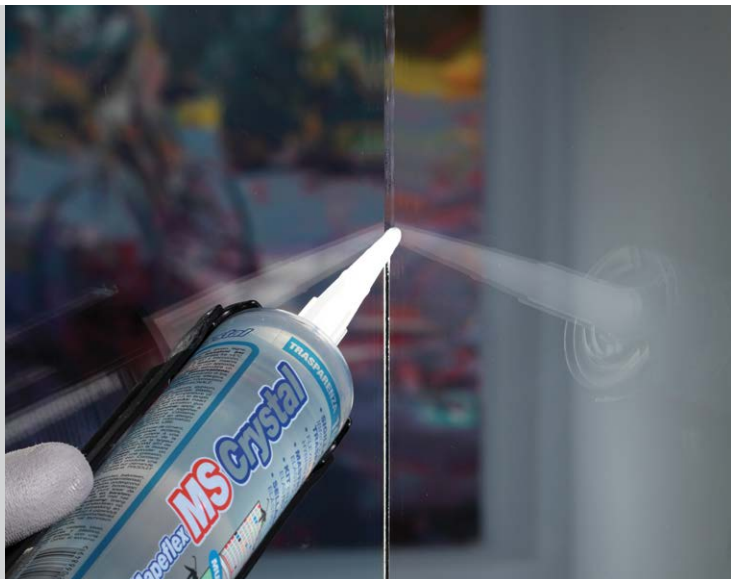

---

# Mapeflex **MS 45**



## Elastic, hybrid, crystal clear sealant and adhesive, even for damp surfaces.

### USES

- Elastic sealing and bonding
- Single product for bonding and sealing
- Almost invisible seals

### ADVANTAGES

- **Crystal clear:** almost invisible for a perfect finish
- **Single product** for sealing joints and bonding different materials
- **Easy** to use both indoors and outdoors
- Bonds even to **damp surfaces**
- **Odourless, solvent-free, very low emission level of VOC, no safety or hazard warning labels required**
- **Long** shelf life
- **Paintable** if required
- Can contribute to obtaining points towards Green Star credits.



---

## Elastic, hybrid sealant and adhesive, even for damp surfaces.

### USES

- Elastic sealing and bonding
- Single product for bonding and sealing

### ADVANTAGES

- **Single product** for sealing joints and bonding different materials
- **Easy** to use both indoors and outdoors
- Bonds even to **damp surfaces**
- **Odourless, solvent-free, very low emission level of VOC, no safety or hazard warning labels required**
- **Long** shelf life
- **Paintable** if required
- Can contribute to obtaining points towards Green Star credits.



## TRANSPARENCY 100%

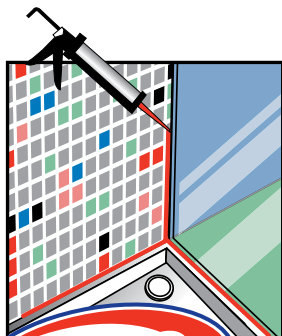

**SEALS**

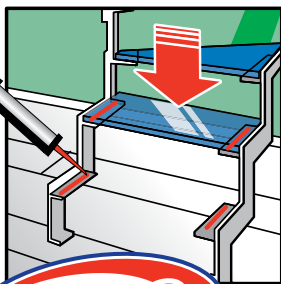

**BONDS**

crystal clear transparency  
(Mapeflex MS Crystal)



opaque transparency  
(traditional silicone)

## FOR DAMP SURFACES



**SEALS**

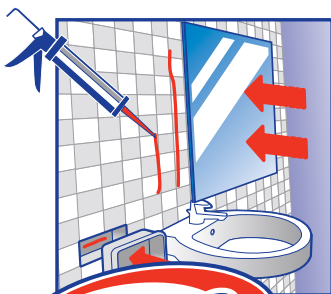

**BONDS**



**WHITE**



**GREY**



**BLACK**

*Due to the printing processes involved, the colours should be taken as merely indicative of the shades of the actual product.*

## Technical Data

Product identity	
Packaging:	<b>300 ml plastic cartridge</b>
Colour:	<b>crystal clear</b>
Storage:	<b>18 months</b>
Dust dry:	<b>15 minutes</b>
Hardening:	<b>3 mm/24 h</b>
Shore A hardness:	<b>35</b>
Modulus of elasticity at 100%:	<b>0.60 N/mm<sup>2</sup></b>
Paintable:	<b>yes</b>
Certification:	<b>EN15651-1 (sealants for façades): F-EXT-INT</b> <b>EN15651-3 (sealants for façades): XS1</b> <b>ISO11600 (mechanical performance): F 20 HM</b>
Primer:	<b>Primer FD</b> on absorbent or compact substrates for severe service conditions <b>Primer P</b> for many types of elastic substrates



## Technical Data

Product identity	
Packaging:	<b>300 ml plastic cartridge</b>
Colour:	<b>white, 113 grey, black</b>
Storage:	<b>15 months</b>
Dust dry:	<b>30 minutes</b>
Hardening:	<b>3 mm/24 h</b>
Shore A hardness:	<b>36</b>
Modulus of elasticity at 100%:	<b>0.75 N/mm<sup>2</sup></b>
Paintable:	<b>yes</b>
Certification:	<b>EN15651-1 (sealants for façades): F-EXT-INT</b> <b>EN15651-4 (sealants for flooring): PW-EX-INT-CC</b> <b>ISO11600 (mechanical performance): F 20 HM</b>
Primer:	<b>Primer FD</b> on absorbent or compact substrates for severe service conditions <b>Primer P</b> for many types of elastic substrates



**MAPEI AUSTRALIA**

180 Viking Drive

Wacol Qld 4076

Phone: 07 3276 5000

Fax: 07 3276 5076

Email: [sales@mapei.com.au](mailto:sales@mapei.com.au)

Web: [mapei.com.au](http://mapei.com.au)

