

the complete range  
of Mapei sealants

# Mapeflex Blackfill

BITUMEN SEALANT

new



#### HEADQUARTERS

MAPEI SpA

Via Cafiero, 22 - 20158 Milan

Tel. +39 02 37673.1

Fax +39 02 37673.214

Internet: [www.mapei.com](http://www.mapei.com)

E-mail: [mapei@mapei.it](mailto:mapei@mapei.it)

C.P. MK 68750 (CB) 10711



maintenance  
work on bitumen  
membranes

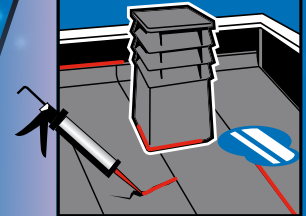

sealing roofs

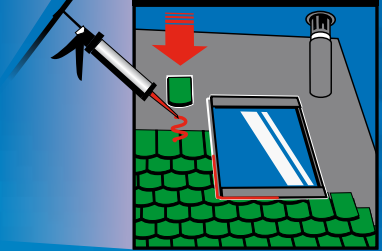

# Mapectflex Blackfill

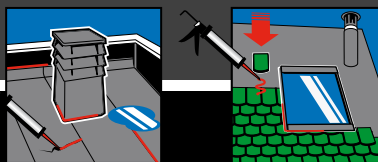

## Where to use

Sealing bitumen membranes, construction features and roofs/coverings, sealing joints to make them immediately waterproof and for applications on substrates which are damp or not perfectly compact and clean.

Ideal as a sealant for blending in overlaps and the ends of existing membranes, repairing localised damage in membranes and blending in bitumen membranes with elements typically found on flat or sloping roofs, such as skylights, chimney pots, ventilation conduits, aerial poles, flashing and tinwork in general. Adheres to bitumen, cementitious substrates, brickwork, wood, metal, glass and a wide range of plastics.

Waterproofs joints and uneven areas immediately after application, without having to wait for any chemical transformation of the product.

## Advantages

- ❑ Easy to extrude and finish
- ❑ Adheres to bitumen and many building materials
- ❑ Also adheres to damp and wet surfaces
- ❑ Becomes waterproof immediately
- ❑ Remains plastic



## It is very important to remember that.....

Bitumen membranes are made from a layer of bitumen and synthetic polymers. It has always been difficult for materials to adhere to such a composite, in that the membrane bleeds oil and plasticisers which tend to detach any other product which tries to adhere chemically to the bitumen. The characteristic of bitumen sealants, on the other hand, is that they physically adhere to the matrix of the bitumen and, therefore, guarantee total fusion with the membrane.

Bitumen sealants are also immediately impermeable to rain and water, in that there is no chemical transformation of the material after it has been extruded, conventional one-component silicone, acrylic and polyurethane-based sealants rely upon chemical transformation, which is why **Mapectflex Blackfill** is so highly appreciated by those who must count on a sealant which may be used in all weather conditions to carry out provisional or permanent sealing work.



Colour				
Black				