



MAPEI SOLUTIONS FOR YOUR WORK



MAPEI SOLUTIONS FOR YOUR WORK

WHATEVER YOUR PROJECT,
MAKE MAPEI PRODUCTS PART OF THE TEAM.

EFFECTIVE, INNOVATIVE AND EASY TO USE, THEY ENABLE
YOU TO COMPLETE ANY PROJECT, WHATEVER THE
CONDITIONS, IN THE BEST WAY POSSIBLE.

**WITH MAPEI THERE IS ALWAYS THE SOLUTION TO SUIT
YOU, SUSTAINABLE AND DURABLE OVER THE YEARS.**

الكتيب متاح أيضًا باللغة العربية في الصفحة com.mapei.solutions

Documentul este disponibil în **limba Română** la pagina solutions.mapei.com

Dokumenti gjendet edhe në **gjuhën shqipe** në faqen solutions.mapei.com

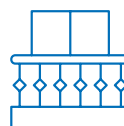

Infiltrations
on balconies
and terraces



Damaged
façades



Floors and
walls
materials

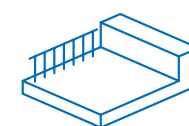

Damaged
roofs



Rising damp



Damp and
infiltrations in
underground areas



Mould in internal
environments



Thermal
insulation

For further information please consult our website mapei.it
or send an email to assistenza@mapei.it

PROBLEMS WITH INFILTRATIONS ON BALCONIES AND TERRACES?

SYSTEM FOR WATERPROOFING NEW BALCONIES WITH ONE-COMPONENT CEMENTITIOUS PRODUCTS FOLLOWED BY THE INSTALLATION OF TILES

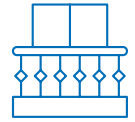

- 1 Clean, dry, mechanical resistant cementitious substrate
- 2 Self-adhesive butyl tape **MAPEBAND SA**
- 3 One-component waterproofing cementitious mortar **MONOLASTIC** - 1st coat
- 4 Fibre glass reinforcing mesh **MAPENET 150**
- 5 One-component waterproofing cementitious mortar **MONOLASTIC** - 2nd coat
- 6 Adhesive **KERAFLEX MAXI SI ZERO**
- 7 Tiles
- 8 Grout **ULTRACOLOR PLUS**
- 9 Sealant **MAPEFOAM + MAPESIL AC**

APPLICATION STEPS

- 1 The cementitious substrate must be clean, dry and mechanically strong. Seal any existing cracks with **Eporip** fluid epoxy resin for sealing cracks.
- 2 **MAPEBAND SA**
Cut the tape to the length required, remove the protective backing and apply the tape making sure it adheres firmly to the substrate.
- 3 **MONOLASTIC** – 1st coat
Apply the product with a notched trowel.
- 4 **MAPENET 150**
Unroll the glass fibre reinforcing mesh and place it on the first coat of **Monolastic** while still fresh.
- 5 **MONOLASTIC** – 2nd coat
Apply the product with a smooth trowel.
- 6 **KERAFLEX MAXI SI ZERO**
Apply the adhesive using the double-buttering method with a notched trowel suitable for the type and format of the tiles so that the back of the tiles is sufficiently wetted with adhesive. While installing the tiles use levelling systems from the **MapeLevel** line to maintain the correct width for the grouts and to reduce lippage between adjacent tiles.
- 8 **ULTRACOLOR PLUS**
Once the adhesive has set, carefully fill the grouts to their full depth using a rubber trowel without leaving gaps or steps. When the mix starts to lose its plasticity, clean off any excess product with a damp cellulose sponge. They may also be finished off while the product is partially hardened by going over the surface with a damp abrasive pad (such as a Scotch-Brite® pad).
Remove any cementitious residues with **UltraCare Keranet**.
- 9 **MAPESIL AC**
Seal the perimeter and expansion joints after inserting **Mapefoam** to set the correct depth and then finish off the surface of the sealant with **UltraCare Smooth Silicone**.

PROBLEMS WITH INFILTRATIONS ON BALCONIES AND TERRACES?

RAPID SYSTEM FOR WATERPROOFING NEW TERRACES WITH TWO-COMPONENT CEMENTITIOUS PRODUCTS FOLLOWED BY THE INSTALLATION OF TILES

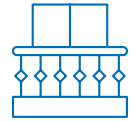

- | | |
|--|--|
| <ul style="list-style-type: none"> 1 Concrete CALCESTRUZZO RCK40 2 Bonding promoter EPORIP 3 Screed TOPCEM PRONTO 4 Cementitious waterproofer - 1st coat MAPELASTIC TURBO 5 Rubber tape MAPEBAND EASY 6 Epoxy adhesive ADESILEX PG4 broadcast with QUARTZ 0.5 7 Wall drain DRAIN FRONT 8 Rubber tape MAPETEX SEL N 9 Cementitious waterproofer - 2nd coat MAPELASTIC TURBO | <ul style="list-style-type: none"> 10 Adhesive ULTRALITE S1 FLEX QUICK 11 Ceramic tiles 12 Grout ULTRACOLOR PLUS 13 Sealant MAPEFOAM + MAPESIL AC |
|--|--|

APPLICATION STEPS

- 2 EPORIP**
Apply the product with a brush or trowel between second pours to create a bonded screed.
- 3 TOPCEM PRONTO**
Create a sloping screed; position a series of levelling guides, spread the mix, carefully compact the mix and float-finish the surface.
- 4 MAPELASTIC TURBO – 1st coat**
Apply the first layer of product with a notched trowel.
- 5 MAPEBAND EASY**
Apply the elastic tape for fillets and joints on **Mapelastic Turbo** while still fresh.
- 6 ADESILEX PG4 + QUARTZ 0.5**
Apply a first layer of product with a smooth trowel.
- 7 DRAIN FRONT**
While **Adesilex PG4** is still fresh, insert the wall drain and finish off with a second coat of **Adesilex PG4**, broadcasting the product with **Quartz 0.5**.
- 8 MAPETEX SEL N**
Spread the reinforcing mesh on the first layer of **Mapelastic Turbo** while still fresh and finish off with the smooth edge of a trowel.
- 9 MAPELASTIC TURBO – 2nd coat**
Apply a second coat of product with a smooth trowel to cover the mesh. The final thickness must be at least 2 mm.
- 10 ULTRALITE S1 FLEX QUICK**
Apply the adhesive using the double-buttering method with a notched trowel suitable for the type and format of the tiles so that the back of the tiles is sufficiently wetted with adhesive. While installing the tiles use levelling systems from the **MapeLevel** line to maintain the correct width for the grouts and to reduce lippage between adjacent tiles.
- 12 ULTRACOLOR PLUS**
Once the adhesive has set, carefully fill the grouts to their full depth using a rubber trowel without leaving gaps or steps. When the mix starts to lose its plasticity, clean off any excess product with a damp cellulose sponge. They may also be finished off while the product is partially hardened by going over the surface with a damp abrasive pad (such as a Scotch-Brite® pad). Remove any cementitious residues with **UltraCare Keranet**.
- 13 MAPESIL AC**
Seal the perimeter and expansion joints after inserting **Mapefoam** to set the correct depth and then finish off the surface of the sealant with **UltraCare Smooth Silicone**.

PROBLEMS WITH INFILTRATIONS ON BALCONIES AND TERRACES?

SYSTEM FOR WATERPROOFING AND INSTALLING CERAMIC TILES ON TERRACES AND BALCONIES WITH A WATERPROOFING, UNCOUPLING AND ANTI-FRACTURE MEMBRANE

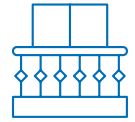

APPLICATION STEPS

- 2 TOPCEM PRONTO**
Create a 40 to 80 mm thick sloping screed. Position a series of levelling guides, spread the mix, carefully compact the mix and float-finish the surface.
- 3 KERAFLEX MAXI S1 ZERO**
Spread the adhesive on the screed with a No. 5 notched trowel to bond the membrane.
- 4 MAPEGUARD UM 35**
Place the membrane on the adhesive while still fresh and press down firmly on the surface with a float or a **Mapeguard Roller**.
- 5 MAPEGUARD WP ADHESIVE**
Spread the adhesive with a 3 mm notched trowel.
- 6 MAPEBAND EASY**
Apply the tape to waterproof the joints between the adjacent membranes and all the corners and edges between the membrane and perimeter walls.
- 7 KERAFLEX MAXI S1 ZERO**
Apply the adhesive using the double-buttering method with a notched trowel suitable for the type and format of the tiles so that the back of the tiles is sufficiently wetted with adhesive. While installing the tiles use levelling systems from the **MapeLevel** line to maintain the correct width for the grouts and to reduce lippage between adjacent tiles.
- 9 ULTRACOLOR PLUS**
Once the adhesive has set, carefully fill the grouts to their full depth using a rubber trowel without leaving gaps or steps. When the mix starts to lose its plasticity, clean off any excess product with a damp cellulose sponge. They may also be finished off while the product is partially hardened by going over the surface with a damp abrasive pad (such as a Scotch-Brite® pad). Remove any cementitious residues with **UltraCare Keranet**.
- 10 MAPEFIL AC**
Seal the perimeter and expansion joints after inserting **Mapefoam** to set the correct depth and then finish off the surface of the sealant with **UltraCare Smooth Silicone**.

- 1** Damp proofing membrane
- 2** Cementitious screed **TOPCEM PRONTO**
- 3** Adhesive **KERAFLEX MAXI S1 ZERO**
- 4** Waterproofing, uncoupling and anti-fracture membrane **MAPEGUARD UM 35**
- 5** Adhesive **MAPEGUARD WP ADHESIVE**
- 6** Rubber tape **MAPEBAND EASY**
- 7** Adhesive **KERAFLEX MAXI S1 ZERO**
- 8** Ceramic tiles
- 9** Grout **ULTRACOLOR PLUS**
- 10** Sealant **MAPEFOAM + MAPEFIL AC**

PROBLEMS WITH INFILTRATIONS ON BALCONIES AND TERRACES?

SYSTEM FOR WATERPROOFING FLAT ROOFS AND TERRACES AND INSTALLING CERAMIC TILES OVER EXISTING FLOORING

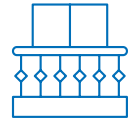

- | | |
|--|---|
| <p>1 Existing flooring, cleaning with ULTRACARE HD CLEANER</p> <p>2 Levelling compound PLANITOP FAST 330</p> <p>3 Cementitious waterproofer MAPELASTIC ZERO</p> <p>4 Floor drain DRAIN VERTICAL</p> <p>5 Glass fibre mesh MAPENET 150</p> <p>6 Rubber tape MAPEBAND EASY</p> <p>7 Cementitious waterproofer MAPELASTIC ZERO</p> <p>8 Adhesive KERAFLEX EXTRA S1 ZERO</p> <p>9 Tiles</p> | <p>10 Grout ULTRACOLOR PLUS</p> <p>11 Sealant MAPEFLEX PU 45 FT</p> <p>12 Sealant MAPEFOAM + MAPESIL AC</p> |
|--|---|

APPLICATION STEPS

- 1 ULTRACARE HD CLEANER**
The existing flooring must be firmly bonded and clean. Clean the surface with **UltraCare HD Cleaner** diluted 1:5 or 1:10 with water according to the level of cleanliness required.
- 2 PLANITOP FAST 330**
Prior to applying the product with a trowel to skim the surface and create the required slope.
- 3 MAPELASTIC ZERO - 1st coat**
Apply the first coat of product with a notched trowel.
- 4 DRAIN VERTICAL**
Insert the vertical drain in the water outlet pipe and press the fabric panel onto **Mapelastico ZERO** with a smooth trowel.
- 5 MAPENET 150**
Unroll the reinforcing mesh and place it on the first layer of **Mapelastico ZERO** while still fresh.
- 6 MAPEBAND EASY**
Apply the elastic tape for fillets and joints on **Mapelastico ZERO** while still fresh.
- 7 MAPELASTIC ZERO - 2nd coat**
Apply a second layer of product with a smooth trowel to cover the reinforcing mesh. The final thickness must be at least 2 mm.
- 8 KERAFLEX EXTRA S1 ZERO**
Apply the adhesive using the double-buttering method with a notched trowel suitable for the type and format of the tiles so that the back of the tiles is sufficiently wetted with adhesive. While installing the tiles use levelling systems from the **MapeLevel** line to maintain the correct width for the grouts and to reduce lippage between adjacent tiles.
- 10 ULTRACOLOR PLUS**
Once the adhesive has set, carefully fill the grouts to their full depth using a rubber trowel without leaving gaps or steps. When the mix starts to lose its plasticity, clean off any excess product with a damp cellulose sponge. They may also be finished off while the product is partially hardened by going over the surface with a damp abrasive pad (such as a Scotch-Brite® pad). Remove any cementitious residues with **UltraCare Keranet**.
- 11 MAPEFLEX PU 45 FT**
Seal all expansion and distribution joints after inserting **Mapefoam** to set the correct depth.
- 12 MAPESIL AC**
Seal the perimeter and expansion joints after inserting **Mapefoam** to set the correct depth and then finish off the surface of the sealant with **UltraCare Smooth Silicone**.

PROBLEMS WITH INFILTRATIONS ON BALCONIES AND TERRACES?

SYSTEM FOR WATERPROOFING EXISTING BALCONIES AND TERRACES WITH TWO-COMPONENT CEMENTITIOUS PRODUCTS FOLLOWED BY THE INSTALLATION OF TILES

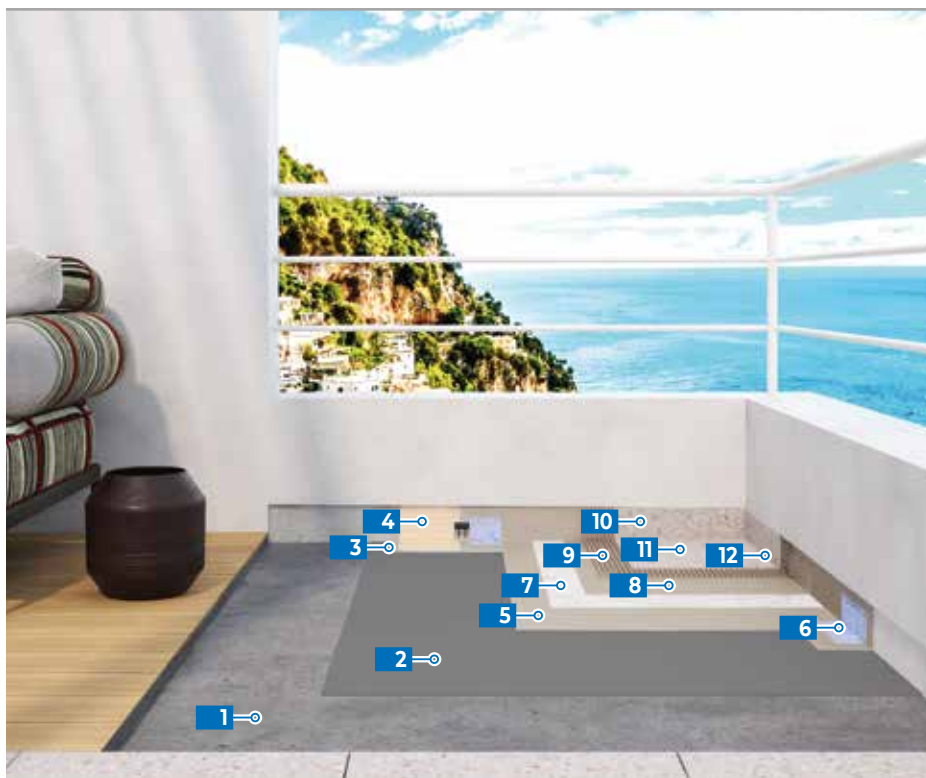
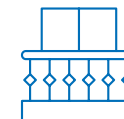

- 1** Clean, dry, mechanically resistant existing cementitious substrate
- 2** Levelling mortar **PLANITOP FAST 330**
- 3** Structural adhesive **ADESILEX PG4 + QUARTZ 0.5**
- 4** Wall drain **DRAIN FRONT**
- 5** Waterproofer **MAPELASTIC TURBO** 1st coat
- 6** Tape **MAPEBAND EASY**
- 7** Reinforcing mesh **MAPETEX SEL N**
- 8** Waterproofer **MAPELASTIC TURBO** 2nd coat

- 9** Adhesive **KERAFLEX MAXI S1 ZERO**
- 10** Exterior covering
- 11** Grout **ULTRACOLOR PLUS**
- 12** Sealant **MAPEFOAM + MAPESIL AC**

APPLICATION STEPS

- 1** The cementitious substrate must be clean, dry and mechanically strong. Seal any existing cracks with **Eporip** fluid epoxy resin for sealing cracks.
- 2** **PLANITOP FAST 330**
Level off the surface and restore the correct slope by applying the product with a long metal trowel.
- 3** **ADESILEX PG4 + QUARTZ 0.5**
Apply a first coat of product with a smooth trowel.
- 4** **DRAIN FRONT**
While the **Adesilex PG4** is still fresh, insert the wall drain and finish off with a second coat of **Adesilex PG4**, broadcasting the product with **Quartz 0.5**.
- 5** **MAPELASTIC TURBO** – 1st coat
Apply the first coat of product with a notched trowel.
- 6** **MAPEBAND EASY**
Apply the elastic tape for fillets and joints on **Mapelastico Turbo** while still fresh.
- 7** **MAPETEX SEL N**
Spread the reinforcing mesh on the first coat of **Mapelastico Turbo** while still fresh and finish off with the smooth edge of a trowel.
- 8** **MAPELASTIC TURBO** – 2nd coat
Apply a second coat of product with a smooth trowel to cover the mesh. The final thickness must be at least 2 mm.
- 9** **KERAFLEX MAXI S1 ZERO**
Apply the adhesive using the double-buttering method with a notched trowel suitable for the type and format of the tiles so that the back of the tiles is sufficiently wetted with adhesive. While installing the tiles use levelling systems from the **MapeLevel** line to maintain the correct width for the grouts and to reduce lippage between adjacent tiles.
- 11** **ULTRACOLOR PLUS**
Once the adhesive has set, carefully fill the grouts to their full depth using a rubber trowel without leaving gaps or steps. When the mix starts to lose its plasticity, clean off any excess product with a damp cellulose sponge. They may also be finished off while the product is partially hardened by going over the surface with a damp abrasive pad (such as a Scotch-Brite® pad). Remove any cementitious residues with **UltraCare Keranet**.
- 12** **MAPESIL AC**
Seal the perimeter and expansion joints after inserting **Mapefoam** to set the correct depth and then finish off the surface of the sealant with **UltraCare Smooth Silicone**.



APPLICATION STEPS

- 1 MAPEWALL RENDER & STRENGTHEN**
Apply the product with a trowel or rendering machine with metal mesh embedded in the product fastened to the load-bearing substrate; the maximum total thickness should be 30 mm.
- 2 ULTRALITE S2 FLEX**
Apply the adhesive using the double-buttering method with a notched trowel suitable for the type and format of the tiles so that the back of the tiles is sufficiently wetted with adhesive. While installing the tiles use levelling systems from the **MapeLevel** line to maintain the correct width for the grouts and to reduce lippage between adjacent tiles.
- 4 ULTRACOLOR PLUS**
Once the adhesive has set, carefully fill the grouts to their full depth using a rubber trowel without leaving gaps or steps. When the mix starts to lose its plasticity, clean off any excess product with a damp cellulose sponge. They may also be finished off while the product is partially hardened by going over the surface with a damp abrasive pad (such as a Scotch-Brite® pad). Remove any cementitious residues with **UltraCare Keranet**.
- 5 MAPESIL LM**
Seal the corners, edges and expansion joints after inserting **Mapefoam** to set the correct depth and then finish off the surface of the sealant with **UltraCare Smooth Silicone**.

- 1** Render **MAPEWALL RENDER & STRENGTHEN**
- 2** Adhesive **ULTRALITE S2 FLEX**
- 3** Ceramic tiles
- 4** Grout **ULTRACOLOR PLUS**
- 5** Sealant for window frame and stringer **MAPEFOAM + MAPESIL LM**

SYSTEM FOR INSTALLING CERAMIC TILES ON FAÇADES WITH FIBRE-CEMENT PANELS

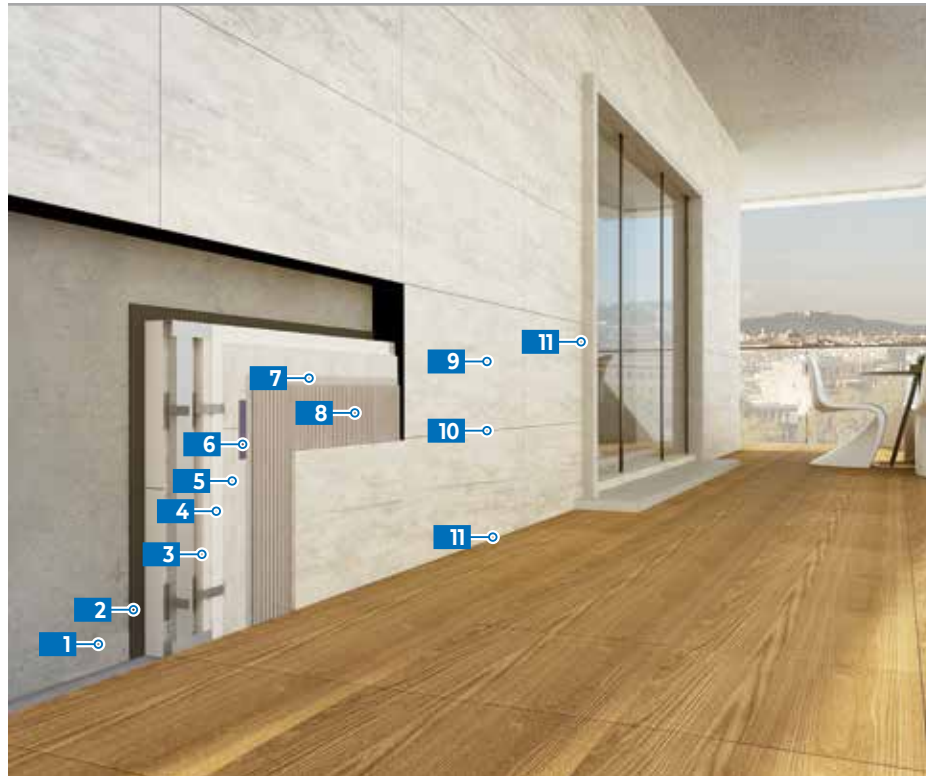

- 1** Concrete wall
- 2** Adhesive
- 3** Polystyrene panel
- 4** Isolating sheet
- 5** Fibre-cement panel
- 6** Reinforced skimming mortar **MONOFINISH /**
- 7** **MAPEFINISH + MAPENET 150**
- 8** Adhesive **ULTRALITE S2 FLEX**
- 9** Ceramic tiles
- 10** Grout **ULTRACOLOR PLUS**
- 11** Sealant **MAPEFOAM + MAPESIL LM**

APPLICATION STEPS

- 1** The concrete must be clean, dry and mechanically strong. Any irregular areas in the surface may be levelled off with **Planitop Fast 330**.
- 6-7** **MONOFINISH/MAPEFINISH + MAPENET 150**
Skim the panels with **Monofinish** applied in two coats with a smooth trowel (total thickness of the two coats around 3-4 mm) or **Mapefinish**. Embed **Mapenet 150** mesh between the first and second coat in correspondence with the joints between the panels.
- 8** **ULTRALITE S2 FLEX**
Apply the adhesive using the double-buttering technique with a suitable notched trowel, according to the type and format of the tiles, to make sure the backs of the tiles are sufficiently wetted. While installing the tiles use levelling systems from the **MapeLevel** line to maintain the correct width for the grouts and to reduce lippage between adjacent tiles.
- 10** **ULTRACOLOR PLUS**
Once the adhesive has set, carefully fill the grouts to their full depth using a rubber trowel without leaving gaps or steps. When the mix starts to lose its plasticity, clean off any excess product with a damp cellulose sponge. They may also be finished off while the product is partially hardened by going over the surface with a damp abrasive pad (such as a Scotch-Brite® pad). Remove any cementitious residues with **UltraCare Keranet**.
- 11** **MAPESIL LM**
Seal the corners, edges and expansion joints after inserting **Mapefoam** to set the correct depth and then finish off the surface of the sealant with **UltraCare Smooth Silicone**.

PROBLEMS WITH A DAMAGED FAÇADE?

SYSTEM FOR QUICKLY RESTORING AND PROTECTING THE FRONT EDGE OF BALCONIES AND REINFORCED CONCRETE ELEMENTS



APPLICATION STEPS

- 2** **MAPEFER 1K ZERO**
Thoroughly brush the area and apply two coats of product with a brush to form a protective, anti-corrosion and re-alkalising layer at least 2 mm thick for the reinforcement rods.
- 3a** **PLANITOP SMOOTH&REPAIR ZERO**
Apply the non-structural mortar with a trowel in a layer 3 to 40 mm thick to reintegrate and skim the concrete; no formwork required.
- 3b** **PLANITOP SMOOTH&REPAIR R4 ZERO**
Apply the structural mortar with a trowel in a layer 3 to 40 mm thick to reintegrate and skim the concrete; no formwork required.
- 4** **MALECH**
Apply the product with a brush or roller to even out the surface and promote adhesion of the successive coat of paint.
- 5** **ELASTOCOLOR PAINT ZERO**
Once the primer is dry, apply 2 coats of paint with a brush or roller to completely cover the surface.

- 1** Concrete
- 2** Rod passivating mortar **MAPEFER 1K ZERO**
- 3a** Repairing mortar **PLANITOP SMOOTH & RAPAIR ZERO**
- 3b** Repairing mortar **PLANITOP SMOOTH & RAPAIR R4 ZERO**
- 4** Acrylic primer **MALECH**
- 5** Hygienising, crack-bridging elastomeric paint **ELASTOCOLOR PAINT ZERO**

PROBLEMS WITH A DAMAGED FAÇADE?

SYSTEM FOR RESTORING AND PROTECTING THE FRONT EDGE OF BALCONIES AND REINFORCED CONCRETE ELEMENTS WITH A HIGH LEVEL OF CORROSION



APPLICATION STEPS

- 1 Completely remove all the areas of concrete at risk of becoming detached by mechanical means and remove all rust from the steel reinforcement.
- 2 **MAPEGROUT 430 ZERO**
Apply the fine-textured mortar for restoring concrete with a trowel; no formwork required.
- 3 **MAPESHIELD CORROSION CONTROL**
Apply the zinc plate along the structure and pass over it with a rubber roller so that it adheres perfectly to the surface. Connect the electric cables prepared previously to the anode plate with a mechanical fastener.
- 4 **MAPEFLEX MS 45**
Seal the terminals of the plate and any joints after treating the edges with **Primer FD**.
- 5 **PLANITOP 200 + MAPENET 150 + PLANITOP 200**
Apply two coats of skimming compound with a metal trowel with the alkali-resistant glass fibre mesh embedded between the 1st and 2nd coat.
- 6
- 7
- 8 **MALECH**
Apply the product with a brush or roller to even out the surface and promote adhesion of the successive coat of paint.
- 9 **ELASTOCOLOR PAINT ZERO**
Once the primer is dry, apply 2 coats of paint with a brush or roller to completely cover the surface.

- 1 Concrete
- 2 Repairing mortar **MAPEGROUT 430 ZERO**
- 3 External sacrificial anode **MAPESHIELD CORROSION CONTROL**
- 4 Elastic sealant **PRIMER FD + MAPEFLEX MS 45**
- 5 Cementitious skimming mortar **PLANITOP 200**
- 6 Glass fibre mesh **MAPENET 150**
- 7 Skimming mortar **PLANITOP 200**
- 8 Acrylic primer **MALECH**
- 9 Hygienising, crack-bridging elastomeric paint **ELASTOCOLOR PAINT ZERO**

SYSTEM FOR STRUCTURALLY RESTORING CONCRETE BY APPLYING HI-FLOW MORTAR POURED INTO FORMWORK



APPLICATION STEPS

- 1** Completely remove all the areas of concrete at risk of becoming detached by mechanical means and remove all rust from the steel reinforcement.
- 2** **MAPEFER 1K ZERO**
Thoroughly brush the steel bar and apply two coats of product with a brush to form a protective, anti-corrosion and re-alkalising layer at least 2 mm thick for the reinforcement rods.
- 3** **MAPEGROUT HI-FLOW ZERO**
Pour the mortar in a constant flow from one side only into the formwork, making sure that all the air is expelled. There is no need to vibrate the mortar after pouring.
- 4** **MALECH**
Apply the product with a brush, roller or by spray to even out the surface and promote adhesion of the successive coat of paint.
- 5** **ELASTOCOLOR PAINT ZERO**
Once the primer is dry, apply the paint with a brush, roller or by spray. When applying with a brush or roller, 2 coats are required to ensure complete, effective hiding.

- 1** Concrete
- 2** Rebar passivating mortar **MAPEFER 1K ZERO**
- 3** Repairing mortar **MAPEGROUT HI-FLOW ZERO**
- 4** Acrylic primer **MALECH**
- 5** Hygienising, crack-bridging elastomeric paint **ELASTOCOLOR PAINT ZERO**

SYSTEM FOR STRUCTURALLY RESTORING CONCRETE BY APPLYING THIXOTROPIC MORTAR WITHOUT FORMWORK



APPLICATION STEPS

- 1** Completely remove all the areas of concrete at risk of becoming detached by mechanical means and remove all rust from the steel reinforcement.
- 2** **MAPEFER 1K ZERO**
Thoroughly brush the steel bar and apply two coats of product with a brush to form a protective, anti-corrosion and re-alkalising layer at least 2 mm thick for the reinforcement rods.
- 3** **MAPEGROUT EASY REPAIR ZERO**
Apply a layer of the thixotropic mortar up to 5 cm thick with a trowel. Alternatively, apply the mortar by spray using a continuous-mix rendering machine.
- 4** **MALECH**
Apply the product with a brush, roller or by spray to even out the surface and promote adhesion of the successive coat of paint.
- 5** **COLORITE PERFORMANCE**
Once the primer is dry, apply 2 coats of product with a brush, roller or by spray.

- 1** Concrete
- 2** Rebar passivating mortar **MAPEFER 1K ZERO**
- 3** Repairing mortar **MAPEGROUT EASY REPAIR ZERO**
- 4** Acrylic primer **MALECH**
- 5** Protective acrylic paint **COLORITE PERFORMANCE**

SYSTEM FOR SKIMMING MORTAR BY APPLYING FINE-TEXTURED CEMENTITIOUS MORTAR

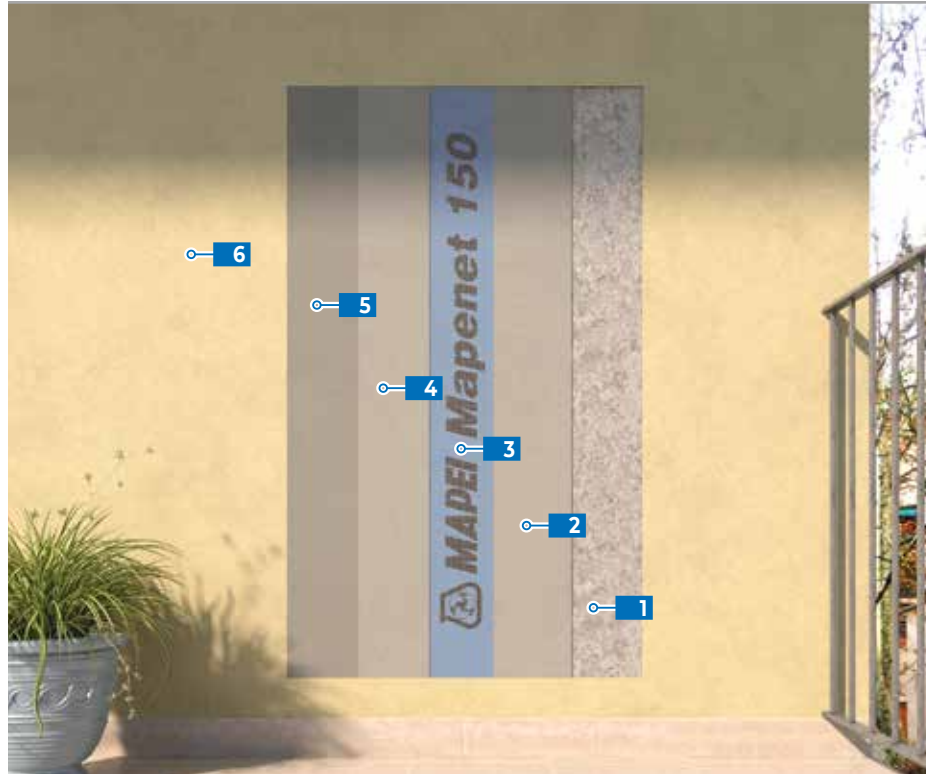

APPLICATION STEPS

- 1** The concrete must be clean, dry and mechanically strong.
- PLANITOP 210**
2 Apply the first coat on the sound, clean and dampened substrate with a flat trowel.
- MAPENET 150**
3 Place the mesh on the first coat of the skimming mortar while still fresh and press it down with a metal trowel into the mortar.
- PLANITOP 210**
4 Apply the second coat with a flat metal trowel so that it completely covers the mesh.
- MALECH**
5 Apply the product with a brush, roller or by spray to even out the surface and promote adhesion of the successive coat of paint.
- QUARZOLITE PAINT**
6 Once the primer is dry apply the paint with a brush, roller or by spray. 2 coats are required to ensure complete, effective hiding.

- 1** Concrete
- 2** Water-repellent cementitious skimming mortar **PLANITOP 210** - 1st coat
- 3** Glass fibre reinforcing mesh **MAPENET 150**
- 4** Water-repellent cementitious skimming mortar **PLANITOP 210** - 2nd coat
- 5** Acrylic primer **MALECH**
- 6** Quartz acrylic paint **QUARZOLITE PAINT**

PROBLEMS WITH A DAMAGED FAÇADE?

SYSTEM FOR LEVELLING OFF RENDERED, PAINTED OR PLASTIC-COATED SUBSTRATES BY APPLYING WHITE FIBRE-REINFORCED SKIMMING MORTAR



APPLICATION STEPS

- 1 The plastic coating must be well bonded to the substrate and have no cracks or blisters.
- 2 **PLANITOP RASO MAX**
Apply the first coat on the sound, clean and dampened substrate with a flat trowel.
- 3 **MAPENET 150**
Place the mesh on the first coat of the skim coating mortar while still fresh and press it down with a metal trowel into the mortar.
- 4 **PLANITOP RASO MAX**
Apply the second coat with a flat metal trowel so that it completely covers the mesh.
- 5 **SILANCOLOR PRIMER**
Apply the product with a brush, roller or by spray to even out the surface and promote adhesion of the successive coat of paint.
- 6 **SILANCOLOR PAINT ZERO**
Once the primer is dry apply the paint with a brush, roller or spray. 2 coats are required to ensure complete, effective hiding.

- 1 Existing plastic-coated substrate
- 2 White fibre-reinforced lime-cement water-repellent skim coating mortar **PLANITOP RASO MAX** - 1st coat
- 3 Glass fibre reinforcing mesh **MAPENET 150**
- 4 White fibre-reinforced lime-cement water-repellent skim coating mortar **PLANITOP RASO MAX** - 2nd coat
- 5 Siloxane primer **SILANCOLOR PRIMER**
- 6 Siloxane hygienising paint **SILANCOLOR PAINT ZERO**

ANCHORING METAL ELEMENTS IN CONCRETE STRUCTURES



APPLICATION STEPS

1 MAPEFILL ZERO

Pour the mortar in a constant flow from one side only to eliminate any air from the area to be filled, which must be at least 2 times bigger than the diameter of the bar to be anchored.

1 Anchoring mortar **MAPEFILL ZERO**

CRM SYSTEM FOR CONSOLIDATING WEAK MASONRY BY APPLYING NATURAL HYDRAULIC LIME-BASED "REINFORCED" STRUCTURAL RENDER



APPLICATION STEPS

- 1 The existing masonry must be clean and free of any material or element at risk of becoming detached.
- 2 **MAPEWALL RENDER & STRENGTHEN**
Apply a first layer of product 1.5 cm thick with a trowel or rendering machine.
- 3 **MAPENET EM 40 or MAPENET EM 30**
Place the mesh on the mortar and press it down lightly with a flat trowel so that it adheres perfectly to the mortar.
- 4 **MAPENET EM CONNECTOR**
Position the connectors with **Mapefix VE SF** in the holes drilled previously.
- 5 **MAPEWALL RENDER & STRENGTHEN**
Apply a second layer of product 1.5 cm thick with a trowel or rendering machine so that it completely covers the mesh and connectors.
- 6 **PLANITOP 510**
Apply the product to create a lime-based breathable skim coat.
- 7 **SILANCOLOR PRIMER**
Apply the primer with a brush, roller or by spray.
- 8 **SILANCOLOR PAINT ZERO**
Apply 2 coats of paint with a brush, roller or by spray.

- 1 Existing masonry
- 2 Fibre-reinforced mortar **MAPEWALL RENDER & STRENGTHEN**
- 3 Pre-impregnated alkali-resistant A.R. glass fibre mesh (FRP) **MAPENET EM 40 or MAPENET EM 30**
- 4 Connector **MAPENET EM CONNECTOR**
Chemical anchor **MAPEFIX VE SF**
- 5 Fibre-reinforced mortar **MAPEWALL RENDER & STRENGTHEN**
- 6 Breathable skimming mortar **PLANITOP 510**
- 7 Siloxane undercoat **SILANCOLOR PRIMER**
- 8 Siloxane hygienising paint **SILANCOLOR PAINT ZERO**

PROBLEMS WITH A DAMAGED FAÇADE?

CEMENT-FREE PURE HYDRAULIC LIME-BASED SKIMMING AND RENDERING SYSTEM FOR LEVELLING OFF AND RESTORING MASONRY, INCLUDING MASONRY WITH OLD PAINTWORK



APPLICATION STEPS

- 1** Thoroughly clean the masonry by hydro-blasting to remove any crumbling areas or areas at risk of becoming detached, and any salt from the surface or trapped in the masonry itself. To patch up any areas or elements that have become detached use **Mape-Antique NHL Eco Restaura**.
- 2** **MAPE-ANTIQUE NHL ECO RESTAURA**
Apply the breathable render in layers up to 30 mm thick with a trowel or rendering machine.
- 3** **MAPE-ANTIQUE NHL ECO RESTAURA**
Apply the breathable skimming mortar in layers 3 to 30 mm thick with a flat trowel, including on old paintwork.
- 4** **MAPE-ANTIQUE NHL ECO RESTAURA**
Stitch, point and rebuild masonry with the breathable masonry mortar.
- 5** **MAPE-ANTIQUE NHL ECO RESTAURA**
Create and rebuild construction elements and features with the breathable masonry mortar.
- 6** **SILEXCOLOR PRIMER**
Apply the primer with a brush, roller or by spray.
- 7** **SILEXCOLOR PAINT**
Apply 2 coats of paint with a brush, roller or by spray.

- 1** Existing masonry
- 2** Breathable render **MAPE-ANTIQUE NHL ECO RESTAURA**
- 3** Breathable skimming mortar **MAPE-ANTIQUE NHL ECO RESTAURA**
- 4** Breathable masonry mortar **MAPE-ANTIQUE NHL ECO RESTAURA**
- 5** Breathable masonry mortar **MAPE-ANTIQUE NHL ECO RESTAURA**
- 6** Silicate undercoat **SILEXCOLOR PRIMER**
- 7** Silicate paint **SILEXCOLOR PAINT**

SYSTEM FOR PROTECTING EXISTING BUILDINGS IN THE EVENT OF EARTHQUAKES
BY APPLYING AN ELASTOMERIC FINISH ON FAÇADE WALLS



APPLICATION STEPS

- 1 Remove the paint from the substrate down to the level of the existing render.
- 2 **MAPEWRAP EQ ADHESIVE**
Apply a first, even layer with a brush or roller. Please refer to the **MapeWrap EQ System** data sheet.
- 3 **MAPEWRAP EQ NET**
Place the fabric in position, making sure there are no creases by going over the surface with a **MapeWrap Roller**, so that the adhesive completely penetrates through the fibres of the fabric.
- 4 **MAPEWRAP EQ ADHESIVE**
Apply the second coat while the first coat is still fresh. Use a **MapeWrap Roller** to remove any air bubbles.
- 5 **PLANITOP 200**
Apply and spread the skimming mortar with a smooth metal trowel.
- 6 **MALECH**
Apply the product with a brush or roller to even out the surface and to promote adhesion of the successive coat of paint.
- 7 **ELASTOCOLOR PAINT ZERO**
Once the primer is dry, apply at least 2 coats of paint with a brush, roller or by spray to completely cover the surface.

- 1 Render with removal of existing paint
- 2 One-component ready-mixed water-based adhesive in polyurethane dispersion
MAPEWRAP EQ ADHESIVE
- 3 Primed bi-directional glass fibre fabric
MAPEWRAP EQ NET
- 4 One-component ready-mixed waterbased adhesive **MAPEWRAP EQ ADHESIVE**
- 5 Cementitious skimming mortar **PLANITOP 200**
- 6 Acrylic primer **MALECH**
- 7 Hygienising, crack-bridging elastomeric paint
ELASTOCOLOR PAINT ZERO

SYSTEM FOR WATERPROOFING AND INSTALLING CERAMIC TILES OR MOSAIC IN DAMP ENVIRONMENTS ON A WATERPROOFING AND ANTI-FRACTURE MEMBRANE



- 1** Cementitious screed
- 2** Cementitious adhesive **ULTRALITE S1 FLEX ZERO**
- 3** Alkali-resistant waterproofing and anti-fracture membrane **MAPEGUARD WP 200**
- 4** Quick-drying, two-component, elastic cementitious adhesive **MAPEGUARD WP ADHESIVE**
- 5** Waterproofing band **MAPEGUARD ST**
- 6** Waterproofing internal corner **MAPEGUARD IC**
- 7** Waterproofing membrane for through pipes and drains **MAPEGUARD PC**
- 8** Cementitious adhesive **ULTRALITE S1 FLEX ZERO**
- 9** Glass mosaic
- 10** Epoxy grout **KERAPOXY EASY DESIGN**
- 11** Elastic sealant **MAPEFOAM + MAPESIL AC**

APPLICATION STEPS

- 1** The cementitious screed must be clean, dry and mechanically strong.
- 2** **ULTRALITE S1 FLEX ZERO**
Apply the adhesive on the substrate with a 3-4 mm notched trowel to bond the membrane to the substrate.
- 3** **MAPEGUARD WP 200**
Apply the membrane on the adhesive while still fresh and press down evenly with a roller, working from the centre to the edges.
- 4** **MAPEGUARD WP ADHESIVE**
Apply the adhesive with a No. 3 notched trowel to bond all the waterproofing accessories to the membrane.
- 5** **MAPEGUARD ST**
Seal all the corners between the wall and floor and between adjacent pieces of membrane with the tape.
- 6** **MAPEGUARD IC**
Waterproof the internal and external corners with **Mapeguard IC** and **Mapeguard EC**, respectively.
- 7** **MAPEGUARD PC**
Bond the seals in place with **Mapeguard WP Adhesive** to waterproof the through pipework and drains.
- 8** **ULTRALITE S1 FLEX ZERO**
Apply the adhesive on the substrate with a notched trowel suitable for the type and format of the tiles to ensure the back of the tiles is sufficiently wetted. Use the double-buttering method where specified by UNI 11493-1. While installing the tiles use levelling systems from the **MapeLevel** line to maintain the correct width for the grouts and to reduce lippage between adjacent tiles.
- 9** **KERAPOXY EASY DESIGN**
Once the adhesive has set, carefully fill the grouts to their full depth using a rubber trowel without leaving gaps or steps. After filling the grouts with epoxy mortar clean the surface while the mortar is still wet fresh with a cellulose sponge dipped in water and a Scotch-Brite® pad where required. Carry out any final cleaning required using **UltraCare Kerapoxy Cleaner**.
- 10** **MAPESIL AC**
Seal the perimeter and expansion joints after inserting **Mapefoam** to set the correct depth and then finish off the surface of the sealant with **UltraCare Smooth Silicone**.

SYSTEM FOR INSTALLING CERAMIC TILES IN DAMP ENVIRONMENTS ON WATERPROOFING MULTIPURPOSE PANELS



- 1** Waterproofing multipurpose panels **MAPEGUARD BOARD**
- 2** Hybrid sealant **MAPEFLEX MS45**
- 3** Adhesive **ULTRALITE S1 FLEX ZERO**
- 4** Porcelain tiles
- 5** Grout **KERAPOXY EASY DESIGN**

APPLICATION STEPS

- 1 MAPEGUARD BOARD**
Cut the panels to the size required with a cutter. Holes and openings for through elements may be created using a drill with a hole-saw bit or with a reciprocating saw.
- 2 MAPEFLEX MS45**
Use this hybrid sealant and mechanical fasteners to assemble the panels to create partitions, sink units and furnishing features.
- 3 ULTRALITE S1 FLEX ZERO**
Apply the adhesive on the substrate with a notched trowel suitable for the type and format of the tiles to ensure the back of the tiles is sufficiently wetted. Use the double-buttering method where specified by UNI 11493-1. While installing the tiles use levelling systems from the **MapeLevel** line to maintain the correct width for the grouts and to reduce lippage between adjacent tiles.
- 5 KERAPOXY EASY DESIGN**
Once the adhesive has set, carefully fill the grouts to their full depth using a rubber trowel without leaving gaps or steps. After filling the grouts with epoxy mortar clean the surface while the mortar is still wet fresh with a cellulose sponge dipped in water and a Scotch-Brite® pad where required. Carry out any final cleaning required using **UltraCare Kerapoxy Cleaner**.

SYSTEM FOR WATERPROOFING AND INSTALLING FLOOR AND WALL COVERINGS WITH READY-TO-USE PRODUCTS IN NEWLY CONSTRUCTED DAMP ENVIRONMENTS



- | | |
|---|--|
| 1 Concrete substrate | 11 Adhesive ULTRAMASTIC III |
| 2 Uncoupling layer | 12 Ceramic tiles |
| 3 Screed TOPCEM PRONTO | 13 Grout KERAPOXY EASY DESIGN |
| 4 Ready-to-use waterproofer MAPEGUM WPS | 14 Sealant MAPEFOAM + MAPESIL Z PLUS |
| 5 Rubber tape MAPEBAND PE 120 | |
| 6 Adhesive KERAFLEX | |
| 7 Ceramic tiles | |
| 8 Grout KERAPOXY EASY DESIGN | |
| 9 Sealant MAPEFOAM + MAPESIL AC | |
| 10 Plasterboard | |

APPLICATION STEPS

- 3 TOPCEM PRONTO**
Position a series of levelling guides, spread the mix, carefully compact the mix and float-finish the surface.
- 4 MAPEGUM WPS**
Apply two layers of product with a trowel, roller or brush to form a total thickness of at least 0.8 mm.
- 5 MAPEBAND PE 120**
Apply the elastic tape for fillet joints on the first layer of **Mapegum WPS** while still fresh.
- 6 KERAFLEX**
Apply the adhesive on the substrate with a notched trowel suitable for the type and format of the tiles to ensure the back of the tiles is sufficiently wetted. Use the double-buttering method where specified by UNI 11493-1. While installing the tiles use levelling systems from the **MapeLevel** line to maintain the correct width for the grouts and to reduce lippage between adjacent tiles.
- 8 13 KERAPOXY EASY DESIGN**
Once the adhesive has set, carefully fill the grouts to their full depth using a rubber trowel without leaving gaps or steps. After filling the grouts with epoxy mortar clean the surface while the mortar is still wet fresh with a cellulose sponge dipped in water and a Scotch-Brite® pad where required. Carry out any final cleaning required using **UltraCare Kerapoxy Cleaner**.
- 9 MAPESIL AC**
Seal the perimeter and expansion joints after inserting **Mapefoam** to set the correct depth and then finish off the surface of the sealant with **UltraCare Smooth Silicone**.
- 11 ULTRAMASTIC III**
Apply the adhesive on the substrate with a notched trowel suitable for the type and format of the tiles to ensure the back of the tiles is sufficiently wetted. Use the double-buttering method where specified in UNI 11493-1. While installing the tiles use levelling systems from the **MapeLevel** line to maintain the correct width for the grouts and to reduce lippage between adjacent tiles.
- 14 MAPESIL Z PLUS**
Seal fillets between sanitary ware and ceramic tiles after inserting **Mapefoam** to set the correct depth. Finish off the surface of the sealant with **UltraCare Smooth Silicone**.

SYSTEM FOR QUICKLY WATERPROOFING AND INSTALLING DECORATIVE WALL COVERINGS AND LVT/SPC IN DAMP ENVIRONMENTS



- 1** Screed **TOPCEM PRONTO**
- 2** Primer **ECO PRIM T PLUS**
- 3** Self-levelling compound **PLANEX HR MAXI**
- 4** Rubber tape **MAPEBAND PE 120**
- 5** Ready-to-use waterproofing membrane **MAPEGUM WPS**
- 6** Adhesive **ULTRABOND ECO MS 4 LVT WALL&FLOOR**
- 7** LVT / SPC
- 8** Finishing **MAPECOAT 4 LVT**
- 9** Sealant **MAPESIL AC**
- 10** Adhesive **ULTRABOND ECO DECOR WET**
- 11** Decorative glass fibre
- 12** Finishing **MAPECOAT DECOR PROTECTION**

APPLICATION STEPS

- 2** **ECO PRIM T PLUS**
Apply the product with a brush or roller. Dilute the product according to the absorbency of the substrate.
- 3** **PLANEX HR MAXI**
Apply a single layer 2 to 20 mm thick with a large metal trowel or rake.
- 4** **MAPEBAND PE120**
Position the tape and relative accessory items in correspondence with expansion joints, fillets between horizontal and vertical surfaces, corners and edges and bond them with **Mapegum WPS**.
- 5** **MAPEGUM WPS/MAPEBAND PE 120**
Apply the product in two, even thin layers (approx. 0.4 mm per layer) with a brush, long-pile roller or trowel. Wait until the first layer is dry before applying the second layer with a trowel crossways to the first one.
- 6** **ULTRABOND ECO MS 4 LVT WALL&FLOOR**
Apply the product with a MAPEI No. 1 or TKB A2 notched trowel (for LVT with an uneven back or not particularly flat, use a MAPEI No. 2 or 3 or TKB B1 trowel).
- 8** **MAPECOAT 4 LVT**
Before applying the product thoroughly clean the surface of the LVT with a red or green **Ultracoat Pad**. After mixing the two components as specified (comp. A : comp. B = 5 : 1 in weight), apply a criss-cross layer of product with a short-pile roller (such as an **Ultracoat Roller T3** or **T5**) or by airless spray.
- 9** **MAPESIL AC**
Apply the one-component acetic silicone sealant in correspondence with expansion joints and joints between the floor and wall.
- 10** **ULTRABOND ECO DECOR WET**
Adhesive supplied ready to use and does not require any preparation. Apply the product with a smooth trowel.
- 12** **MAPECOAT DECOR PROTECTION**
After mixing the two components as specified (comp. A : comp. B = 5 : 1 in weight), apply a criss-cross layer of product with a short-pile roller (such as an **Ultracoat Roller T3** or **T5**).

SYSTEM FOR INSTALLING NATURAL STONE TILES ON A HEATED SCREED WITH HIGH THERMAL CONDUCTIVITY WITH A LAYER OF SOUNDPROOFING AFTER APPLYING AN ISOLATING AND ANTI-FRACTURE MEMBRANE



- | | |
|---|--|
| 1 Concrete substrate | 11 Carrara white marble |
| 2 Vapour barrier | 12 Grout ULTRACOLOR PLUS |
| 3 Soundproofing membrane MAPESILENT ROLL | 13 Sealant MAPEFOAM + MAPESIL LM |
| 4 Soundproofing band MAPESILENT BAND R | |
| 5 Soundproofing tape MAPESILENT TAPE | |
| 6 Heating system | |
| 7 Cementitious screed TOPCEM PRONTO | |
| 8 Adhesive KERAQUICK MAXI S1 | |
| 9 Uncoupling anti-fracture membrane MAPEGUARD UM 35 | |
| 10 Adhesive KERAQUICK MAXI S1 | |

APPLICATION STEPS

- 3 MAPESILENT ROLL**
Apply the sheets on the substrate following the long side of the room. Overlap the sheets by around 5 cm.
- 4 MAPESILENT BAND R**
Apply the soundproofing strip along the bottom of the perimeter walls and around any elements passing through the screed.
- 5 MAPESILENT TAPE**
Seal overlaps between the sheets with the soundproofing tape and press down firmly with a rigid roller.
- 7 TOPCEM PRONTO**
Position a series of levelling guides, spread the mix, carefully compact the mix and float-finish the surface. Minimum thickness over the heating elements: 3 cm; place metal reinforcing mesh at the mid-point or add **Mapefibre ST 30** structural fibres.
- 8 KERAQUICK MAXI S1**
Spread the adhesive on the screed with a No. 5 notched trowel to bond the membrane.
- 9 MAPEGUARD UM 35**
Place the membrane on the adhesive while still fresh and press down firmly on the surface with a float or a **Mapeguard Roller**.
- 10 KERAQUICK MAXI S1**
Apply the adhesive using the double-buttering method with a notched trowel suitable for the type and format of the tiles so that the back of the tiles is sufficiently wetted with adhesive. While installing the tiles use levelling systems from the **MapeLevel** line to maintain the correct width for the grouts and to reduce lippage between adjacent tiles.
- 12 ULTRACOLOR PLUS**
Once the adhesive has set, carefully fill the grouts to their full depth using a rubber trowel without leaving gaps or steps. When the mix starts to lose its plasticity, clean off any excess product with a damp cellulose sponge. They may also be finished off while the product is partially hardened by going over the surface with a damp abrasive pad (such as a Scotch-Brite® pad). Remove any cementitious residues with **UltraCare Keranet**.
- 13 MAPESIL LM**
Seal the perimeter and expansion joints after inserting **Mapefoam** to set the correct depth and then finish off the surface of the sealant with **UltraCare Smooth Silicone**.

SYSTEM FOR BONDING LARGE-FORMAT CERAMIC TILES IN INTERNAL ENVIRONMENTS



- 1 Render **INTOMAP R2 FIBRO**
- 2 Adhesive **ULTRALITE S1 FLEX ZERO**
- 3 Large-format ceramic tiles
- 4 Grout **KERAPOXY EASY DESIGN**
- 5 Sealant **MAPEFOAM + MAPESIL AC**

APPLICATION STEPS

- 1 **INTOMAP R2 FIBRO**
Apply the lime/cement-based render in a single layer (up to 30 mm thick) with manual tools or by spray with a rendering machine.
- 2 **ULTRALITE S1 FLEX ZERO**
Apply the adhesive using the double-buttering method (in straight lines parallel to the short side of the tiles). Use a trowel with sloping notches (minimum notch size 10 mm) to spread the adhesive on the substrate and a trowel with 3-4 mm square notches for the adhesive on the back of the tiles. While installing the tiles use levelling systems from the **MapeLevel** line to maintain the correct width for the grouts and to reduce lippage between adjacent tiles.
- 4 **KERAPOXY EASY DESIGN**
Once the adhesive has set, carefully fill the grouts to their full depth using a rubber trowel without leaving gaps or steps. After filling the grouts with epoxy mortar clean the surface while the mortar is still wet fresh with a cellulose sponge dipped in water and a Scotch-Brite® pad where required. Carry out any final cleaning required using **UltraCare Kerapoxy Cleaner**.
- 5 **MAPESIL AC**
Seal the perimeter and expansion joints after inserting **Mapefoam** to set the correct depth and then finish off the surface of the sealant with **UltraCare Smooth Silicone**.

CEMENTITIOUS SYSTEM FOR CREATING A DECORATIVE TROWELLED OR MOTTLED EFFECT FINISH ON FLOORS AND FURNISHING ACCESSORIES IN RESIDENTIAL ENVIRONMENTS



- 1 Substrate
- 2 Primer **PRIMER SN + QUARTZ 0.5**
for vertical surfaces: **PRIMER GRIP WHITE** or **PRIMER LT**
- 3 Trowellable cementitious paste
ULTRATOP LOFT F
- 4 Adhesion promoter **PRIMER LT**
- 5 Trowellable cementitious paste
ULTRATOP LOFT W
- 6 Acrylic porosity blocking formulate **ULTRATOP BASE COAT**
- 7 Finishing range **MAPEFLOOR FINISH**

APPLICATION STEPS

- 1 The substrate must be clean, dry and mechanically strong. There must be no rising damp coming from the substrate.
- 2 **PRIMER SN**
After preparing the substrate as specified, apply the epoxy primer fillerized with **Quartz 0.5** and broadcast the surface with the same type of quartz sand (for vertical surfaces: **Primer Grip White** or **Primer LT** according to the type of substrate).
- 3 **ULTRATOP LOFT F**
Apply the coarse-textured trowellable cementitious paste with added pigments according to the colour required.
- 4 **PRIMER LT**
Apply a coat of one-component acrylic adhesion promoter diluted 1:1 in weight with water to act as an impregnator and porosity blocker.
- 5 **ULTRATOP LOFT W**
Apply the coarse-textured trowellable cementitious paste with added pigments according to the colour required.
- 6 **ULTRATOP BASE COAT**
Apply the one-component acrylic formulate to act as a porosity blocker.
- 7 **MAPEFLOOR FINISH** range
Protect the surface by applying 1 or 2 coats of two-component polyurethane finish from the **Mapefloor Finish** range.

SYSTEM FOR INSTALLING WOOD FLOORING ON HEATED SCREEDS WITH SOUNDPROOFING



APPLICATION STEPS

- 2 MAPESILENT COMFORT**
Unroll and apply the sheets, making sure there is an overlap of at least 5 cm to guarantee continuity in the soundproofing layer.
- 3 MAPESILENT BAND R**
Apply the soundproofing strip along the bottom of the perimeter walls and around any elements passing through the screed.
- 4 MAPESILENT TAPE**
Seal overlaps between the sheets with the soundproofing tape and press down firmly with a rigid roller.
- 7 TOPCEM PRONTO**
Position a series of levelling guides, spread the mix, carefully compact the mix and float-finish the surface. Minimum thickness over the heating elements: 3 cm; place metal reinforcing mesh at the mid-point or add **Mapefibre ST 30** structural fibres.
- 8 ULTRABOND ECO S 948 1K**
Apply the adhesive with a suitable trowel.
- 10 ULTRABOND S 997 1K**
Apply the adhesive used to bond the skirting.
- 11 SILWOOD**
Seal the skirting with **Silwood** in the same colour as the wood flooring.

- | | |
|--|--|
| <ol style="list-style-type: none"> 1 Concrete substrate 2 Soundproofing system
MAPESILENT COMFORT 3 Soundproofing band MAPESILENT BAND R 4 Soundproofing tape MAPESILENT TAPE 5 Vapour barrier 6 Floor heating system 7 Cementitious screed TOPCEM PRONTO 8 Adhesive ULTRABOND P980 1K 9 Prefinished wooden floor 10 Adhesive ULTRABOND S 997 1K | <ol style="list-style-type: none"> 11 Sealant SILWOOD |
|--|--|

SYSTEM FOR INSTALLING CERAMIC TILES IN DAMP ENVIRONMENTS ON WATERPROOFING MULTIPURPOSE PANELS

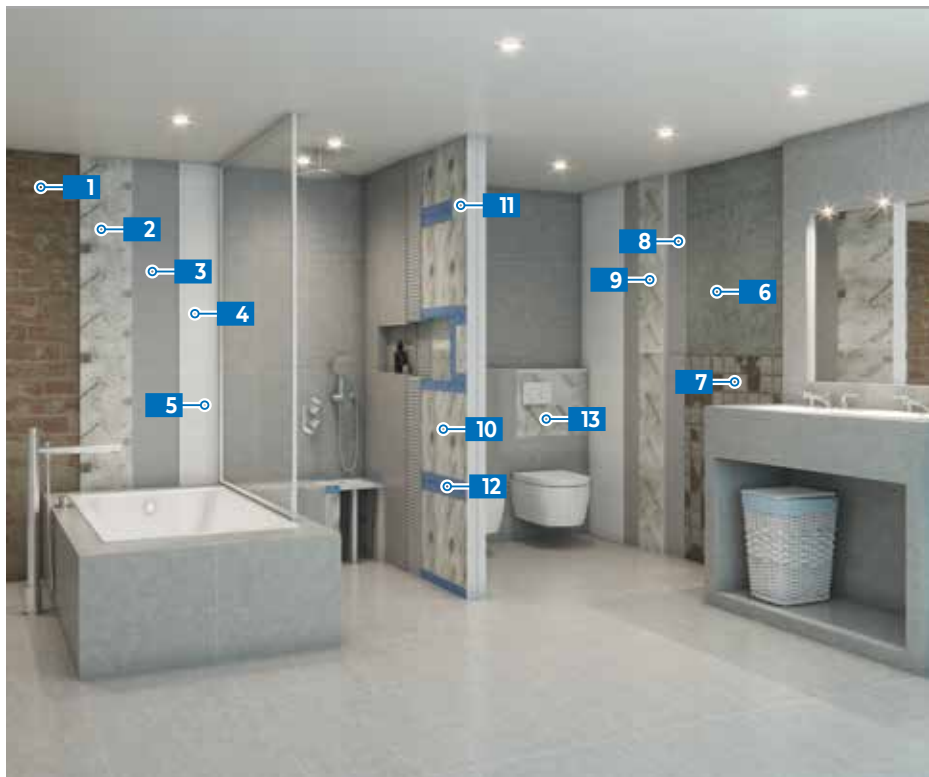

- 1** Masonry
- 2** Applying in beads and spots with adhesive **ULTRALITE S1 FLEX ZERO** the waterproofing multipurpose panel **MAPEGUARD BOARD**
- 3** Adhesive **ULTRALITE S1 FLEX ZERO**
- 4** Porcelain tiles
- 5** Grout **KERAPOXY EASY DESIGN**
- 6** Damaged render
- 7** Old tiles
- 8** Adhesive **ULTRALITE S1 FLEX ZERO**
- 9** Waterproofing multipurpose panel **MAPEGUARD BOARD**
- 10** Waterproofing multipurpose panels **MAPEGUARD BOARD** assembled with hybrid sealant **MAPEFLEX MS45** and adhesive **ULTRALITE S1 FLEX ZERO**
- 11** Adhesive **MAPEGUARD WP ADHESIVE**
- 12** Band **MAPEGUARD ST**
- 13** Waterproofing multipurpose panels **MAPEGUARD BOARD** assembled with hybrid sealant **MAPEFLEX MS45**

APPLICATION STEPS

- 1** **Installation of Mapeguard Board multipurpose panels with beads and spots of Ultralite S1 Flex Zero adhesive.**
- 2** Cut the panels to the size required with a cutter. Apply the beads and spots of adhesive on the panels and bond them directly to the substrate.
- 3** **ULTRALITE S1 FLEX ZERO**
Apply the adhesive on the substrate with a notched trowel suitable for the type and format of the tiles to ensure the back of the tiles is sufficiently wetted. Use the double-buttering method where specified by UNI 11493-1. While installing the tiles use levelling systems from the **MapeLevel** line to maintain the correct width for the grouts and to reduce lippage between adjacent tiles.
- 5** **KERAPOXY EASY DESIGN**
Once the adhesive has set, carefully fill the grouts to their full depth using a rubber trowel without leaving gaps or steps. After filling the grouts with epoxy mortar clean the surface while the mortar is still wet fresh with a cellulose sponge dipped in water and a Scotch-Brite® pad where required. Carry out any final cleaning required using **UltraCare Kerapoxy Cleaner**.
- 8** **ULTRALITE S1 FLEX ZERO**
Apply a full layer of adhesive on the substrate.
- 9** **MAPEGUARD BOARD**
Cut the panels to the size required with a cutter and bond the panels directly to the substrate.
- 10** **Mapeguard Board multipurpose waterproof panel assembled with Mapeflex MS45 hybrid sealant and Ultralite S1 Flex Zero adhesive.**
Use the adhesive and hybrid sealant to assemble the panels required to create shower walls.
- 11** **MAPEGUARD WP ADHESIVE**
Apply the adhesive with a brush or No 3 notched trowel or roller to bond the waterproofing accessories.
- 12** **MAPEGUARD ST**
Seal the joints between each single panel with waterproofing tape and seal all the critical areas (corners, edges, through elements) with special accessory items from the **Mapeguard system** (**Mapeguard IC**, **Mapeguard EC** and **Mapeguard PC**).
- 13** **Mapeguard Board multipurpose waterproof panel assembled with Mapeflex MS45 hybrid sealant.**
Cut the panels to the size required with a cutter. Create holes and openings for through elements using a drill with a hole-saw bit or with a reciprocating saw. Use the hybrid sealant and mechanical fasteners to assemble the panels to create partitions and furnishing features.

SYSTEM FOR QUICKLY RESTYLING BATHROOMS WITH A READY-TO-USE WATERPROOFER AND THE INSTALLATION OF GLASS MOSAICS OR CERAMIC TILES



- 1** Existing tiles
- 2** Primer **ECO PRIM T PLUS**
- 3** Levelling compound **PLANITOP FAST 330**
- 4** Ready-to-use waterproofer **MAPELASTIC AQUADEFENSE**
- 5** Floor drain **DRAIN VERTICAL / DRAIN LATERAL**
- 6** Rubber tape **MAPEBAND**
- 7** Adhesive **ULTRALITE S1 FLEX QUICK**
- 8** Glass mosaic
- 9** Grout **KERAPOXY EASY DESIGN**
- 10** Sealnt **MAPEFOAM + MAPESIL AC**
- 11** Grout **KERAPOXY EASY DESIGN + MAPEGLITTER**

APPLICATION STEPS

- 1** The old tiles must be clean and well bonded to the base layer. Clean the surface of the existing floor with **Ultracare HD Cleaner** diluted 1:5 or 1:10 with water according to the amount of dirt on the floor.
- 2** **ECO PRIM T PLUS**
Apply the primer with a brush, roller or trowel.
- 3** **PLANITOP FAST 330**
Level off the surface by applying the product with a long metal trowel.
- 4** **MAPELASTIC AQUADEFENSE**
Apply two layers of product with a brush, long-pile roller or trowel to form a total thickness of at least 0.8 mm.
- 5** **DRAIN VERTICAL / DRAIN LATERAL**
Insert the floor drain in the water outlet pipe and press the fabric panel onto the **Mapelastic AquaDefense** with a smooth trowel.
- 6** **MAPEBAND**
Apply the elastic tape for fillet joints on the first layer of **Mapelastic AquaDefense** while still fresh.
- 7** **ULTRALITE S1 QUICK FLEX**
Apply the adhesive on the substrate with a notched trowel suitable for the type and format of the tiles to ensure the back of the tiles is sufficiently wetted. Use the double-buttering method where specified by UNI 11493-1. While installing the tiles use levelling systems from the **MapeLevel** line to maintain the correct width for the grouts and to reduce lippage between adjacent tiles.
- 9** **KERAPOXY EASY DESIGN**
Once the adhesive has set, carefully fill the grouts to their full depth using a rubber trowel without leaving gaps or steps. After filling the grouts with epoxy mortar clean the surface while the mortar is still wet fresh with a cellulose sponge dipped in water and a Scotch-Brite® pad where required. Carry out any final cleaning required using **UltraCare Kerapoxy Cleaner**.
- 10** **MAPESIL AC**
Seal the perimeter and expansion joints after inserting **Mapefoam** to set the correct depth. and then finish off the surface of the sealant with **UltraCare Smooth Silicone**.
- 11** **KERAPOXY EASY DESIGN + MAPEGLITTER**
Once the adhesive has set, carefully fill the grouts to their full depth using a rubber trowel without leaving gaps or steps. Adding **MapeGlitter** to the mix creates particular aesthetic effects. After filling the grouts with epoxy mortar clean the surface while the mortar is still wet fresh with a cellulose sponge dipped in water and a Scotch-Brite® pad where required. Carry out any final cleaning required using **UltraCare Kerapoxy Cleaner**.

SYSTEM FOR INSTALLING LVT/SPC IN DAMP ENVIRONMENTS INCLUDING OVER EXISTING CERAMIC TILES



- 1 Existing tiles
- 2 Smoothing compound **PLANIPREP CONTRACT**
- 3 Adhesive **ULTRABOND ECO MS 4 LVT WALL&FLOOR**
- 4 LVT / SPC
- 5 Grout **FLEXCOLOR 4 LVT**
- 6 Finishing **MAPECOAT 4 LVT**
- 7 Sealant **MAPESIL AC**

APPLICATION STEPS

- 1 The old tiles must be clean and well bonded to the base layer. Clean the surface of the existing floor with **UltraCare HD Cleaner** diluted 1:5 or 1:10 with water according to the amount of dirt on the floor.
- 2 **PLANIPREP CONTRACT**
Apply one or two layers (wait 2-3 hours between each layer) with a smooth metal trowel to eliminate any irregular or uneven areas between the tiles.
- 3 **ULTRABOND ECO MS 4 LVT WALL&FLOOR**
Apply the product with a MAPEI No. 1 or TKB A2 notched trowel (for LVT with an uneven back or not particularly flat, use a MAPEI No. 2 or 3 or TKB B1 trowel).
- 5 **FLEXCOLOR 4 LVT**
Apply the product when the adhesive used to install the LVT is set. Fill the grouts using a MAPEI rubber trowel. After 15-20 minutes remove any residues or traces with a damp sponge.
- 6 **MAPECOAT 4 LVT**
Before applying the product thoroughly clean the surface of the LVT with a red or green **Ulтраcoat Pad**. After mixing the two components as specified (comp. A : comp. B = 5 : 1 in weight), apply a criss-cross layer of product with a short-pile roller (such as an **Ulтраcoat Roller T3** or **T5**) or by airless spray.
- 7 **MAPESIL AC**
Apply the one-component acetic silicone sealant in correspondence with expansion joints and joints between the floor and wall.

SYSTEM FOR INSTALLING DECORATIVE WALL COVERINGS AND LVT/SPC IN DAMP ENVIRONMENTS INCLUDING OVER EXISTING CERAMIC TILES



- | | |
|--|---|
| <ul style="list-style-type: none"> 1 Existing tiles 2 Smoothing compound PLANIPREP CONTRACT 3 Adhesive ULTRABOND ECO MS 4 LVT WALL&FLOOR 4 LVT / SPC 5 Finishing MAPECOAT 4 LVT 6 Sealant MAPESIL AC 7 Existing tiles 8 Smoothing compound PLANIPREP CONTRACT 9 Adhesive ULTRABOND ECO DECOR WET | <ul style="list-style-type: none"> 10 Decorative glass fibre 11 Protective finishing MAPECOAT DECOR PROTECTION |
|--|---|

APPLICATION STEPS

- 1** The old tiles must be clean and well bonded to the base layer. Clean the surface of the existing floor with **UltraCare HD Cleaner** diluted 1:5 or 1:10 with water according to the amount of dirt on the floor.
- 2** **PLANIPREP CONTRACT** grey/white
- 8** Apply one or two layers (wait 2-3 hours between each layer) with a smooth metal trowel to eliminate any irregular or uneven areas between the tiles.
- 3** **ULTRABOND ECO MS 4 LVT WALL&FLOOR**
- Apply the product with a MAPEI No. 1 or TKB A2 notched trowel (for LVT with an uneven back or not particularly flat, use a MAPEI No. 2 or 3 or TKB B1 trowel).
- 5** **MAPECOAT 4 LVT**
- Before applying the product thoroughly clean the surface of the LVT with a red or green **Ultracoat Pad**. After mixing the two components as specified (comp. A : comp. B = 5 : 1 in weight), apply a criss-cross layer of product with a short-pile roller (such as an **Ultracoat Roller T3** or **T5**) or by airless spray.
- 6** **MAPESIL AC**
- Apply the one-component acetic silicone sealant in correspondence with expansion joints and joints between the floor and wall.
- 9** **ULTRABOND ECO DECOR WET**
- Adhesive supplied ready to use and does not require any preparation. Apply the product with a smooth trowel.
- 11** **MAPECOAT DECOR PROTECTION**
- After mixing the two components as specified (comp. A : comp. B = 5 : 1 in weight), apply a criss-cross layer of product with a short-pile roller (such as an **Ultracoat Roller T3** or **T5**) or by airless spray.

SYSTEM FOR INSTALLING CERAMIC TILES OVER EXISTING CERAMIC FLOOR TILES

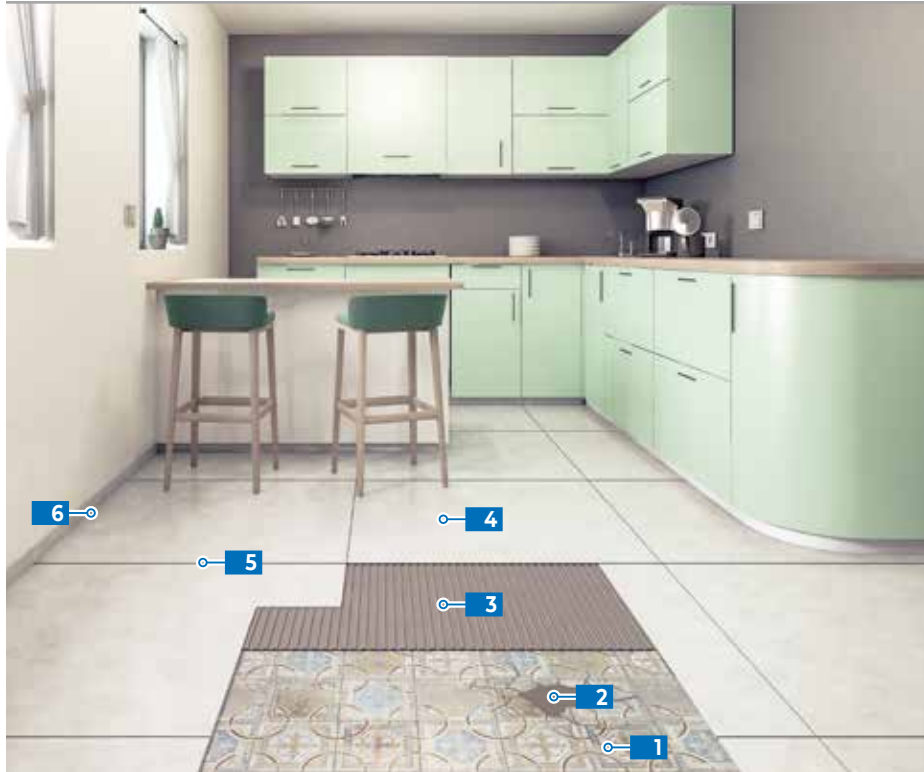

APPLICATION STEPS

- 1** The old tiles must be clean and well bonded to the base layer. Clean the surface of the existing floor with **UltraCare HD Cleaner** diluted 1:5 or 1:10 with water according to the amount of dirt on the floor.
- 2** **PLANITOP FAST 330**
After checking and preparing the existing substrate with a suitable cleaning operation using **UltraCare HD Cleaner**, fill any gaps left after removing damaged tiles by applying the skimming product with a trowel.
- 3** **KERAFLEX EXTRA S1 ZERO**
Apply the adhesive on the substrate with a notched trowel suitable for the type and format of the tiles to ensure the back of the tiles is sufficiently wetted. Use the double-buttering method where specified by UNI 11493-1. While installing the tiles use levelling systems from the **MapeLevel** line to maintain the correct width for the grouts and to reduce lippage between adjacent tiles.
- 5** **KERAPOXY EASY DESIGN**
Once the adhesive has set, carefully fill the grouts to their full depth using a rubber trowel without leaving gaps or steps. After filling the grouts with epoxy mortar clean the surface while the mortar is still wet fresh with a cellulose sponge dipped in water and a Scotch-Brite® pad where required. Carry out any final cleaning required using **UltraCare Kerapoxy Cleaner**.
- 6** **MAPESIL AC**
Seal the perimeter and expansion joints after inserting **Mapefoam** to set the correct depth and then finish off the surface of the sealant with **UltraCare Smooth Silicone**.

- 1** Not cracked and well anchored existing tiles
- 2** Smoothing compound for repairing detached tiles **PLANITOP FAST 330**
- 3** Adhesive **KERAFLEX EXTRA S1 ZERO**
- 4** Ceramic tiles
- 5** Grout **KERAPOXY EASY DESIGN**
- 6** Sealant **MAPEFOAM + MAPESIL AC**

SYSTEM FOR INSTALLING CERAMIC TILES OVER EXISTING FLOORING AND INSTALLING A SOUNDPROOFING LAYER UNDER THE FLOOR



- 1 Existing tiles
- 2 Adhesive **ULTRABOND ECO S955 1K**
- 3 Soundproofing membrane + perimetral band **MAPESONIC CR + MAPESONIC STRIP**
- 4 Adhesive **KERAFLEX MAXI SI ZERO**
- 5 Ceramic tiles
- 6 Grout **KERAPOXY EASY DESIGN**
- 7 Sealant **MAPEFOAM + MAPESIL AC**

APPLICATION STEPS

- 1 The old tiles must be clean and well bonded to the base layer. Clean the surface of the existing floor with **UltraCare HD Cleaner** diluted 1:5 or 1:10 with water according to the amount of dirt on the floor.
- 2 **ULTRABOND ECO S955 1K**
Apply the adhesive with a No.1 or No.2 MAPEI trowel according to the roughness of the substrate to bond the soundproofing membrane.
- 3 **MAPESONIC CR + MAPESONIC STRIP**
Apply the adhesive tape along the perimeter walls, pillars and along any other element passing through the floor. Apply the soundproofing membrane by butting the sheets against one another.
- 4 **KERAFLEX MAXI SI ZERO**
Apply the adhesive with a notched trowel suitable for the type and format of the tiles to ensure the back of the tiles is sufficiently wetted. Use the double-buttering method where specified by UNI 11493-1. While installing the tiles use levelling systems from the **MapeLevel** line to maintain the correct width for the grouts and to reduce lippage between adjacent tiles.
- 6 **KERAPOXY EASY DESIGN**
Once the adhesive has set, carefully fill the grouts to their full depth using a rubber trowel without leaving gaps or steps. After filling the grouts with epoxy mortar clean the surface while the mortar is still wet fresh with a cellulose sponge dipped in water and a Scotch-Brite® pad where required. Carry out any final cleaning required using **UltraCare Kerapoxy Cleaner**.
- 7 **MAPESIL AC**
Seal the perimeter and expansion joints after inserting **Mapefoam** to set the correct depth and then finish off the surface of the sealant with **UltraCare Smooth Silicone**.

SYSTEM FOR INSTALLING CERAMIC TILES ON A COMPACT HEATED SCREED WITH HIGH THERMAL CONDUCTIVITY ON AN ISOLATING AND ANTI-FRACTURE MEMBRANE

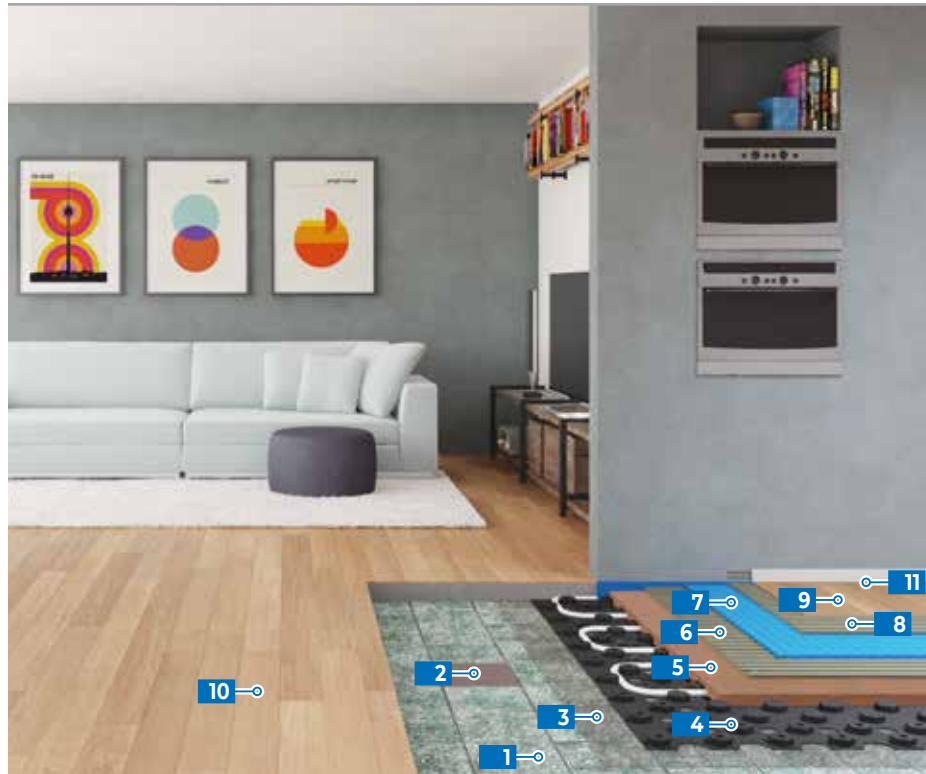

- 1** Existing ceramic floor
- 2** Filling mortar for removed tiles **PLANITOP FAST 330**
- 3** Primer **ECO PRIM T PLUS**
- 4** Thin heating system
- 5** Self-levelling smoothing compound **NOVOPLAN MAXI**
- 6** Adhesive **ULTRALITE S1 FLEX ZERO**
- 7** Uncoupling anti-fracture membrane **MAPEGUARD UM 35**
- 8** Adhesive **ULTRALITE S1 FLEX ZERO**
- 9** Wood-effect porcelain tiles
- 10** Grout **ULTRACOLOR PLUS**
- 11** Sealant **MAPEFOAM + MAPESIL AC**

APPLICATION STEPS

- 1** The old tiles must be clean and well bonded to the base layer. Clean the surface of the existing floor with **UltraCare HD Cleaner** diluted 1:5 or 1:10 with water according to the amount of dirt on the floor.
- 2** **PLANITOP FAST 330**
After checking and preparing the existing substrate, fill any gaps left after removing damaged tiles by applying the skimming product with a trowel.
- 3** **ECO PRIM T PLUS**
Apply the primer with a brush or roller.
- 5** **NOVOPLAN MAXI**
Skim the surface by applying the cementitious levelling product with high thermal conductivity with a large metal trowel or rake. The thickness must be at least 3 mm over the dimples in the panels, up to a maximum total thickness of 40 mm.
- 6** **ULTRALITE S1 FLEX ZERO**
Apply the adhesive with a No. 5 notched trowel to bond the membrane.
- 7** **MAPEGUARD UM 35**
Place the membrane on the adhesive while still fresh and press down firmly on the surface with a float or a **Mapeguard Roller**.
- 8** **ULTRALITE S1 FLEX ZERO**
Apply the adhesive using the double-buttering method with a notched trowel suitable for the type and format of the tiles so that the back of the tiles is sufficiently wetted with adhesive. While installing the tiles use levelling systems from the **MapeLevel** line to maintain the correct width for the grouts and to reduce lippage between adjacent tiles.
- 10** **ULTRACOLOR PLUS**
Once the adhesive has set, carefully fill the grouts to their full depth using a rubber trowel without leaving gaps or steps. When the mix starts to lose its plasticity, clean off any excess product with a damp cellulose sponge. They may also be finished off while the product is partially hardened by going over the surface with a damp abrasive pad (such as a Scotch-Brite® pad). Remove any cementitious residues with **UltraCare Keranet**.
- 11** **MAPESIL AC**
Seal the perimeter and expansion joints after inserting **Mapefoam** to set the correct depth and then finish off the surface of the sealant with **UltraCare Smooth Silicone**.

SYSTEM FOR INSTALLING CERAMIC TILES ON A COMPACT HEATING SYSTEM MADE FROM GYPSUM FIBRE OR CEMENT FIBRE PANELS



- 1** Existing ceramic floor
- 2** Filling mortar for removed tiles **PLANITOP FAST 330**
- 3** Sealant (spots application) **ULTRABOND MS RAPID**
- 4** Thin heating system
- 5** Primer **ECO PRIM T PLUS**
- 6** Adhesive (1st coat) **KERAQUICK MAXI S1**
- 7** Adhesive (2nd coat) **KERAQUICK MAXI S1**
- 8** Ceramic tiles
- 9** Grout **ULTRACOLOR PLUS**
- 10** Sealant **MAPEFOAM + MAPESIL AC**

APPLICATION STEPS

- 1** The old tiles must be clean and well bonded to the base layer. Clean the surface of the existing floor with **UltraCare HD Cleaner** diluted 1:5 or 1:10 with water according to the amount of dirt on the floor.
- 2** **PLANITOP FAST 330**
After checking and preparing the existing substrate, fill any gaps left after removing damaged tiles by applying the skimming product with a trowel.
- 3** **ULTRABOND MS RAPID**
Bond the fibre cement or gypsum fibre panels to the existing substrate with the adhesive applied in beads around 20-30 cm apart.
- 5** **ECO PRIM T PLUS**
Apply the primer with a brush or roller over the entire surface of the panels.
- 6** **KERAQUICK MAXI S1**
Apply a first layer of adhesive using the smooth edge of a trowel to fill the cavities in the panel/ pipework.
- 7** **KERAQUICK MAXI S1**
Apply a second layer of adhesive using the double-buttering method with a notched trowel suitable for the type and format of the tiles to ensure the back of the tiles is wetted sufficiently. While installing the tiles use levelling systems from the **MapeLevel** line to maintain the correct width for the grouts and to reduce lippage between adjacent tiles.
- 9** **ULTRACOLOR PLUS**
Once the adhesive has set, carefully fill the grouts to their full depth using a rubber trowel without leaving gaps or steps. When the mix starts to lose its plasticity, clean off any excess product with a damp cellulose sponge. They may also be finished off while the product is partially hardened by going over the surface with a damp abrasive pad (such as a Scotch-Brite® pad). Remove any cementitious residues with **UltraCare Keranet**.
- 10** **MAPESIL AC**
Seal the perimeter and expansion joints after inserting **Mapecto** to set the correct depth and then finish off the surface of the sealant with **UltraCare Smooth Silicone**.

SYSTEM FOR QUICKLY INSTALLING LARGE-FORMAT CERAMIC TILES OVER CRACKED FLOORING WITH AN ISOLATING AND ANTI-FRACTURE MEMBRANE



- 1 Cracked existing floor
- 2 Adhesive **ULTRALITE S1 FLEX QUICK**
- 3 Uncoupling anti-fracture membrane **MAPEGUARD UM 35**
- 4 Adhesive **ULTRALITE S1 FLEX QUICK**
- 5 Large-format ceramic tiles
- 6 Grout **ULTRACOLOR PLUS**
- 7 Sealant **MAPEFOAM + MAPESIL AC**

APPLICATION STEPS

- 1 The old tiles must be clean and well bonded to the base layer. Clean the surface of the existing floor with **UltraCare HD Cleaner** diluted 1:5 or 1:10 with water according to the amount of dirt on the floor.
- 2 **ULTRALITE S1 FLEX QUICK**
Apply the adhesive with a No. 5 notched trowel to bond the membrane.
- 3 **MAPEGUARD UM 35**
Place the membrane on the adhesive while still fresh and press down firmly on the surface with a float or a **Mapeguard Roller**.
- 4 **ULTRALITE S1 FLEX QUICK**
Apply the adhesive using the double-buttering method (in straight lines parallel to the short side of the tiles). Use a trowel with sloping notches (minimum notch size 10 mm) to spread the adhesive on the substrate and a trowel with 3-4 mm square notches for the adhesive on the back of the tiles. While installing the tiles use levelling systems from the **MapeLevel** line to maintain the correct width for the grout lines and to reduce lippage between adjacent tiles.
- 5 **ULTRACOLOR PLUS**
Once the adhesive has set, carefully fill the grouts to their full depth using a rubber trowel without leaving gaps or steps. When the mix starts to lose its plasticity, clean off any excess product with a damp cellulose sponge. They may also be finished off while the product is partially hardened by going over the surface with a damp abrasive pad (such as a Scotch-Brite® pad). Remove any cementitious residues with **UltraCare Keranet**.
- 6 **MAPESIL AC**
Seal the perimeter and expansion joints after inserting **Mapefoam** to set the correct depth and then finish off the surface of the sealant with **UltraCare Smooth Silicone**.

SOUNDPROOFING SYSTEM FOR INSTALLING WOOD ON OLD TERRAZZO FLOORS



- 1** Old marble tiles
- 2** Sanding old marble tiles
- 3** Adhesive **ULTRABOND ECO S 958 1K**
- 4** Soundproofing membrane **MAPESONIC CR** (2 mm)
- 5** Adhesive **ULTRABOND ECO S 958 1K**
- 6** Multilayer pre-polished wood floor
- 7** Water-based binder for grout **ULTRACOAT BINDER**
- 8** Water-based one-component coat **ULTRACOAT UNIVERSAL BASE**
- 9** Water-based one-component polyurethane lacquer **ULTRACOAT EASY PLUS** (2 coats)
- 10** Sealant **SILWOOD**

APPLICATION STEPS

- 1** The old tiles must be clean and well bonded to the base layer. Clean the surface of the existing floor with **UltraCare HD Cleaner** diluted 1:5 or 1:10 with water according to the amount of dirt on the floor.
- 3** **ULTRABOND ECO S 958 1K**
Apply the adhesive with a No. 2 Mapei trowel.
- 4** **MAPESONIC CR**
Apply **Mapesonic Strip** adhesive tape along the perimeter walls, pillars and any other element passing through the floor. Apply the soundproofing membrane by butting the sheets against one another.
- 5** **ULTRABOND ECO S 958 1K**
Apply the adhesive with a Mapei wood trowel.
- 7** **ULTRACOAT BINDER**
Seal the surface of the floor by applying the product mixed with sawdust from the same flooring material with an **Ultracoat Steel Spatula**.
- 8** **ULTRACOAT UNIVERSAL BASE**
Apply the primer with an **Ultracoat Roller T 10**.
- 9** **ULTRACOAT EASY PLUS**
Finish off the surface by applying two coats of product with an **Ultracoat Roller T5**.
- 10** **SILWOOD**
Seal the skirting with **Silwood** in the same colour as the wood flooring.

SYSTEM FOR INSTALLING WOOD FLOORING ON AN EXISTING SUBSTRATE



APPLICATION STEPS

- 1 The cementitious screed must be clean, dry and mechanically strong and have no areas at risk of becoming detached. The level of residual moisture in the screed prior to installation, measured with a carbide hygrometer, must be no higher than 2%.
- 2 **ECO PRIM T PLUS**
Apply the primer with a roller.
- 3 **ULTRAPLAN MAXI**
Level off the substrate and bring it up to the height of the old screed by applying the product with a large metal trowel or rake.
- 4 **ULTRABOND ECO S LITE 1 K**
Apply the adhesive with a Mapei Wood trowel.
- 6 **ULTRACOAT BINDER**
Seal the surface of the floor by applying the product mixed with sawdust from the same flooring material with an **Ultracoat Steel Spatula**.
- 7 **ULTRACOAT HARD OIL WAX PLUS**
Finish off the floor by applying the product with an **Ultracoat Roller T3** or **Ultracoat Steel Spatula**.
- 8 **ULTRACOAT OIL CARE PLUS**
Finish the flooring by applying the product with a microfiber cloth.

- 1 Old cementitious screed
- 2 Primer **ECO PRIM T PLUS**
- 3 Self-levelling compound **ULTRAPLAN MAXI**
- 4 Adhesive **ULTRABOND ECO S LITE 1 K**
- 5 Oak wood
- 6 Grout **ULTRACOAT BINDER**
- 7 Oil/wax finishing **ULTRACOAT HARD OIL WAX PLUS**
- 8 Water-based micro-emulsion based on waxy resin **ULTRACOAT OIL CARE PLUS**

QUICK COMPACT SYSTEM FOR STRENGTHENING FLOORS AND INSTALLING CERAMIC TILES ON HEATED SCREEDS WITH SOUNDPROOFING

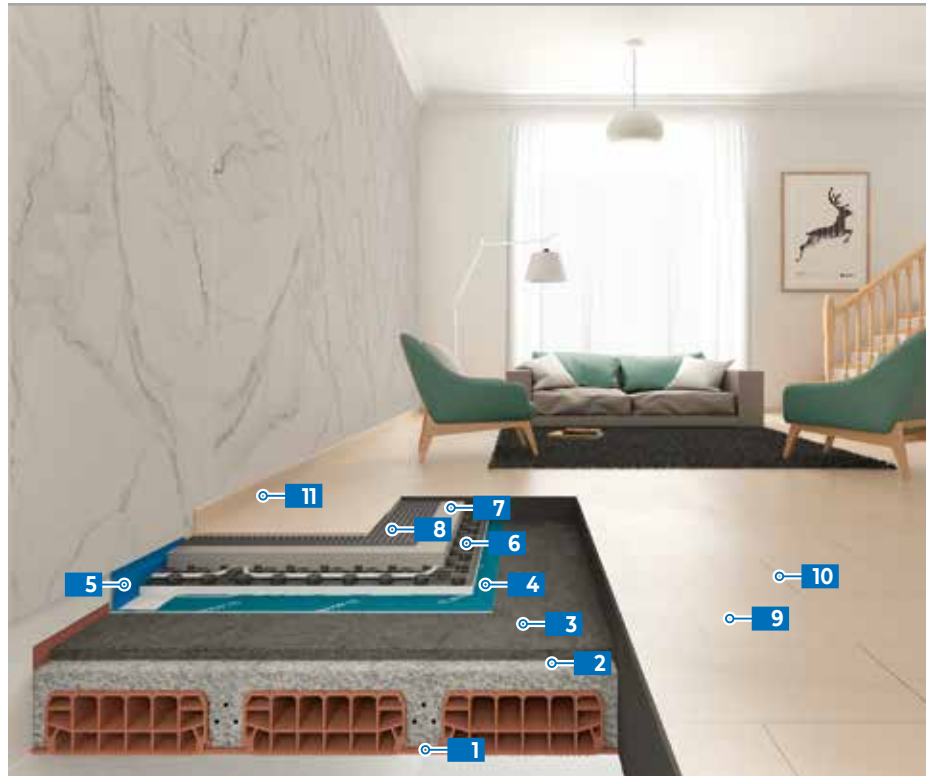

- 1** Existing slab
- 2** Acrylic primer in water dispersion **PRIMER 3296**
- 3** Fibre-reinforced structural mortar **PLANITOP HPC FLOOR**
- 4** Soundproofing membrane **MAPESILENT ROLL**
- 5** Soundproofing band and tape **MAPESILENT BAND R, MAPESILENT TAPE**
- 6** Floor heating system
- 7** Screed **TOPCEM PRONTO**
- 8** Adhesive **ULTRALITE S1 FLEX QUICK**
- 9** Ceramic floor
- 10** Grout **ULTRACOLOR PLUS**
- 11** (Label in image, not in legend)

APPLICATION STEPS

- 2 PRIMER 3296**
Dilute the product 1:1 with water and spread the mix with a roller.
- 3 PLANITOP HPC FLOOR**
Pour the product on the surface and, if necessary, help the mortar spread over the surface with a rake.
- 4 MAPESILENT ROLL**
Apply the sheets on the substrate following the long side of the room. Overlap the sheets by around 5 cm.
- 5 MAPESILENT BAND R + MAPESILENT TAPE**
Apply the soundproofing strip along the bottom of the perimeter walls and around any elements passing through the screed. Seal overlaps between the sheets with the soundproofing tape and press down firmly with a rigid roller.
- 7 TOPCEM PRONTO**
Position a series of levelling guides, spread the mix, carefully compact the mix and float-finish the surface. The thickness over the heating elements must be at least 3 cm. Insert metal reinforcing mesh at the mid-point or add **Mapecibre ST 30** structural fibres to the mix.
- 8 ULTRALITE S1 FLEX QUICK**
Apply the adhesive using the double-buttering method with a notched trowel suitable for the type and format of the tiles so that the back of the tiles is sufficiently wetted with adhesive. While installing the tiles use levelling systems from the **MapeLevel** line to maintain the correct width for the grouts and to reduce lippage between adjacent tiles.
- 10 ULTRACOLOR PLUS**
Once the adhesive has set, carefully fill the grouts to their full depth using a rubber trowel without leaving gaps or steps. When the mix starts to lose its plasticity, clean off any excess product with a damp cellulose sponge. They may also be finished off while the product is partially hardened by going over the surface with a damp abrasive pad (such as a Scotch-Brite® pad). Remove any cementitious residues with **UltraCare Keranet**.

SYSTEM TO PREVENT FLOORS COLLAPSING, COMPLETE WITH A WALL FINISH



APPLICATION STEPS

- 2 MAPEWRAP EQ ADHESIVE**
Apply a first, even layer with a brush or roller. Please refer to the **MapeWrap EQ System** data sheet.
- 3 MAPEWRAP EQ NET**
Immediately apply the special fabric and spread and flatten it out by hand (wear protective waterproof rubber gloves when carrying out this operation), making sure there are no folds or creases, then go over the surface several times with a **MapeWrap Roller** so that the adhesive completely penetrates into the fibres of the fabric.
Please refer to the **MapeWrap EQ System** data sheet.
- 4 MAPEWRAP EQ ADHESIVE**
Apply a second layer of adhesive with a brush or roller while the first layer is still fresh. Please refer to the **MapeWrap EQ System** data sheet.
- 5 PLANITOP 200**
Apply and spread the skimming mortar with a smooth metal trowel.
- 6 MALECH**
Apply the product with a brush or roller to even out the surface and to promote adhesion of the successive coat of paint.
- 7 DURSILITE MATT**
Once the primer is dry, apply at least 2 coats of paint with a brush or roller to completely cover the surface.

- 1** Render with removal of existing paint
- 2** Ready-to-use, water-based one-component adhesive in polyurethane dispersion
MAPEWRAP EQ ADHESIVE
- 3** Primed glass-fibre bi-directional fabric
MAPEWRAP EQ NET
- 4** Ready-to-use, water-based one-component adhesive in polyurethane dispersion
MAPEWRAP EQ ADHESIVE
- 5** Cementitious skimming mortar **PLANITOP 200**
- 6** Acrylic primer **MALECH**
- 7** Washable, hiding, water-based wall paint
DURSILITE MATT

RAPID SYSTEM CONSISTING OF AN ULTRA-THIN SKIM COAT AND WALL FINISHING TO PREVENT RUBBLE/DEBRIS FALLING FROM INTERNAL STUD WALLS AND FAÇADE INFILLS COMPLETE WITH LEVELLING AND WALL FINISH



APPLICATION STEPS

- 1** Remove the paint from the substrate down to the level of the existing render.
- 2** **MAPEWRAP EQ ADHESIVE**
Apply a first, even layer with a brush or roller.
- 3** **MAPEWRAP EQ NET**
Place the fabric in position, making sure there are no creases by going over the surface with a **MapeWrap Roller**, so that the adhesive completely penetrates through the fibres of the fabric.
- 4** **MAPEWRAP EQ ADHESIVE**
Apply the second coat while the first coat is still fresh. Use a **MapeWrap Roller** to remove any air bubbles.
- 5** **PLANITOP 200**
Apply and spread the skimming mortar with a smooth metal trowel.
- 6** **MALECH**
Apply the product with a brush or roller to even out the surface and to promote adhesion of the successive coat of paint.
- 7** **DURSILITE MATT**
Once the primer is dry, apply at least 2 coats of paint with a brush or roller to completely cover the surface.

- 1** Render with removal of existing paint
- 2** Ready-to-use, water-based, one-component adhesive in polyurethane dispersion
MAPEWRAP EQ ADHESIVE
- 3** Primed glass-fibre bi-directional fabric
MAPEWRAP EQ NET
- 4** Ready-to-use, water-based, one-component adhesive **MAPEWRAP EQ ADHESIVE**
- 5** Cementitious skimming mortar **PLANITOP 200**
- 6** Acrylic primer **MALECH**
- 7** Washable, hiding, water-based wall paint
DURSILITE MATT

PROBLEMS WITH A DAMAGED ROOF?

SYSTEM FOR WATERPROOFING NEW CEMENTITIOUS SUBSTRATES WITH A COLOURED POLYURETHANE MEMBRANE

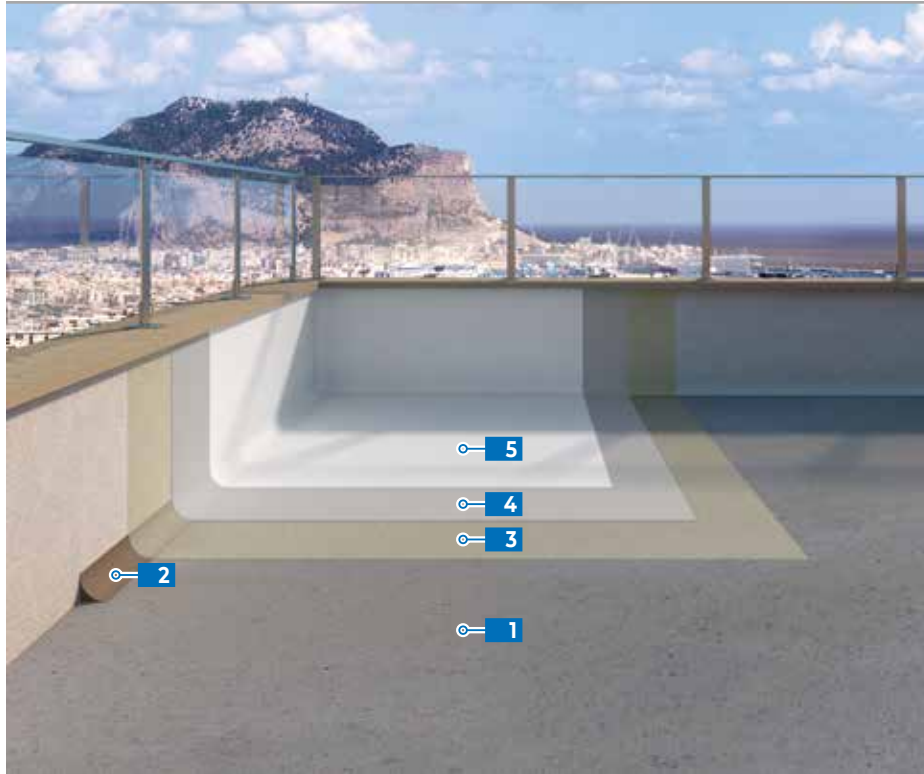
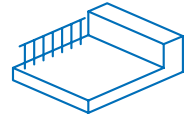

APPLICATION STEPS

- 1 TOPCEM PRONTO**
To create the screed, position a series of levelling guides, spread the mix, carefully compact the mix and float-finish the surface. Isolating screeds must be at least 3.5 cm thick.
- 2 PLANITOP FAST 330**
Create a fillet by applying the product with a trowel and blend it in by forming a rounded shape.
- 3 PRIMER FT**
Apply one or two coats of primer (according to the conditions of the substrate) with a roller, trowel or rake.
- 4 PURTOP EASY + PURTOP ADY**
Apply a single layer of product at least 1.2 mm thick with a trowel or by spray.
- 5 MAPECOAT PU 20 N + MAPECOAT FILLER**
Apply two thin coats of the aliphatic finish mixed with the filler with a roller.

- 1** New cementitious substrate **TOPCEM PRONTO**
- 2** Fillet **PLANITOP FAST 330**
- 3** Primer **PRIMER FT**
- 4** Waterproofing **PURTOP EASY + PURTOP ADY**
- 5** Coloured finishing **MAPECOAT PU 20 N + MAPECOAT FILLER**

PROBLEMS WITH A DAMAGED ROOF?

SYSTEM FOR WATERPROOFING OLD TILED ROOFS WITH A COLOURED READY-TO-USE WATERPROOFER

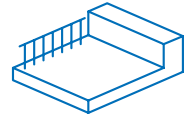

APPLICATION STEPS

- 1** The old tiles must be clean and well bonded to the base layer. Clean the surface of the existing floor with Ultracare **HD Cleaner** diluted 1:5 or 1:10 with water according to the amount of dirt on the floor.
- 2** **PLANITOP FAST 330**
Create a fillet by applying the product with a trowel and blend it in by forming a rounded shape.
- 3** **PRIMER SN + QUARTZ 0.5**
Apply two coats of primer with a trowel and broadcast the product while still fresh with **Quartz 0.5**.
- 4** **PURTOP EASY + PURTOP ADY**
Apply a single layer of product at least 1.2 mm thick with a trowel or by spray.
- 5** **MAPECOAT PU 20 N + MAPECOAT FILLER**
Apply two thin coats of the aliphatic finish mixed with the filler with a roller.

- 1** Old ceramic floor
- 2** Fillet **PLANITOP FAST 330**
- 3** Primer + broadcast **PRIMER SN + QUARTZ 0.5**
- 4** Waterproofer + admixture **PURTOP EASY + PURTOP ADY**
- 5** Aliphatic finishing **MAPECOAT PU 20 N + MAPECOAT FILLER**

PROBLEMS WITH RISING DAMP?

SYSTEM CONSISTING OF A LAYER OF CEMENT-FREE NATURAL HYDRAULIC LIME-BASED DEHUMIDIFYING RENDER



APPLICATION STEPS

- 1** The existing masonry must be clean and free of any crumbling material. Before applying the dehumidifying render the surface of the masonry may be wetted.
- 2** **MAPE-ANTIQUÉ NHL ECO RISANA**
Apply a 20 to 30 mm thick layer of macro-porous dehumidifying render with a trowel or rendering machine.
- 3** **MAPE-ANTIQUÉ NHL ECO RASANTE CIVILE**
Apply the breathable skimming mortar in layers 2 mm thick with a flat metal trowel.
- 4** **SILEXCOLOR PRIMER**
Apply the primer with a brush, roller or by spray.
- 5** **SILEXCOLOR PAINT**
Apply 2 coats of paint with a brush, roller or by spray.

- 1** Existing masonry
- 2** De-humidifying render **MAPE-ANTIQUÉ NHL ECO RISANA**
- 3** Breathable skimming mortar **MAPE-ANTIQUÉ NHL ECO RASANTE CIVILE**
- 4** Silicate undercoat **SILEXCOLOR PRIMER**
- 5** Silicate paint **SILEXCOLOR PAINT**

PROBLEMS WITH RISING DAMP?

SYSTEM TO STOP RISING DAMP AND CREATE HEALTHIER MORE COMFORTABLE SURROUNDINGS BY APPLYING A LAYER OF DEHUMIDIFYING RENDER AND A CHEMICAL BARRIER

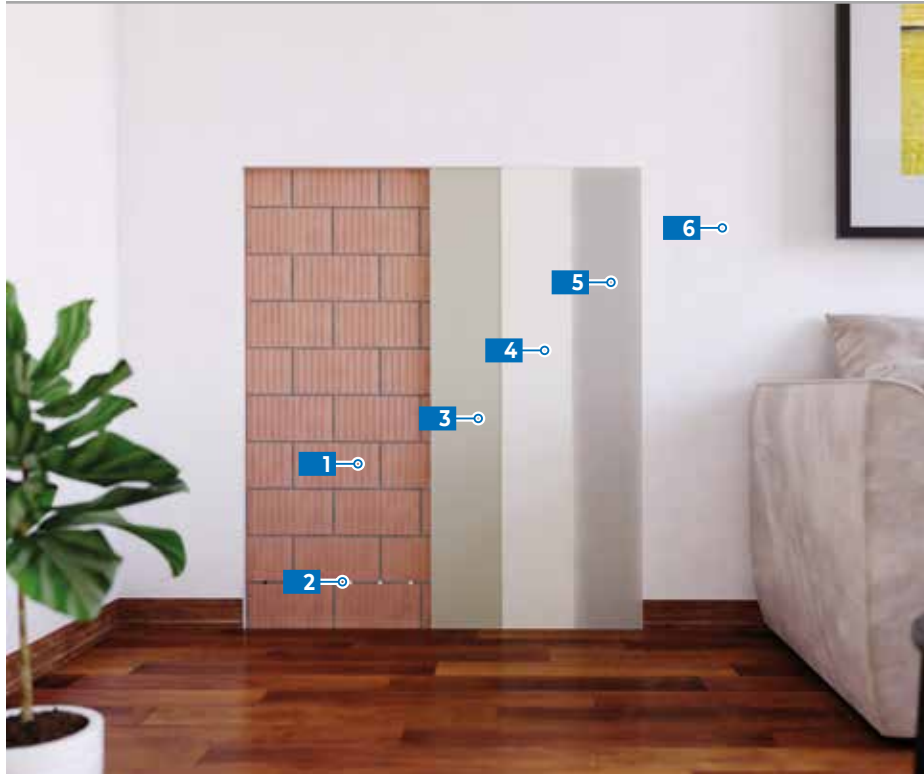

APPLICATION STEPS

2 MAPESTOP CREAM

Drill a row of 12 mm diameter holes up to 12 cm apart and at least 12 cm above ground level. The depth of the holes should be around 5 cm less than the total thickness of the masonry and are used to inject the chemical barrier with an injection gun and cartridges or soft-cartridges of product with a low-pressure pump.

3 POROMAP DEUMIDIFICANTE

Apply a 20 to 30 mm thick layer of macro-porous dehumidifying render with a trowel or rendering machine.

4 POROMAP FINITURA CIVILE

Apply the breathable skimming mortar in layers 2 mm thick with a flat metal trowel.

5 SILANCOLOR PRIMER

Apply the primer with a brush, roller or by spray.

6 SILANCOLOR PAINT ZERO

Apply 2 coats of paint with a brush, roller or by spray.

- 1 Existing masonry
- 2 Chemical barrier **MAPESTOP CREAM**
- 3 De-humidifying render **POROMAP DEUMIDIFICANTE**
- 4 Breathable skimming mortar **POROMAP FINITURA CIVILE**
- 5 Siloxane undercoat **SILANCOLOR PRIMER**
- 6 Siloxane hygienising paint **SILANCOLOR PAINT ZERO**

PROBLEMS WITH RISING DAMP?

SYSTEM FOR RESTORING MASONRY BY APPLYING A LAYER OF CEMENT-FREE
NATURAL HYDRAULIC LIME-BASED DEHUMIDIFYING RENDER

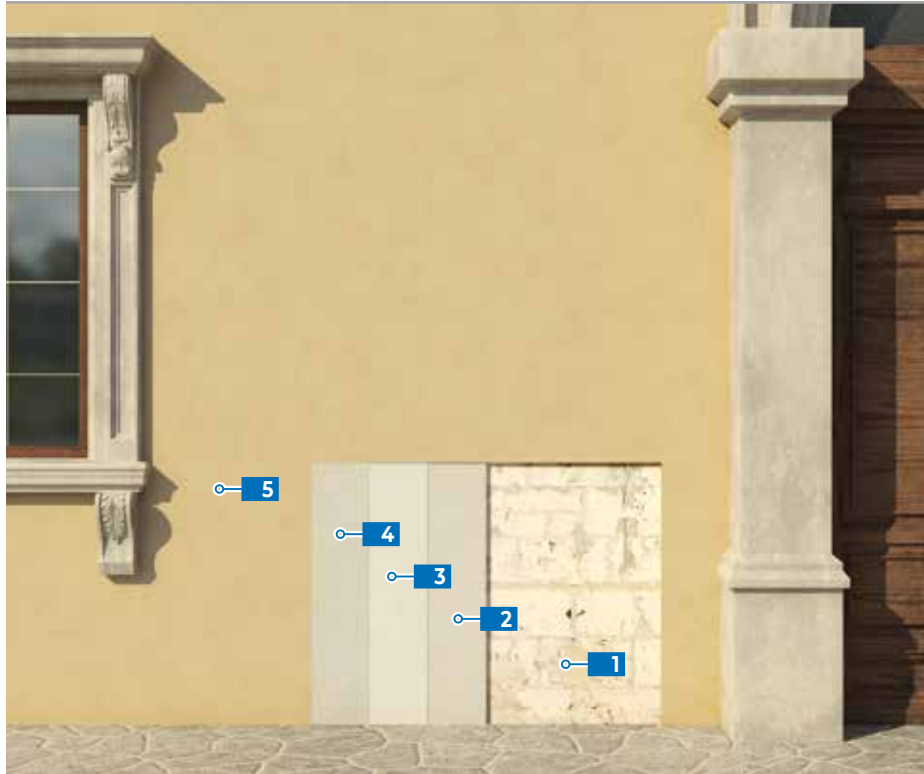

APPLICATION STEPS

- 1** Thoroughly clean the surface of the masonry by hydro-blasting to remove any crumbling areas or areas at risk of becoming detached.
- 2** **MAPE-ANTIQUÉ NHL ECO RISANA**
Apply a 20 to 30 mm thick layer of macro-porous dehumidifying render with a trowel or rendering machine.
- 3** **MAPE-ANTIQUÉ NHL ECO RESTAURA**
Apply the breathable skimming mortar in layers at least 3 mm thick with a flat metal trowel.
- 4** **SILEXCOLOR PRIMER**
Apply the primer with a brush, roller or by spray.
- 5** **SILEXCOLOR PAINT**
Apply 2 coats of paint with a brush, roller or by spray.

- 1** Existing masonry
- 2** De-humidifying render **MAPE-ANTIQUÉ NHL ECO RISANA**
- 3** Breathable skimming mortar **MAPE-ANTIQUÉ NHL ECO RESTAURA**
- 4** Silicate undercoat **SILEXCOLOR PRIMER**
- 5** Silicate paint **SILEXCOLOR PAINT**

PROBLEMS WITH RISING DAMP?

SYSTEM FOR RESTORING EXISTING MASONRY WITH RISING DAMP BY APPLYING A LAYER OF DEHUMIDIFYING RENDER



APPLICATION STEPS

- 1** Thoroughly clean the masonry by hydro-blasting to remove any crumbling areas and any salt from the surface or trapped in the masonry itself.
- 2** **POROMAP DEUMIDIFICANTE**
Apply a 20 to 30 mm thick layer of macro-porous dehumidifying render with a trowel or rendering machine.
- 3** **SILANCOLOR BASE COAT**
Apply the pigmented filler/primer with a brush, roller or by spray.
- 4** **SILANCOLOR TONACHINO**
Apply the coating product with a trowel + float.

- 1** Existing masonry
- 2** De-humidifying render **POROMAP DEUMIDIFICANTE**
- 3** Siloxane, pigmented filling undercoat **SILANCOLOR BASE COAT**
- 4** Thick siloxane coating **SILANCOLOR TONACHINO**

PROBLEMS WITH DAMP FROM INFILTRATIONS IN UNDERGROUND ENVIRONMENTS?

COMPLETE SYSTEM FOR TREATING INFILTRATIONS AND WATERPROOFING EXISTING UNDERGROUND STRUCTURES USED AS SERVICE/PLANT AREAS



- | | |
|--|---|
| <p>1 Existing cementitious structure</p> <p>2 Evening with mortars from the MAPEGROUT range</p> <p>3 Hydraulic binder LAMPOSILEX</p> <p>4 Waterproofing sealant MAPEPROOF SWELL</p> <p>5 Repairing with mortars from the MAPEGROUT range</p> <p>6 Band MAPEBAND TPE + ADESILEX PG4</p> <p>7 Primer PRIMER 3296</p> <p>8 Waterproofer MAPELASTIC FOUNDATION</p> <p>9 Elastomeric sanitising paint ELASTOCOLOR PAINT PLUS</p> | <p>10 Adhesive KERAFLEX MAXI S1 ZERO</p> <p>11 Tile covering</p> <p>12 Grout ULTRACOLOR PLUS</p> <p>13 Sealant MAPEFOAM + MAPESIL AC</p> |
|--|---|

APPLICATION STEPS

- 2 MAPEGROUT RANGE**
Level off the substrate with a suitable mortar from the **Mapegrout** range.
- 3 LAMPOSILEX**
Apply the hydraulic binder with manual tools to block infiltrations of water under pressure.
- 4 MAPEPROOF SWELL**
Seal repairs or pipework by applying the cartridge of sealing product with a silicone gun.
- 5 MAPEGROUT RANGE**
Repair the substrate with a suitable mortar from the **Mapegrout** range.
- 6 MAPEBAND TPE + ADESILEX PG4 + QUARTZ 0.5**
Apply the elastic tape along fillets on the epoxy adhesive while still fresh. Apply a second layer of epoxy adhesive and broadcast the surface with **Quartz 0.5**.
- 7 PRIMER 3296**
Apply a coat of primer diluted 1:1 with water over all the horizontal and vertical surfaces with a roller.
- 8 MAPELASTIC FOUNDATION**
Apply two layers of product with a roller to form a total thickness of at least 2 mm.
- 9 ELASTOCOLOR PAINT PLUS**
Apply with a brush, roller or by spray. 2 coats are required to ensure complete, effective coverage.
- 10 KERAFLEX MAXI S1 ZERO**
Apply the adhesive using the double-buttering method with a notched trowel suitable for the type and format of the tiles so that the back of the tiles are sufficiently wetted with adhesive. While installing the tiles use levelling systems from the **MapeLevel** line to maintain the correct width for the grouts and to reduce lippage between adjacent tiles.
- 12 ULTRACOLOR PLUS**
Once the adhesive has set, carefully fill the grouts to their full depth using a rubber trowel without leaving gaps or steps. When the mix starts to lose its plasticity, clean off any excess product with a damp cellulose sponge. They may also be finished off while the product is partially hardened by going over the surface with a damp abrasive pad (such as a Scotch-Brite® pad). Remove any cementitious residues with **UltraCare Keranet**.
- 13 MAPESIL AC**
Seal the perimeter and expansion joints after inserting **Mapefoam** to set the correct depth and then finish off the surface of the sealant with **UltraCare Smooth Silicone**.

PROBLEMS WITH DAMP FROM INFILTRATIONS IN UNDERGROUND ENVIRONMENTS?

COMPLETE SYSTEM FOR WATERPROOFING EXISTING STRUCTURES AND RESTORING UNDERGROUND STRUCTURES WITH DAMP IN COUNTER-PRESSURE WITH AN ANTI-CONDENSATION CYCLE



APPLICATION STEPS

- 1** Thoroughly clean the surface of the masonry by hydro-blasting to remove any crumbling areas or areas at risk of becoming detached.
- MAPEWALL RENDER & STRENGTHEN**
2 Apply a layer of render at least 1 cm. thick with a trowel or rendering machine to level off the surfaces.
- PRIMER 3296**
3 Apply the primer diluted 1:1 with water with a brush, roller or by spray.
- MAPELASTIC FOUNDATION**
4 Apply two layers of product with a roller to form a total thickness of at least 2 mm.
- POROMAP RINZAFFO PLUS**
5 Apply a 0.5 cm thick layer of scratch-coat mortar with a trowel or rendering machine to completely cover the substrate.
- POROMAP DEUMIDIFICANTE**
6 Apply a layer of render at least 1 cm. thick with a trowel or rendering machine.
- POROMAP FINITURA CIVILE**
7 Apply the skimming mortar in layers 2 mm thick with a flat metal trowel.
- SILANCOLOR PRIMER**
8 Apply the product with a brush, roller or by spray to even out the surface and to promote adhesion of the successive coat of paint.
- SILANCOLOR PAINT ZERO**
9 Once the primer is dry apply the paint with a brush, roller or spray. 2 coats are required to ensure complete, effective hiding.

- 1** Masonry
- 2** Render **MAPEWALL RENDER & STRENGTHEN**
- 3** Primer **PRIMER 3296** diluted 1:1 with water
- 4** Waterproofer **MAPELASTIC FOUNDATION**
- 5** Skimming mortar **POROMAP RINZAFFO PLUS**
- 6** Render **POROMAP DEUMIDIFICANTE** (minimum 1 cm)
- 7** Breathable skimming mortar **POROMAP FINITURA CIVILE**
- 8** Siloxane primer **SILANCOLOR PRIMER**
- 9** Siloxane hygienising paint **SILANCOLOR PAINT ZERO**

SYSTEM FOR ELIMINATING AND PROTECTING AGAINST MOULD WITH A BREATHABLE WALL FINISH



APPLICATION STEPS

- 2 SILANCOLOR CLEANER PLUS**
Apply the product with a low-pressure manual sprayer or brush and leave it to react for a few minutes, making sure it penetrates deep down into the substrate. Remove the mould with a stiff brush.
- 3 DURSILITE BASE COAT**
Apply a coat of undercoat in a similar shade to the final finish with a brush, roller or by spray on the clean, dry substrate.
- 4 DURSILITE IGEA**
Apply two coats of finish with a brush, roller or by spray.

- 1** Existing paint with mould
- 2** High penetration, hygienising treatment
SILANCOLOR CLEANER PLUS
- 3** Uniforming coloured undercoat **DURSILITE BASE COAT**
- 4** Mould-resistant breathable water-based paint
DURSILITE IGEA

SYSTEM FOR ELIMINATING AND PROTECTING AGAINST MOULD WITH A WASHABLE WALL FINISH



APPLICATION STEPS

2 SILANCOLOR CLEANER PLUS

Apply the product with a low-pressure manual sprayer or brush and leave it to react for a few minutes, making sure it penetrates deep down into the substrate. Remove the mould with a stiff brush.

3 DURSILITE GYPSOS

Apply one or two coats of finish with a brush, roller or by spray on the clean, dry substrate.

1 Existing paint with mould

2 High penetration hygienising treatment
SILANCOLOR CLEANER PLUS

3 Extra washable, mould-resistant, water-based
paint **DURSILITE GYPSOS**



- 1** Brick masonry
- 2** Render
- 3** Adhesive **MAPETHERM ARI GG**
- 4** Insulating panel **SYNTERIZED EXPANDED POLYSTYRENE - EPS**
- 5** Fastener **MAPETHERM-EJOTHERM SI**
- 6** Skimming mortar **MAPETHERM ARI GG**
- 7** Glass fibre mesh **MAPETHERM NET**
- 8** Acrylic undercoat **QUARZOLITE BASE COAT**
- 9** Acrylic coating **QUARZOLITE TONACHINO PLUS**

APPLICATION STEPS

- 3** **MAPETHERM ARI GG**
Apply an even layer of the adhesive with a notched trowel on the back of the insulating panels. If the substrate is not sufficiently flat, apply the adhesive in beads and spots to cover at least 40% of the bonding surface.
- 4** **EPS - SYNTERIZED EXPANDED POLYSTYRENE**
Position the panels on the substrate in horizontal rows with the joints between the panels staggered at the midpoint of their length.
- 5** **MAPETHERM-EJOTHERM SI**
Insert the fasteners into the set adhesive until they reach the load-bearing portion of the substrate.
- 6** **MAPETHERM ARI GG**
Apply two successive layers of the skimming mortar to form a layer 4-5 mm thick.
- 7** **MAPETHERM NET**
Place the reinforcing mesh on the first layer of skimming mortar while still fresh, overlapping adjacent pieces of mesh by at least 10 cm.
- 8** **QUARZOLITE BASE COAT**
Once the skimming mortar has cured apply a coat of undercoat with a brush, roller or by spray (not airless).
- 9** **QUARZOLITE TONACHINO PLUS**
Apply one or two coats of finish, according to the texture of the surface, with a stainless steel trowel. Finish off the surface with a sponge or plastic float.



- 1** Brick masonry
- 2** Render
- 3** Adhesive **MAPETHERM ARI**
- 4** Insulating panel **EXTRUDED EXPANDED POLYSTYRENE - XPS**
- 5** Fastener **MAPETHERM-EJOTHERM S1**
- 6** Skimming mortar **MAPETHERM ARI**
- 7** Glass fibre mesh **MAPETHERM NET**
- 8** Acrylic undercoat **QUARZOLITE BASE COAT**
- 9** Elastomeric coating **ELASTOCOLOR TONACHINO PLUS**

APPLICATION STEPS

- 3 MAPETHERM ARI**
Apply an even layer of the adhesive with a notched trowel on the back of the insulating panels. If the substrate is not sufficiently flat, apply the adhesive in beads and spots to cover at least 40% of the bonding surface.
- 4 XPS - EXTRUDED EXPANDED POLYSTYRENE**
Position the panels on the substrate in horizontal rows with the joints between the panels staggered at the midpoint of their longest side.
- 5 MAPETHERM-EJOTHERM S1**
Insert the fasteners into the set adhesive until they reach the load-bearing portion of the substrate.
- 6 MAPETHERM ARI**
Apply two successive layers of the skimming mortar to form a layer 4-5 mm thick.
- 7 MAPETHERM NET**
Place the reinforcing mesh on the first layer of skimming mortar while still fresh, overlapping adjacent pieces of mesh by at least 10 cm.
- 8 QUARZOLITE BASE COAT**
Once the skimming mortar has cured apply a coat of undercoat with a brush, roller or by spray (not airless).
- 9 ELASTOCOLOR TONACHINO PLUS**
Apply one or two coats of finish, according to the texture of the surface, with a stainless steel trowel. Finish off the surface with a sponge or plastic float.



- 1 Brick masonry
- 2 Render
- 3 Adhesive **MAPETHERM ARI**
- 4 Insulating panel **RIGID EXPANDED POLYSTYRENE - PIR**
- 5 Fastener **MAPETHERM-EJOTHERM SI**
- 6 Skimming mortar **MAPETHERM ARI**
- 7 Glass fibre mesh **MAPETHERM NET**
- 8 Siloxane coloured undercoat **SILANCOLOR BASE COAT**
- 9 Acrylic siloxane coating **SILANCOLOR AC TONACHINO PLUS**

APPLICATION STEPS

- MAPETHERM ARI**

3 Apply an even layer of the adhesive with a notched trowel on the back of the insulating panels. If the substrate is not sufficiently flat, apply the adhesive in beads and spots to cover at least 40% of the bonding surface.
- PIR - RIGID EXPANDED POLYSTYRENE**

4 Position the panels on the substrate in horizontal rows with the joints between the panels staggered at the midpoint of their longest side.
- MAPETHERM-EJOTHERM SI**

5 Insert the fasteners into the set adhesive until they reach the load-bearing portion of the substrate.
- MAPETHERM ARI**

6 Apply two successive layers of the skimming mortar to form a layer 4-5 mm thick.
- MAPETHERM NET**

7 Place the reinforcing mesh on the first layer of skimming mortar while still fresh, overlapping adjacent pieces of mesh by at least 10 cm.
- SILANCOLOR BASE COAT**

8 Once the skimming mortar has cured apply a coat of undercoat with a brush, roller or by spray (not airless).
- SILANCOLOR AC TONACHINO PLUS**

9 Apply one or two coats of finish, according to the texture of the surface, with a stainless steel trowel. Finish off the surface with a sponge or plastic float.

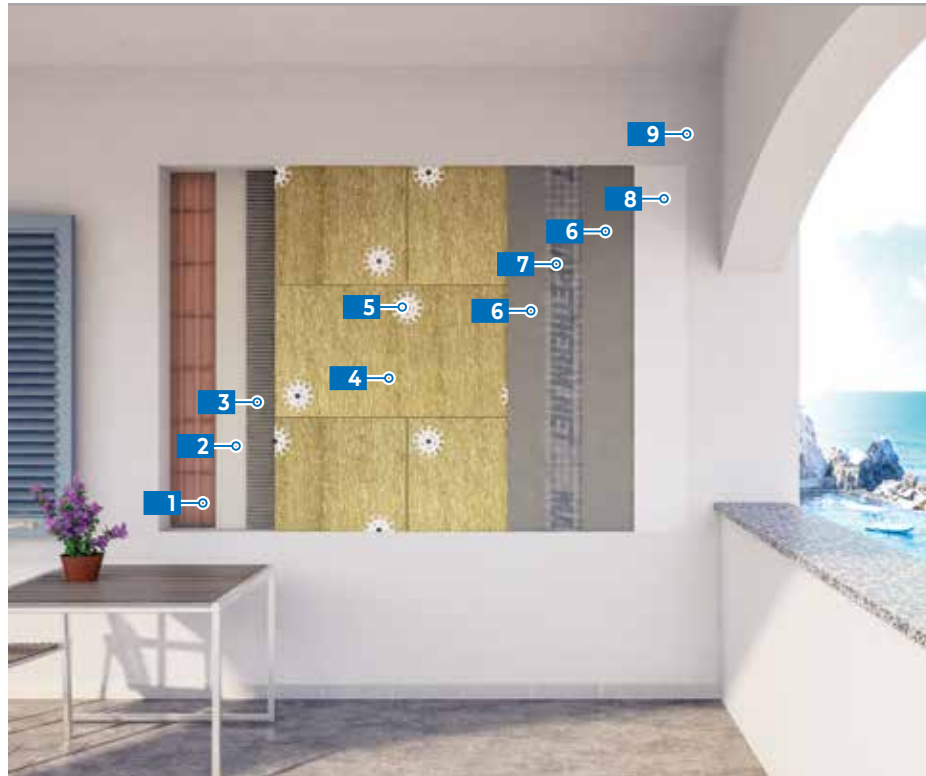

- 1** Brick masonry
- 2** Render
- 3** Adhesive **MAPETHERM ARI GG**
- 4** Insulating panel **MINERAL WOOL**
- 5** Fastener **MAPETHERM-EJOTHERM S1 + MAPETHERM-EJOTHERM SBL 140 PLUS**
- 6** Skimming mortar **MAPETHERM ARI GG**
- 7** Glass fibre mesh **MAPETHERM NET**
- 8** Siloxane undercoat **SILANCOLOR BASE COAT**
- 9** Siloxane coating **SILANCOLOR TONACHINO PLUS**

APPLICATION STEPS

- 3** **MAPETHERM ARI GG**
Apply an even layer of the adhesive with a notched trowel on the back of the insulating panels. If the substrate is not sufficiently flat, apply the adhesive in beads and spots to cover at least 40% of the bonding surface.
- 4** **MINERAL WOOL**
Position the panels on the substrate in horizontal rows with the joints between the panels staggered at the midpoint of their longest side.
- 5** **MAPETHERM-EJOTHERM S1 + MAPETHERM EJOT SBL 140 PLUS**
Insert the fasteners into the set adhesive until they reach the load-bearing portion of the substrate.
- 6** **MAPETHERM ARI GG**
Apply two successive layers of the skimming mortar to form a layer at least 5 mm thick.
- 7** **MAPETHERM NET**
Place the reinforcing mesh on the first layer of skimming mortar while still fresh, overlapping adjacent pieces of mesh by at least 10 cm.
- 8** **SILANCOLOR BASE COAT**
Once the skimming mortar has cured apply a coat of undercoat with a brush, roller or by spray (not airless).
- 9** **SILANCOLOR TONACHINO PLUS**
Apply one or two coats of finish, according to the texture of the surface, with a stainless steel trowel. Finish off the surface with a sponge or plastic float.

MAPETHERM TILE SYSTEM S FOR INSTALLING SMALL-FORMAT CERAMIC TILES ON EXTERNAL THERMAL INSULATION SYSTEMS



- | | |
|--|---|
| <p>1 Render INTOMAP R2 FIBRO</p> <p>2 Adhesive for insulating panels MAPETHERM ARI</p> <p>3 Thermo-insulating panel</p> <p>4 Reinforced skimming mortar (1st coat) MAPETHERM ARI</p> <p>5 Glass fibre mesh MAPETHERM NET</p> <p>6 Fastener + washer MAPETHERM TILE-EJOT SDF-S PLUS Ø 8 UB + MAPETHERM TILE-EJOT SBV-P 8/90 K</p> <p>7 Reinforced skimming mortar (2nd coat) MAPETHERM ARI</p> <p>8 Adhesive for tiles KERAFLEX MAXI S1 ZERO</p> | <p>9 Small-format tile/clinker coating</p> <p>10 Grouts ULTRACOLOR PLUS, MAPEWALL MURATURA FINE</p> <p>11 Sealant elastico MAPEFOAM + MAPESIL LM</p> |
|--|---|

APPLICATION STEPS

- 1 INTOMAP R2 FIBRO**
Level off the perimeter masonry with the rendering mortar so that its flatness and verticality are according to specifications.
- 2 MAPETHERM ARI**
Apply the adhesive using the double-buttering method (an even layer of adhesive on the back of the panels and on the substrate) with a suitable 10-12 mm square-notched trowel.
- 4 MAPETHERM ARI**
Apply two successive layers of the product; the first layer should be 2-2.5 mm thick.
- 5 MAPETHERM NET**
Place the glass fibre reinforcing mesh treated with special alkali-resistant primer on the first layer of skimming mortar while still fresh, overlapping adjacent pieces of mesh by 10 cm.
- 6 MAPETHERM TILE - EJOT SDF-S PLUS Ø 8 UB + MAPETHERM TILE - EJOT SBV-P 8/90 K**
Fasten the panels to the substrate with the fasteners and special washers. Insert the fasteners until the washers are sitting against the mesh.
- 7 MAPETHERM ARI**
Apply the second layer of mortar to form a total thickness of 4-5 mm.
- 8 KERAFLEX MAXI S1 ZERO**
Apply the adhesive with a notched trowel suitable for the type and format of the tiles to ensure the back of the tiles is sufficiently wetted. Use the double-buttering method where specified by UNI 11493-1. While installing the tiles use levelling systems from the **MapeLevel** line to maintain the correct width for the grouts and to reduce lippage between adjacent tiles.
- 10 ULTRACOLOR PLUS / MAPEWALL MURATURA FINE**
Once the adhesive has set, for porcelain or clinker tiles, carefully fill the grouts to their full depth using a rubber trowel without leaving gaps or steps. When the mix starts to lose its plasticity, clean off any excess product with a damp cellulose sponge. They may also be finished off while the product is partially hardened by going over the surface with a damp abrasive pad (such as a Scotch-Brite® pad). Remove any cementitious residues with **UltraCare Keranet**. Use a product such as **MapeWall Muratura Fine** to grout strips of terracotta.
- 11 MAPESIL LM**
Seal the corners, edges and expansion joints after inserting **Mapefoam** to set the correct depth and then finish off the surface of the sealant with **UltraCare Smooth Silicone**.

MAPETHERM TILE SYSTEM XL FOR INSTALLING LARGE-FORMAT CERAMIC TILES ON EXTERNAL THERMAL INSULATION SYSTEMS



APPLICATION STEPS

- 1 INTOMAP R2 FIBRO**
Level off the perimeter masonry with the rendering mortar so that its flatness and verticality are according to specifications.
- 2 MAPETHERM ARI GG**
Apply the adhesive using the double-buttering method (an even layer of adhesive on the back of the panels and on the substrate) with a suitable 10-12 mm square-notched trowel.
- 4 PLANITOP HDM MAXI**
Form a layer of structural render by applying the mortar in two successive layers; the first layer should be 4-5 mm thick.
- 5 MAPEGRID G 120**
Place the alkali-resistant glass fibre reinforcing mesh on the first layer of skimming mortar while still fresh, overlapping adjacent pieces of mesh by at least 5 cm.
- 6 MAPETHERM TILE - EJOT SDF-S PLUS Ø 8 UB + MAPETHERM TILE - EJOT SBV-P 8/90 K**
Fasten the panels to the substrate with the fasteners and special washers.
Insert the fasteners until the washers are sitting against the mesh.
- 7 PLANITOP HDM MAXI**
Apply a second layer of mortar 4-5 mm thick.
- 8 ULTRALITE S2 FLEX**
Apply the adhesive using the double-buttering method (in straight lines parallel to the short side of the tiles). Use a trowel with sloping notches (minimum notch size 10 mm) to spread the adhesive on the substrate and a trowel with 3-4 mm square notches for the adhesive on the back of the tiles. While installing the tiles use levelling systems from the **MapeLevel** line to maintain the correct width for the grouts and to reduce lippage between adjacent tiles.
- 10 ULTRACOLOR PLUS**
Once the adhesive has set, carefully fill the grouts to their full depth using a rubber trowel without leaving gaps or steps. When the mix starts to lose its plasticity, clean off any excess product with a damp cellulose sponge. They may also be finished off while the product is partially hardened by going over the surface with a damp abrasive pad (such as a Scotch-Brite® pad). Remove any cementitious residues with **UltraCare Keranet**.
- 11 MAPESIL LM**
Seal the corners, edges and expansion joints after inserting **Mapefoam** to set the correct depth and then finish off the surface of the sealant with **UltraCare Smooth Silicone**.

- | | |
|--|---|
| <ol style="list-style-type: none"> 1 Render INTOMAP R2 FIBRO 2 Adhesive for insulating panels MAPETHERM ARI GG 3 Thermo-insulating panel 4 Reinforced skimming mortar (1st coat) PLANITOP HDM MAXI 5 Alkali-resistant glass fibre mesh MAPEGRID G 120 6 Fastener + washer MAPETHERM TILE-EJOT SDF-S PLUS Ø 8 UB + MAPETHERM TILE-EJOT SBV-P 8/90 K 7 Structural skimming mortar (2nd coat) PLANITOP HDM MAXI 8 Adhesive for tiles ULTRALITE S2 FLEX | <ol style="list-style-type: none"> 9 Large format tiles 10 Grout ULTRACOLOR PLUS 11 Sealant MAPEFOAM + MAPESIL LM |
|--|---|

MAPETHERM X2 SYSTEM TO DOUBLE EXTERNAL THERMAL INSULATION



APPLICATION STEPS

- 1** **SILANCOLOR CLEANER PLUS**
Apply the product with a low-pressure manual sprayer or brush and leave it to react for a few minutes, making sure it penetrates deep down into the substrate. Remove the mould with a stiff brush.
- 2** **MALECH**
Apply a coat of undercoat with a brush, roller or by spray on the clean, dry substrate.
- 3** **MAPETHERM ARI GG**
Apply an even layer of adhesive on the back of the insulating panels with a notched trowel.
- 4** **RECYCLED EPS - SYNTERIZED EXPANDED POLYSTYRENE**
Position the panels on the substrate in horizontal rows. The panels should be staggered at the midpoint of their longest side and by 25% in height with respect to the layout of the existing insulating panels.
- 5** **MAPETHERM-EJOTHERM S1**
Insert the fasteners into the set adhesive until they reach the load-bearing portion of the substrate.
- 6** **MAPETHERM ARI GG + MAPETHERM NET**
Apply two successive layers of the skimming mortar to form a layer 4-5 mm thick. Place the reinforcing mesh on the first layer of skimming mortar while still fresh, overlapping adjacent pieces of mesh by at least 10 cm.
- 7** **SILANCOLOR BASE COAT PLUS**
Once the skimming mortar has cured apply a coat of undercoat with a brush, roller or by spray (not airless).
- 8** **SILANCOLOR AC TONACHINO PLUS**
Apply one or two coats of finish, according to the texture of the surface, with a stainless steel trowel. Finish off the surface with a sponge or plastic float.
- 9**

- 1** Old damaged thermal insulation
- 2** High-penetration hygienising treatment **SILANCOLOR CLEANER PLUS**
- 3** Acrylic primer **MALECH**
- 4** Adhesive **MAPETHERM ARI GG**
- 5** Insulating panel **SYNTERIZED EXPANDED POLYSTYRENE - RECYCLED EPS**
- 6** Fastener **MAPETHERM-EJOTHERM S1**
- 7** Reinforced skimming mortar **MAPETHERM ARI GG + MAPETHERM NET**
- 8** Siloxane undercoat **SILANCOLOR BASE COAT PLUS**

- 9** Acrylic siloxane coating **SILANCOLOR AC TONACHINO PLUS**

MAPETHERM FLEX RP SYSTEM FOR RESTORING DEGRADED EXTERNAL THERMAL INSULATION



APPLICATION STEPS

- 2 MALECH**
Apply a coat of undercoat with a brush, roller or by spray on the clean, dry substrate.
- 3 MAPETHERM FLEX RP**
Apply a first layer of skimming mortar with a notched trowel.
- 4 MAPETHERM NET**
Place the reinforcing mesh on the first layer of skimming mortar while still fresh, overlapping adjacent pieces of mesh by at least 10 cm.
- 5 MAPETHERM FLEX RP**
Apply a second layer of skimming mortar with a stainless steel trowel to completely embed the mesh.
- 6 ELASTOCOLOR TONACHINO PLUS**
Apply one or two coats of finish, according to the texture of the surface, with a stainless steel trowel. Finish off the surface with a sponge or plastic float.

- 1** Old cracked thermal insulation
- 2** Acrylic primer **MALECH**
- 3** Elastic skimming mortar **MAPETHERM FLEX RP**
- 4** Glass fibre mesh **MAPETHERM NET**
- 5** Elastic skimming mortar **MAPETHERM FLEX RP**
- 6** Elastomeric coating **ELASTOCOLOR TONACHINO PLUS**

INSTALLING CERAMIC TILES AND NATURAL STONE - NOTES

Which adhesive should be used to install ceramic or natural stone tiles varies according to the type and format of the tiles, as specified in UNI 11493-1.

It is recommended to use levelling systems from the **MapeLevel** line for installation.

Upon completion of work, it is recommended to use specific products from the **UltraCare** line for cleaning, maintaining and protecting surfaces.

EVERYTHING'S OK WITH MAPEI

HEAD OFFICE
MAPEI SpA
Via Cafiero, 22
20158 Milan
+39-02-37673.1
mapei@mapei.it
mapei.com

