

# Ultrabond MS Rapid Ultrabond Super Grip

**ASSEMBLY ADHESIVES  
FOR THE BUILDING INDUSTRY**



## HYBRID ASSEMBLY ADHESIVE

# Ultrabond **MS Rapid**

FOR INTERNAL AND  
EXTERNAL USE

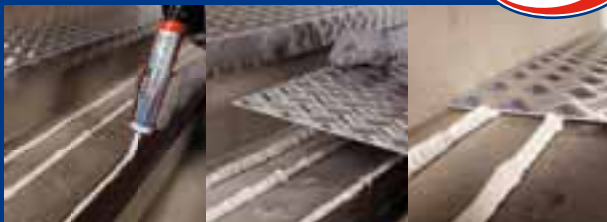

### Uses

Deformable bonds for light and heavy construction components in both absorbent and non-absorbent material  
For the building trade and industry in general

Bonding **Idrostop Soft** water-expanding profiles

Bonding decorative trims and elements such as:

- doorsteps, balcony rails and skirting boards
- insulating panels
- decorative finishes and profiles

### Advantages

Immediate bond, ultra-rapid hardening: no waiting required

High initial suction effect: bonded objects do not slip

Highly strong final bond: secure, safe results

Easy to extrude, no stringing: quick, clean work

Adheres to almost any type\* of building material, including damp materials: multi-purpose

Also bonds non-porous materials (e.g. glass and metal)

For internal and external use: multi-purpose

Paintable

Flexible: compensates for different deformation in different materials

Very low emission level of VOC: environment friendly

*\*for plastics contact Mapei Headquarters*

Application temperature: **+5/+35°C**

In service temperature range: **-40/+90°C**

Adjustment time: **5-6 minutes**

Complete hardening: **24 h**

Initial tensile strength: **25 N**

Shore A hardness: **85**

Colour: **white**

Packaging: **300 ml cartridge**

Storage: **+10/+25°C** in a dry place



# ACRYLIC ASSEMBLY ADHESIVE

## Ultrabond Super Grip

FOR INTERNAL  
USE



### Uses

Deformable bonds for heavy and absorbent construction components

Bonding decorative trims and elements such as:

- polystyrene ceiling roses and profiles
- beading, cable trunking and skirting boards
- insulating panels

### Advantages

High initial suction effect: bonded objects do not slip

Highly strong final bond: secure, safe results

Easy to extrude, no stringing: quick, clean work

Adheres to almost all building materials: multi-purpose

Only one of the two surfaces must be absorbent

Paintable

Flexible: compensates for different deformation in different materials

Very low emission level of VOC: environment friendly



Application temperature: **+10/+35°C**

In service temperature range: **-20/+70°C**

Adjustment time: **10-15 minutes**

Initial tensile strength: **17N**

Complete hardening: **24-48 hours**

Colour: **white**

Packaging: **310 ml cartridge**

Storage: **+10/+25°C** in a dry place

**Ultrabond MS Rapid**



bonding delicate  
surfaces or heavy  
objects

**Ultrabond Super Grip**

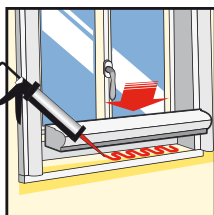

bonding construction  
elements

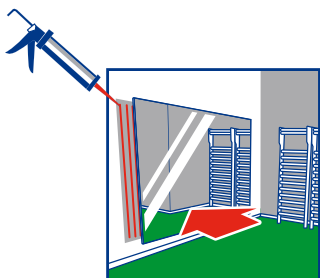

immediate bond,  
suitable for internal  
and external use

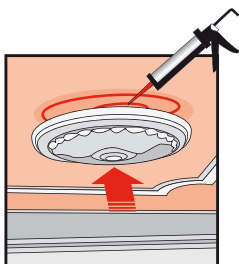

bonding decorative  
elements and profiles

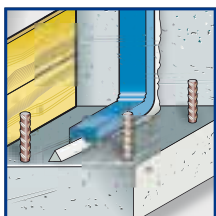

bonding water-  
expanding profile for  
second pours

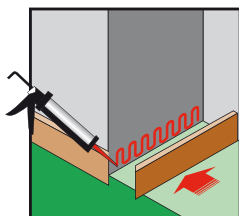

bonding beading and  
skirting boards

## Recommended application procedure

1



### *Substrate preparation*

Clean all traces of loose, crumbly parts from the materials to be bonded. Degrease metal or non-absorbent surfaces with a clean rag dipped in acetone. Finely sand the surface of plastics to make them rougher. In certain cases, it may help to apply primer on the surfaces to be bonded. Contact Mapei Headquarters beforehand for the most appropriate advice.

2



### *Preparation of the product*

Cut the end of the cartridge, screw the extrusion nozzle to the cartridge, trim the nozzle to the diameter required (for **Ultrabond MS Rapid** use the specific pre-cut nozzle) and insert the nozzle in a sealant gun.

3

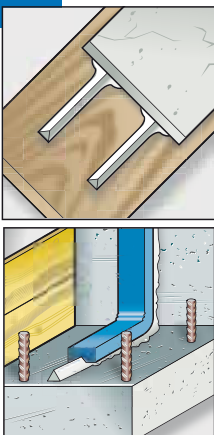

### *Bonding*

Extrude a continuous bead of adhesive onto the substrate, which must be clean and compact. If primer has been applied, it must be dry. For heavy objects, or for bonds over large areas, extrude 2 or more parallel beads 10-15 cm apart. If **Ultrabond MS Rapid** is used, water may be sprayed on the surface to speed up the hardening process. Immediately join the two objects to be bonded and press them together firmly for at least 10 seconds. For heavy objects and surfaces subjected to vibrations when bonding, use temporary clamps and/or supports to hold the objects.

# the complete range of Mapei sealants



C.P. MK 691730 (GB) 1012

## HEADQUARTERS

MAPEI SpA

Via Cafiero, 22 - 20158 Milan

Tel. +39-02-37673.1

Fax +39-02-37673.214

Internet: [www.mapei.com](http://www.mapei.com)

E-mail: [mapei@mapei.it](mailto:mapei@mapei.it)



 **MAPEI**