

# *Plastimul range*

**PRODUCTS FOR WATERPROOFING**



## **Plastimul**

**Bitumen emulsions for  
waterproofing foundations**



# Plastimul range

---



## Description:

The **Plastimul** range offers a complete range of solvent-free bitumen emulsions for waterproofing foundations

## Where to use:

Products from the **Plastimul** range may be applied on foundation walls and on the outer face of horizontal underground structures, on both concrete substrates and on any type of brick or block-built masonry

## Advantages:

- Wide range: products with base performance characteristics and performance characteristics in compliance with the most severe standards
- One and two-component products with various yields, drying times and set-to-rain times to meet all design and site requirements
- May be applied by trowel or by spray
- Suitable for application on brick/block masonry without render
- Products with CE marking, in compliance with Euronorm EN 15814 (“Polymer modified bituminous thick coatings for waterproofing”)



## Plastimul range:



**Plastimul:** One-component bitumen waterproofing emulsion for general purpose



**Plastimul 1K Super Plus:** One-component, high flexibility bitumen waterproofing emulsion containing polystyrene spheres and rubber granules. Low shrinkage, quick-drying and high-yield



**Plastimul 2K Plus:** Two-component, quick-drying, low-shrinkage bitumen emulsion containing cellulose fibres



**Plastimul 2K Super:** Two-component, high-flexibility bitumen waterproofing emulsion containing polystyrene spheres. Low shrinkage and high yield



**Plastimul 2K Reactive:** Two-component, high elasticity bitumen emulsion for immediate waterproofing, to be applied by airless spray



**Plastimul C:** Concentrated emulsion for treating substrates before applying waterproofing products from the **Plastimul** range

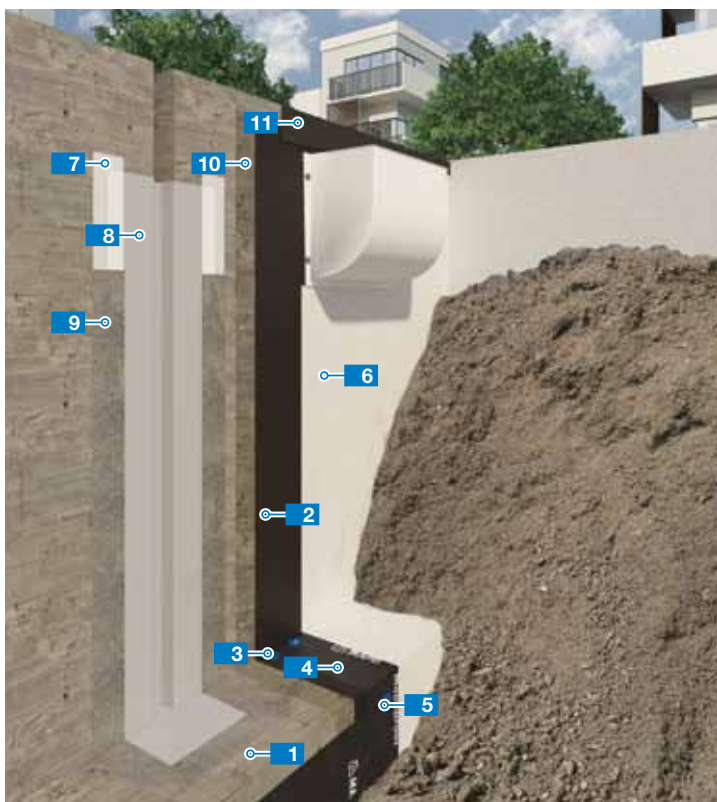

- 1** Substrate  
Concrete
- 2** Bituminous waterproofing emulsion from the **Plastimul** range
- 3** Bentonite paste  
**Mapeproof Mastic**
- 4** Bentonite sheet  
**Mapeproof**
- 5** Washer  
**Mapeproof CD**
- 6** Non-woven fabric combined to HDPE  
**Polyfond Kit Drain** produced by Polyglass
- 7** Epoxy adhesive  
**Adesilex PG4**
- 8** TPE tape  
**Mapeband TPE**
- 9** Epoxy adhesive  
**Adesilex PG4** broadcast with **Quartz 0.5**
- 10** Primer  
**Plastimul C**
- 11** Pre-cast self-adhesive bitumen polymer membrane  
**Adesoguard** produced by Polyglass

## EN 15814 Norm

There are numerous requirements in this standard, below is a quick comparison between the various **Plastimul** products based on four requirements in particular:

		Plastimul	Plastimul 1K Super Plus	Plastimul 2K Plus	Plastimul 2K Super	Plastimul 2K Reactive
Impermeability to water in pressure on a 1 mm open crack	<p><b>Class W1:</b>  <math>\geq 24</math> h at <math>0.0075 \text{ N/mm}^2</math>,                      dry thickness without reinforcement <math>\geq 3</math> mm</p> <p><b>Class W2A:</b>  <math>\geq 72</math> h at <math>0.075 \text{ N/mm}^2</math>,                      dry thickness with reinforcement <math>\geq 4</math> mm</p> <p><b>Class W2B:</b>  <math>\geq 72</math> h at <math>0.075 \text{ N/mm}^2</math>,                      dry thickness without reinforcement <math>\geq 4</math> mm</p>	W1	W2A	W2A	W2A	W2B
Static crack-bridging at $+4^\circ\text{C}$	<p><b>Class CB0:</b>                      no requirement</p> <p><b>Class CB1:</b>                      no damage to cracks <math>\geq 1</math> mm                      with dry thickness <math>\geq 3</math> mm</p> <p><b>Class CB2:</b>                      no damage to cracks <math>\geq 2</math> mm                      with dry thickness <math>\geq 3</math> mm</p>	CB1	CB2	CB2	CB2	CB2
Compressive strength	<p><b>Class C0:</b>                      no requirement</p> <p><b>Class C1:</b>  <math>0.06 \text{ MN/m}^2</math>,                      with dry thickness <math>\geq 3</math> mm</p> <p><b>Class C2A:</b>  <math>0.30 \text{ MN/m}^2</math>,                      with dry thickness with reinforcement <math>\geq 4</math> mm</p> <p><b>Class C2B:</b>  <math>0.30 \text{ MN/m}^2</math>,                      with dry thickness without reinforcement <math>\geq 4</math> mm</p>	C1	C2A	C2A	C2A	C2B
Resistance to rain	<p><b>Class R0:</b>                      no requirement</p> <p><b>Class R1:</b>  <math>\leq 24</math> h with wet thickness  <math>\geq 3</math> mm</p> <p><b>Class R2:</b>  <math>\leq 8</math> h with wet thickness  <math>\geq 3</math> mm</p> <p><b>Class R3:</b>  <math>\leq 4</math> h with wet thickness  <math>\geq 3</math> mm</p>	R2	R3	R3	R2	R3



● **Technical documentation**

From the technical area menu you can view the technical documentation divided per product lines and type of document.

**HEADQUARTERS**  
**MAPEI SpA**  
Via Cafiero, 22 - 20158 Milan  
Tel. +39-02-37673.1  
Fax +39-02-37673.214  
Internet: [www.mapei.com](http://www.mapei.com)  
E-mail: [mapei@mapei.it](mailto:mapei@mapei.it)



/mapeispa