

# Mapeplan<sup>®</sup> T B

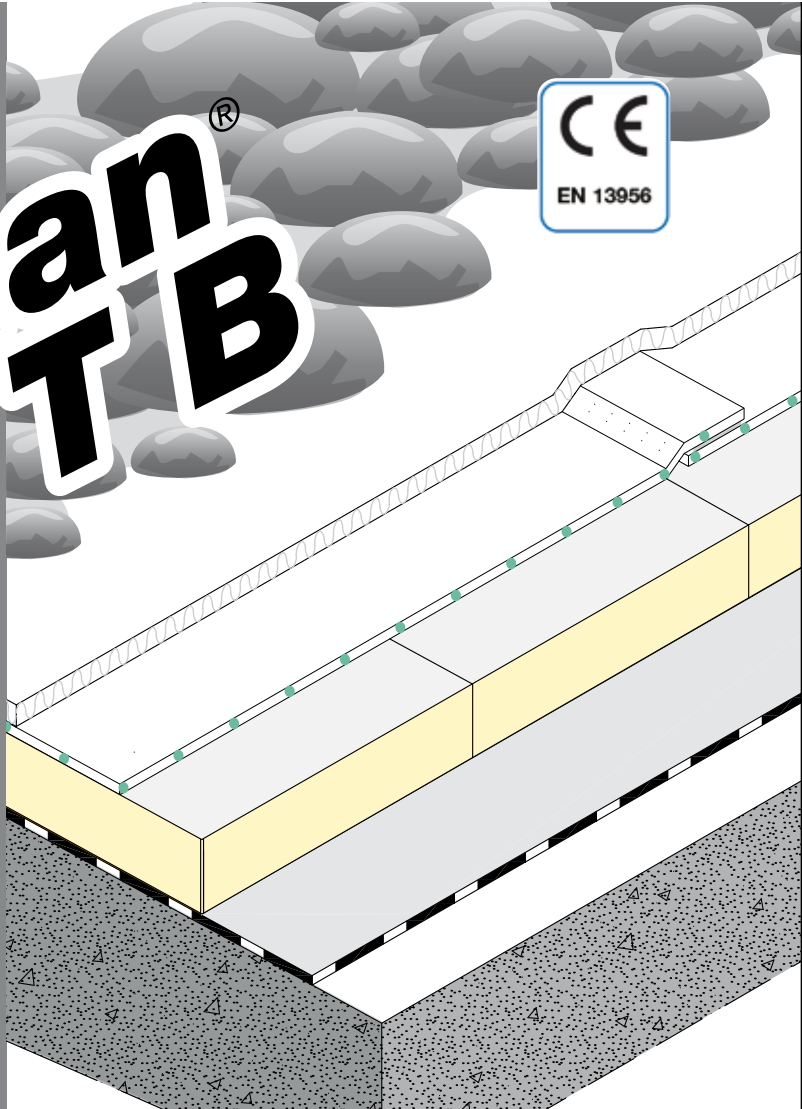

## Roofing and waterproofing synthetic membrane



### DESCRIPTION

Mapeplan<sup>®</sup> T B is a synthetic roofing waterproofing membrane in flexible polyolefin TPO/FPO produced in one **multi-extrusion coating process**, with high quality raw materials, reinforced with glass mat. Mapeplan<sup>®</sup> T B is conform to EN 13956 standard.

### APPLICATION FIELDS

Mapeplan<sup>®</sup> T B is suitable for loose laid ballasted and roof garden systems. It is resistant to ultraviolet rays.

### NORMS AND CERTIFICATIONS

CE conformity marking according to EN 13956 standard  
ISO 9001 quality system certification  
ISO 14001 environmental system certification  
Leed Certification (Leadership in Energy and Environmental Design)



### TECHNICAL CHARACTERISTICS

Mapeplan<sup>®</sup> T B is a high standard quality product; it performs very good mechanical properties, best workability as well as excellent welding characteristics.

### - High solar reflectance

- High workability and weldability
- Resistant to microbiological attacks and root-resistant,
- High mechanical resistance
- Excellent flexibility at low temperatures
- Excellent resistance to ageing
- Excellent resistance to UV rays and to weathering
- Vapour permeability
- Formulation without plasticizers

### PACKAGING

PALLET	14 rolls per pallet
LENGTH OF ROLLS	25 m 20 m 15 m (according to the thickness)
WIDTH OF ROLLS	2,10 m

### STORAGE

Store horizontally, shelter from sun and bad weather in a dry place.

### SAFETY INSTRUCTIONS

Mapeplan<sup>®</sup> T B is not considered dangerous according to the current safety regulation for the classification of goods and substances. The safety datasheet is therefore not compulsory for the purchase, transport and application. Precaution during use: ensure a proper change of air if the application is made in closed working environments.

## TECHNICAL DATA

### PRODUCT PROPERTIES

Product	Waterproofing membrane in TPO/FPO (flexible polyolefin), reinforced with glass mat				
Colour	Top layer: high reflectance Smart White Bottom layer: black				
European standard	EN 13956				
CHARACTERISTICS STANDARDS - M.U.	Mapeplan T B 12	Mapeplan T B 15	Mapeplan T B 18	Mapeplan T B 20	
Visible defects	EN 1850-2	None	None	None	None
Length (m)	EN 1848-2	25 (-0/+5%)	20 (-0/+5%)	15 (-0/+5%)	15 (-0/+5%)
Width (m)	EN 1848-2	2,10 (-0,5/+1%)	2,10 (-0,5/+1%)	2,10 (-0,5/+1%)	2,10 (-0,5/+1%)
Straightness (mm)	EN 1848-2	≤ 30	≤ 30	≤ 30	≤ 30
Flatness (mm)	EN 1848-2	≤ 10	≤ 10	≤ 10	≤ 10
Mass per unit area (kg/m²)	EN 1849-2	1,2 (-5/+10%)	1,5 (-5/+10%)	1,8 (-5/+10%)	2,0 (-5/+10%)
Effective thickness (mm)	EN 1849-2	1,2 (-5/+10%)	1,5 (-5/+10%)	1,8 (-5/+10%)	2,0 (-5/+10%)
TECHNICAL CHARACTERISTICS	Mapeplan T B 12	Mapeplan T B 15	Mapeplan T B 18	Mapeplan T B 20	
Water tightness (kPa/72h) EN 1928	≥ 400	≥ 400	≥ 400	≥ 400	
Reaction to fire EN 11925-2 EN 13501-1	Class E	Class E	Class E	Classe E	
Joint peel resistance EN 12316-2 (N/50mm)	≥ 300	≥ 300	≥ 300	≥ 300	
Joint shear resistance EN 12317-2 (N/50mm)	≥ 500	≥ 500	≥ 500	≥ 500	
Vapour diffusion resistance (μ) EN 1931	150.000	150.000	150.000	150.000	
Tensile strength (N/mm²) EN 12311-2	≥ 9	≥ 9	≥ 9	≥ 9	
Elongation EN 12311-2 (%)	≥ 550	≥ 550	≥ 550	≥ 550	
Resistance to impact - rigid support - flexible support EN 12691 (mm)	≥ 400 ≥ 700	≥ 600 ≥ 900	≥ 800 ≥ 1000	≥ 900 ≥ 1100	
Resistance to static load EN 12730-B (kg)	≥ 20	≥ 20	≥ 20	≥ 20	
Tear resistance EN 12310-2 (N)	≥ 150	≥ 150	≥ 150	≥ 150	
Dimensional stability EN 1107-2 (%)	≤ 0,2	≤ 0,2	≤ 0,2	≤ 0,2	
Foldability at low temperatures EN 495-5 (°C)	≤ -35	≤ -35	≤ -35	≤ -35	
UV exposure EN 1297	grade 0 - passes	grade 0 - passes	grade 0 - passes	grade 0 - passes	
Exposure/compatibility to aged bitumen (possible colour variations)	compatible	compatible	compatible	compatible	
Resistance to root penetration EN 13948	conform	conform	conform	conform	
SRI (Solar Reflectance Index) ASTM E1980	102	102	102	102	

### MAPEPLAN® T ACCESSORIES

- Mapeplan® T D, membrane for details and particulars
- Mapeplan® T, metal sheets coupled to Mapeplan® T membrane
- Mapeplan® T, internal and external prefabricated corners
- Mapeplan® ADS 300, contact adhesives
- Mapeplan® T Cleaner, cleaning liquid
- Mapeplan® T, outlets and special prefabricated pieces

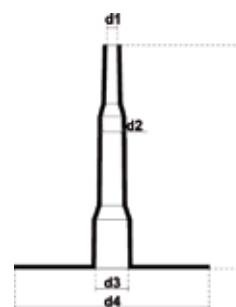

CONNECTOR

## MAPEPLAN® T B LAYERING

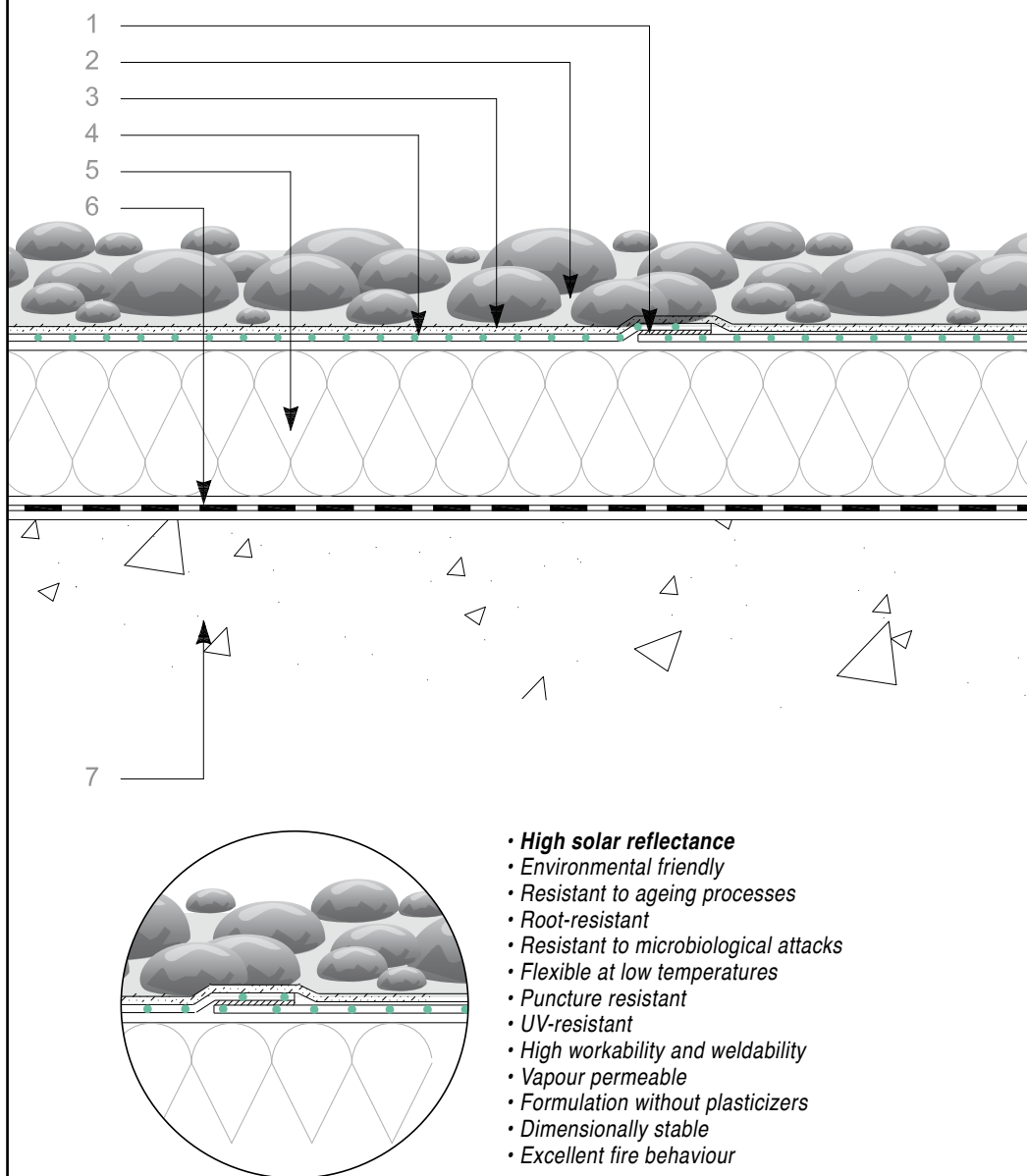

Technical specifications of product are available on the technical books.  
References for this product are available on request and on Mapei and polyglass web sites at the following addresses [www.mapei.it](http://www.mapei.it), [www.mapei.com](http://www.mapei.com) and [www.polyglass.com](http://www.polyglass.com)

### LEGEND

1. *Overlap/Hot air welding*
2. *Ballast*
3. *Protection layer*
4. *Mapeplan® T B, roofing membrane*
5. *Thermal insulation*
6. *Vapour control layer*  
(for example Mapeplan® VB PE)
7. *Substrate*



[www.mapei.com](http://www.mapei.com)

---

**MAPEPLAN range is produced by:**



**Registered Office - Viale Jenner, 4 - 20159 MILANO**

**Head Office - Via dell'Artigianato, 34 - 31047 Ponte di Piave (TV) - Italia**  
**Tel. +39 04227547 - Fax +39 0422854118 - [www.polyglass.com](http://www.polyglass.com) - [info@polyglass.it](mailto:info@polyglass.it)**