

AREAS OF APPLICATION

+ Swimming pools and other types of pools with water

SYSTEM DESCRIPTION

The system consists of products who give a pore free and durable surface which is well suited for treatment of concrete structures that is in contact with water.

The system is normally applied in a thickness of approx. 0.5 - 2 mm creating a surface which protects the concrete against decay. The system is delivered in a variety of colors from Mapei's color chart. On request RAL- and NCS- colors may be delivered. NB: The product will get a shade of yellow color if exposed to direct sunlight. Creamy white and other bright colors are not recommended used outdoors

The product does not contain organic solvents and is practically odour free during application. The system ensures quick installation and use, and the final product poses no health or environmental hazard to the user.

PROPERTIES

The system is well suited for substrates with exacting requirements for flooring with:

- + Waterproof, pore free and seamless surfaces
- + Durable
- + Durable against wear from cleaning
- + Good resistance against alkalis, oil and grease.

SYSTEM STRUCTURE

Substrate / Pre-treatment

The substrate should be pre-treated by sanding, grinding or blast cleaning and should be dry, clean and free of dust, oil, grease etc.

The system is well suited for use on concrete and other cement based substrates.

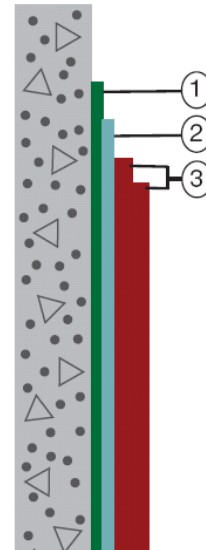

1 Porefilling

Mapepoxy Cem S – cementitious/epoxy-based pore filler. Three-component pore filler which is applied with a trowel/tray and smooth to remove minor imperfections.

2 Priming

Mapeprimer M – standard epoxy primer. Broadcast with dry sand if the time between coats is more than 24 hours (depends conditions of use).

3 Epoxy-thin coating

Mapewall I – colored Two-component thixotropic epoxy paint which is applied with brush, roller or sprayer in a minimum of two layers.

Other connected products

Fiberglass MA 119 – Powder bound (CSM) glass fibre mesh 150 g/m²

Mapepoxy BI – Force transferring injection in cracks.

Resfoam 1KM – Polyurethane injection for waterproofing

Purgel - Polyurethane injection for waterproofing in contact with drinking water.

OTHER USEFUL INFORMATION

+ The Technical Data Sheet (TDS) and Safety Data Sheet (SDS) can be found at www.mapei.no

+ Working descriptions